

HSS-E



High Performance Cutting Tools



STRAIGHT FLUTE MACHINE TAPS

STRAIGHT FLUTE TAPS - SC SERIES



Straight flute taps dimensionally same as hand taps & with a lead chamfer of 1.1/2 threads. The flute & rake angle are designed as per application. These Taps are recommended for tapping on grey cast iron, S G iron & steel. The chips produced are short or powder type with the help of special design provided in the tap

Advantages :

- Thread Chamfer is 1.5 thread & threading can be done upto bottom
- Chips are broken into short / powder chips

SELECTION GUIDE



STRAIGHT FLUTE TAPS

| SERIES | | THREAD FORM | BLANK STANDARD | APPLICATION | CHAMFER | COATING | PAGE |
|--------|---|-----------------|----------------|-------------|----------|---------|------|
| SC3 |  | M | DIN371/DIN376 | Cast Iron | E/1.5-2P | TiN | 76 |
| SC4 |  | M | DIN371/DIN376 | Cast Iron | E/1.5-2P | TiAIN | 77 |
| SC3 |  | MF | DIN374 | Cast Iron | E/1.5-2P | TiN | 78 |
| SC4 |  | MF | DIN374 | Cast Iron | E/1.5-2P | TiAIN | 79 |
| SC3 |  | UNC | DIN371/DIN376 | Cast Iron | E/1.5-2P | TiN | 80 |
| SC4 |  | UNC | DIN371/DIN376 | Cast Iron | E/1.5-2P | TiAIN | 81 |
| SC3 |  | UNF | DIN374 | Cast Iron | E/1.5-2P | TiN | 82 |
| SC4 |  | UNF | DIN374 | Cast Iron | E/1.5-2P | TiAIN | 83 |
| SC3 |  | M | ISO | Cast Iron | E/1.5-2P | TiN | 84 |
| SC4 |  | M | ISO | Cast Iron | E/1.5-2P | TiAIN | 85 |
| SC3 |  | MF | ISO | Cast Iron | E/1.5-2P | TiN | 86 |
| SC4 |  | MF | ISO | Cast Iron | E/1.5-2P | TiAIN | 87 |
| SC3L |  | M/MF Long Shank | ISO | Cast Iron | E/1.5-2P | TiN | 88 |
| SC4L |  | M/MF Long Shank | ISO | Cast Iron | E/1.5-2P | TiAIN | 89 |
| SC3 |  | UNC | ISO | Cast Iron | E/1.5-2P | TiN | 90 |
| SC4 |  | UNC | ISO | Cast Iron | E/1.5-2P | TiAIN | 91 |
| SC3 |  | UNF | ISO | Cast Iron | E/1.5-2P | TiN | 92 |
| SC4 |  | UNF | ISO | Cast Iron | E/1.5-2P | TiAIN | 93 |



M

Metric coarse threads

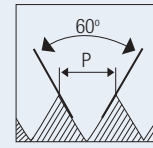

HOLE TYPE



HSS-E

DIN
371/376

6HX

E/1.5-2P

TiN

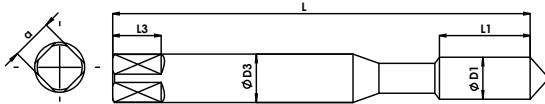

Reinforced Shank DIN371 (M3 - M10)

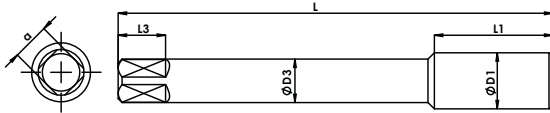

Reduced Shank DIN376 (M12 - M20)

K1-K2

N1-N3

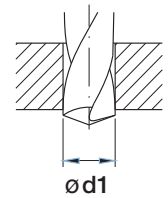

Unit : mm

| Nominal Diameter | Pitch | EDP No. | Overall Length | Thread Length | Shank Diameter | Square Size | Square Length | Tapping Drill Diameter |
|------------------|-------|------------|----------------|---------------|----------------|-------------|---------------|------------------------|
| ØD1 | TPI | | L | L1 | ØD3 | a | L3 | Ød1 |
| M 3 | 0.5 | FAB0204433 | 56 | 11 | 3.5 | 2.7 | 6 | 2.5 |
| M 4 | 0.7 | FAB0204434 | 63 | 13 | 4.5 | 3.4 | 6 | 3.3 |
| M 5 | 0.8 | FAB0203676 | 70 | 16 | 6 | 4.9 | 8 | 4.2 |
| M 6 | 1 | FAB0203677 | 80 | 19 | 6 | 4.9 | 8 | 5 |
| M 8 | 1.25 | FAB0203678 | 90 | 22 | 8 | 6.2 | 9 | 6.8 |
| M 9 | 1.25 | FAB0204435 | 90 | 22 | 9 | 7 | 10 | 7.8 |
| M 10 | 1.5 | FAB0200969 | 100 | 24 | 10 | 8 | 11 | 8.5 |
| M 11 | 1.5 | FAB0204436 | 100 | 24 | 8 | 6.2 | 9 | 9.5 |
| M 12 | 1.75 | FAB0200975 | 110 | 28 | 9 | 7 | 10 | 10.2 |
| M 14 | 2 | FAB0204437 | 110 | 30 | 11 | 9 | 12 | 12 |
| M 16 | 2 | FAB0204438 | 110 | 32 | 12 | 9 | 12 | 14 |
| M 18 | 2.5 | FAB0204439 | 125 | 34 | 14 | 11 | 14 | 15.5 |
| M 20 | 2.5 | FAB0204440 | 140 | 34 | 16 | 12 | 15 | 17.5 |



Straight Flute Machine Tap

SC4 Series



Metric coarse threads

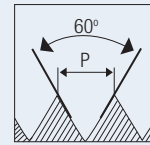

HOLE TYPE

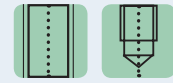

HSS-E

DIN 371/376

6HX

E/1.5-2P

TiAIN

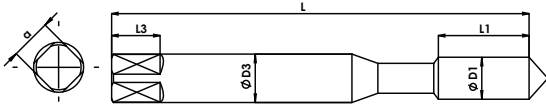

Reinforced Shank DIN371 (M3 - M10)



K1-K3

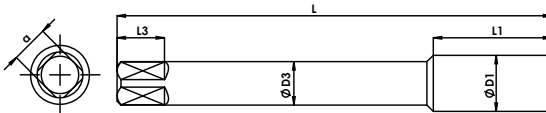

Reduced Shank DIN376 (M12 - M20)

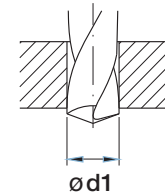

Unit : mm

| Nominal Diameter | Pitch | EDP No. | Overall Length | Thread Length | Shank Diameter | Square Size | Square Length | Tapping Drill Diameter |
|------------------|-------|------------|----------------|---------------|----------------|-------------|---------------|------------------------|
| ØD1 | TPI | | L | L1 | ØD3 | a | L3 | Ød1 |
| M3 | 0.5 | FAB0204441 | 56 | 11 | 3.5 | 2.7 | 6 | 2.5 |
| M 4 | 0.7 | FAB0204442 | 63 | 13 | 4.5 | 3.4 | 6 | 3.3 |
| M 5 | 0.8 | FAB0204443 | 70 | 16 | 6 | 4.9 | 8 | 4.2 |
| M 6 | 1 | FAB0203679 | 80 | 19 | 6 | 4.9 | 8 | 5 |
| M 8 | 1.25 | FAB0203680 | 90 | 22 | 8 | 6.2 | 9 | 6.8 |
| M 9 | 1.25 | FAB0204444 | 90 | 22 | 9 | 7 | 10 | 7.8 |
| M 10 | 1.5 | FAB0203682 | 100 | 24 | 10 | 8 | 11 | 8.5 |
| M 11 | 1.5 | FAB0204445 | 100 | 24 | 8 | 6.2 | 9 | 9.5 |
| M 12 | 1.75 | FAB0203683 | 110 | 28 | 9 | 7 | 10 | 10.2 |
| M 14 | 2 | FAB0204446 | 110 | 30 | 11 | 9 | 12 | 12 |
| M 16 | 2 | FAB0204447 | 110 | 32 | 12 | 9 | 12 | 14 |
| M 18 | 2.5 | FAB0204448 | 125 | 34 | 14 | 11 | 14 | 15.5 |
| M 20 | 2.5 | FAB0204449 | 140 | 34 | 16 | 12 | 15 | 17.5 |

HSS TAPS

DIES

END MILLS

DRILLS

CARBIDE BURRS

CS TAPS



Straight Flute Machine Tap

SC3 Series

MF

Metric fine threads

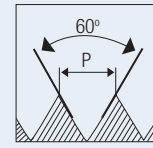

HOLE TYPE



HSS-E

DIN
374

6HX

E/1.5-2P

TiN

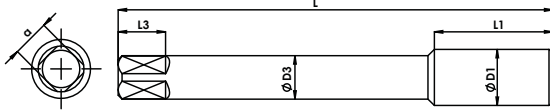

Male centre (M6 - M10)
Female centre (M12 - M20)

K1-K2

N1-N3

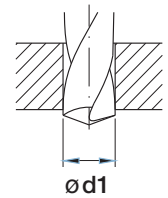

Unit : mm

| Nominal Diameter | Pitch | EDP No. | Overall Length | Thread Length | Shank Diameter | Square Size | Square Length | Tapping Drill Diameter |
|------------------|-------|------------|----------------|---------------|----------------|-------------|---------------|------------------------|
| ØD1 | TPI | | L | L1 | ØD3 | a | L3 | Ød1 |
| M 6 | 0.75 | FAB0204450 | 80 | 19 | 4.5 | 3.4 | 6 | 5.2 |
| M 8 | 1 | FAB0204451 | 90 | 22 | 6 | 4.9 | 8 | 7 |
| M 10 | 1.25 | FAB0203681 | 100 | 24 | 7 | 5.5 | 8 | 8.8 |
| M 10 | 1 | FAB0204452 | 90 | 20 | 7 | 5.5 | 8 | 9 |
| M 12 | 1.5 | FAB0204453 | 100 | 22 | 9 | 7 | 10 | 10.5 |
| M 12 | 1.25 | FAB0204454 | 100 | 22 | 9 | 7 | 10 | 10.8 |
| M 14 | 1.5 | FAB0204455 | 100 | 22 | 11 | 9 | 12 | 12.5 |
| M 16 | 1.5 | FAB0204456 | 100 | 22 | 12 | 9 | 12 | 14.5 |
| M 18 | 1.5 | FAB0204457 | 110 | 25 | 14 | 11 | 14 | 16.5 |
| M 20 | 1.5 | FAB0204458 | 125 | 25 | 16 | 12 | 15 | 18.5 |



Straight Flute Machine Tap

SC4 Series

MF

Metric fine threads

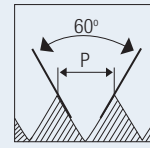

HOLE TYPE

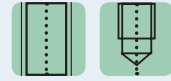

HSS-E

DIN 374

6HX

E/1.5-2P

TiAlN

K1-K3

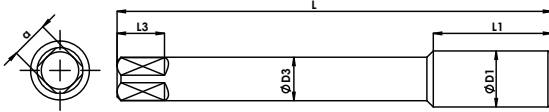

Male centre (M6 - M10)
Female centre (M12 - M20)

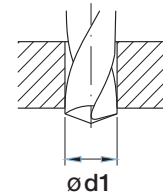

Unit : mm

| Nominal Diameter | Pitch | EDP No. | Overall Length | Thread Length | Shank Diameter | Square Size | Square Length | Tapping Drill Diameter |
|------------------|-------|------------|----------------|---------------|----------------|-------------|---------------|------------------------|
| ØD1 | TPI | | L | L1 | ØD3 | a | L3 | Ød1 |
| M 6 | 0.75 | FAB0204459 | 80 | 19 | 4.5 | 3.4 | 6 | 5.2 |
| M 8 | 1 | FAB0204460 | 90 | 22 | 6 | 4.9 | 8 | 7 |
| M 10 | 1.25 | FAB0204461 | 100 | 24 | 7 | 5.5 | 8 | 8.8 |
| M 10 | 1 | FAB0204462 | 90 | 20 | 7 | 5.5 | 8 | 9 |
| M 12 | 1.5 | FAB0204463 | 100 | 22 | 9 | 7 | 10 | 10.5 |
| M 12 | 1.25 | FAB0204464 | 100 | 22 | 9 | 7 | 10 | 10.8 |
| M 14 | 1.5 | FAB0204465 | 100 | 22 | 11 | 9 | 12 | 12.5 |
| M 16 | 1.5 | FAB0204466 | 100 | 22 | 12 | 9 | 12 | 14.5 |
| M 18 | 1.5 | FAB0204467 | 110 | 25 | 14 | 11 | 14 | 16.5 |
| M 20 | 1.5 | FAB0204468 | 125 | 25 | 16 | 12 | 15 | 18.5 |

HSS TAPS

DIES

END MILLS

DRILLS

CARBIDE BURRS

CS TAPS



Straight Flute Machine Tap

SC3 Series

UNC

Unified coarse threads

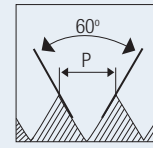

HOLE TYPE



HSS-E

DIN
371/376

2B

E/1.5-2P

TiN

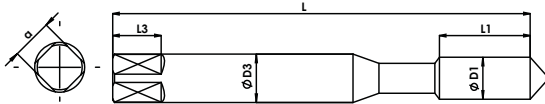

Reinforced Shank DIN371 (1/4" - 3/8")

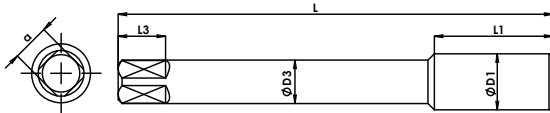

Reduced Shank DIN376 (7/16" - 1")

K1-K2

N2-N3

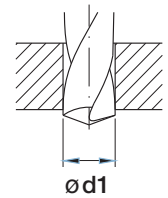

Unit : mm

| Nominal Diameter | TPI | EDP No. | Overall Length | Thread Length | Shank Diameter | Square Size | Square Length | Tapping Drill Diameter |
|------------------|-----|------------|----------------|---------------|----------------|-------------|---------------|------------------------|
| ØD1 | | | L | L1 | ØD3 | a | L3 | Ød1 |
| 1/4" | 20 | FAB0204469 | 80 | 19 | 7 | 5.5 | 8 | 5.2 |
| 5/16" | 18 | FAB0204470 | 90 | 22 | 8 | 6.2 | 9 | 6.6 |
| 3/8" | 16 | FAB0204471 | 100 | 24 | 10 | 8 | 11 | 8 |
| 7/16" | 14 | FAB0204472 | 110 | 24 | 8 | 6.2 | 9 | 9.4 |
| 1/2" | 13 | FAB0204473 | 110 | 28 | 9 | 7 | 10 | 10.8 |
| 5/8" | 11 | FAB0204474 | 110 | 32 | 12 | 9 | 12 | 13.5 |
| 3/4" | 10 | FAB0204475 | 125 | 34 | 14 | 11 | 14 | 16.5 |
| 7/8" | 9 | FAB0204476 | 140 | 34 | 18 | 14.5 | 17 | 19.5 |
| 1" | 8 | FAB0204477 | 160 | 38 | 18 | 14.5 | 17 | 22.25 |



Straight Flute Machine Tap

SC4 Series

UNC

Unified coarse threads

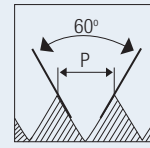

HOLE TYPE

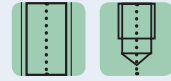

HSS-E

DIN
371/376

2B

E/1.5-2P

TiAlN

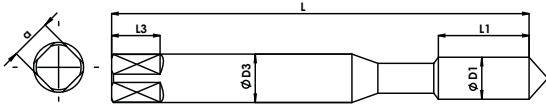

Reinforced Shank DIN371 (1/4" - 3/8")



K1-K3

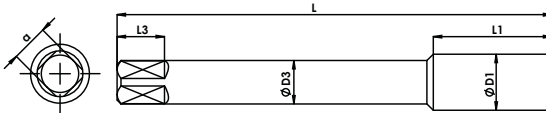

Reduced Shank DIN376 (7/16" - 1")

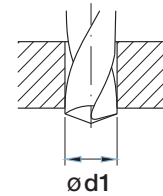

Unit : mm

| Nominal Diameter | TPI | EDP No. | Overall Length | Thread Length | Shank Diameter | Square Size | Square Length | Tapping Drill Diameter |
|------------------|-----|------------|----------------|---------------|----------------|-------------|---------------|------------------------|
| | | | L | L1 | ØD3 | a | L3 | Ød1 |
| 1/4" | 20 | FAB0204478 | 80 | 19 | 7 | 5.5 | 8 | 5.2 |
| 5/16" | 18 | FAB0204479 | 90 | 22 | 8 | 6.2 | 9 | 6.6 |
| 3/8" | 16 | FAB0204480 | 100 | 24 | 10 | 8 | 11 | 8 |
| 7/16" | 14 | FAB0204481 | 110 | 24 | 8 | 6.2 | 9 | 9.4 |
| 1/2" | 13 | FAB0204482 | 110 | 28 | 9 | 7 | 10 | 10.8 |
| 5/8" | 11 | FAB0204483 | 110 | 32 | 12 | 9 | 12 | 13.5 |
| 3/4" | 10 | FAB0204484 | 125 | 34 | 14 | 11 | 14 | 16.5 |
| 7/8" | 9 | FAB0204485 | 140 | 34 | 18 | 14.5 | 17 | 19.5 |
| 1" | 8 | FAB0204486 | 160 | 38 | 18 | 14.5 | 17.5 | 22.25 |

HSS TAPS

DIES

END MILLS

DRILLS

CARBIDE BURRS

CS TAPS



Straight Flute Machine Tap

SC3 Series

UNF

Unified fine threads

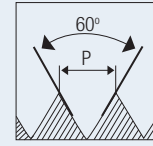

HOLE TYPE



HSS-E

DIN
374

2B

E/1.5-2P

TiN

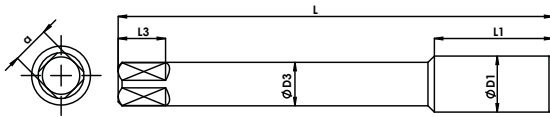

Male centre (1/4" - 3/8")
Female centre (7/16" - 1")

K1-K2

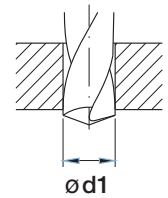

Unit : mm

| Nominal Diameter | TPI | EDP No. | Overall Length | Thread Length | Shank Diameter | Square Size | Square Length | Tapping Drill Diameter |
|------------------|-----|------------|----------------|---------------|----------------|-------------|---------------|------------------------|
| ØD1 | | | L | L1 | ØD3 | a | L3 | Ød1 |
| 1/4" | 28 | FAB0204487 | 80 | 19 | 5.5 | 4.3 | 7 | 5.5 |
| 5/16" | 24 | FAB0204488 | 90 | 22 | 6 | 4.9 | 8 | 6.9 |
| 3/8" | 24 | FAB0204489 | 100 | 20 | 7 | 5.5 | 8 | 8.5 |
| 7/16" | 20 | FAB0204490 | 100 | 22 | 8 | 6 | 9 | 9.9 |
| 1/2" | 20 | FAB0204491 | 100 | 22 | 9 | 7 | 10 | 11.5 |
| 5/8" | 18 | FAB0204492 | 100 | 22 | 12 | 9 | 12 | 14.5 |
| 3/4" | 16 | FAB0204493 | 110 | 25 | 14 | 11 | 14 | 17.5 |
| 7/8" | 14 | FAB0204494 | 125 | 25 | 18 | 14.5 | 17 | 20.5 |
| 1" | 12 | FAB0204495 | 140 | 28 | 18 | 14.5 | 17 | 23.25 |



Straight Flute Machine Tap

SC4 Series

UNF

Unified fine threads

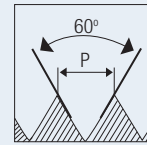

HOLE TYPE

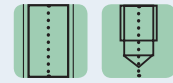

HSS-E

DIN 374

2B

E/1.5-2P

TiAIN

K1-K3

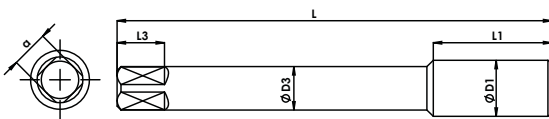

Male centre (1/4" - 3/8")
Female centre (7/16" - 1")

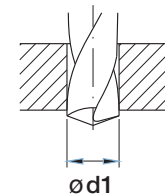

Unit : mm

| Nominal Diameter | TPI | EDP No. | Overall Length | Thread Length | Shank Diameter | Square Size | Square Length | Tapping Drill Diameter |
|------------------|-----|------------|----------------|---------------|----------------|-------------|---------------|------------------------|
| ØD1 | | | L | L1 | ØD3 | a | L3 | Ød1 |
| 1/4" | 28 | FAB0204496 | 80 | 19 | 5.5 | 4.3 | 7 | 5.5 |
| 5/16" | 24 | FAB0204497 | 90 | 22 | 6 | 4.9 | 8 | 6.9 |
| 3/8" | 24 | FAB0204498 | 100 | 20 | 7 | 5.5 | 8 | 8.5 |
| 7/16" | 20 | FAB0204499 | 100 | 22 | 8 | 6 | 9 | 9.9 |
| 1/2" | 20 | FAB0204500 | 100 | 22 | 9 | 7 | 10 | 11.5 |
| 5/8" | 18 | FAB0204501 | 100 | 22 | 12 | 9 | 12 | 14.5 |
| 3/4" | 16 | FAB0204502 | 110 | 25 | 14 | 11 | 14 | 17.5 |
| 7/8" | 14 | FAB0204503 | 125 | 25 | 18 | 14.5 | 17 | 20.5 |
| 1" | 12 | FAB0204504 | 140 | 28 | 18 | 14.5 | 17 | 23.25 |

HSS TAPS

DIES

END MILLS

DRILLS

CARBIDE BURRS

CS TAPS



M

Metric coarse threads

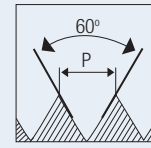

HOLE TYPE



HSS-E

ISO
529

6HX

E/1.5-2P

TiN

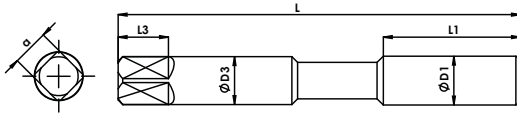
Reinforced Shank (M3 - M10)
Male centre upto M5

K1-K2

N2-N3

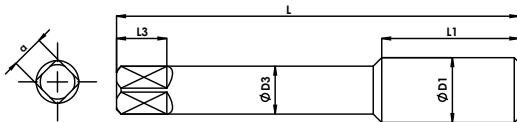

Reduced Shank (M12 - M20)

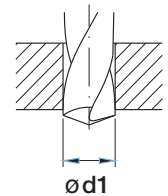

Unit : mm

| Nominal Diameter | Pitch | EDP No. | Overall Length | Thread Length | Shank Diameter | Square Size | Square Length | Tapping Drill Diameter |
|------------------|-------|------------|----------------|---------------|----------------|-------------|---------------|------------------------|
| ØD1 | p | | L | L1 | ØD3 | a | L3 | Ød1 |
| M 3 | 0.5 | FAB0200645 | 48 | 11 | 3.15 | 2.5 | 5 | 2.5 |
| M 3.5 | 0.6 | FAB0200652 | 50 | 13 | 3.55 | 2.8 | 5 | 2.9 |
| M 4 | 0.7 | FAB0200657 | 53 | 13 | 4 | 3.15 | 6 | 3.3 |
| M 5 | 0.8 | FAB0200669 | 58 | 16 | 5 | 4 | 7 | 4.2 |
| M 6 | 1 | FAB0200680 | 66 | 19 | 6.3 | 5 | 8 | 5 |
| M 8 | 1.25 | FAB0200692 | 72 | 22 | 8 | 6.3 | 9 | 6.8 |
| M 10 | 1.5 | FAB0200716 | 80 | 24 | 10 | 8 | 11 | 8.5 |
| M 12 | 1.75 | FAB0200747 | 89 | 29 | 9 | 7.1 | 10 | 10.2 |
| M 14 | 2 | FAB0200776 | 95 | 30 | 11.2 | 9 | 12 | 12 |
| M 16 | 2 | FAB0200797 | 102 | 32 | 12.5 | 10 | 13 | 14 |
| M 20 | 2.5 | FAB0203219 | 112 | 37 | 14 | 11.2 | 14 | 17.5 |



Straight Flute Machine Tap

SC4 Series



Metric coarse threads

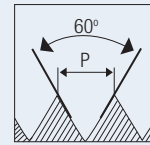

HOLE TYPE

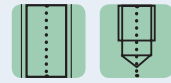

HSS-E

ISO 529

6HX

E/1.5-2P

TiAlN

K1-K3

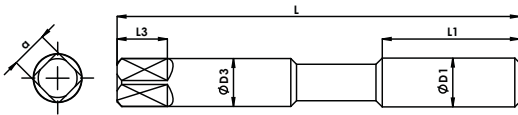

Reinforced Shank (M3 - M10)
Male centre upto M5

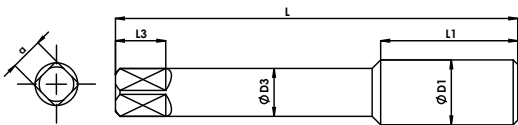

Reduced Shank (M12 - M20)

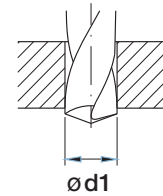

Unit : mm

| Nominal Diameter | Pitch | EDP No. | Overall Length | Thread Length | Shank Diameter | Square Size | Square Length | Tapping Drill Diameter |
|------------------|-------|------------|----------------|---------------|----------------|-------------|---------------|------------------------|
| ØD1 | p | | L | L1 | ØD3 | a | L3 | Ød1 |
| M 3 | 0.5 | FAB0200646 | 48 | 11 | 3.15 | 2.5 | 5 | 2.5 |
| M 3.5 | 0.6 | FAB0203220 | 50 | 13 | 3.55 | 2.8 | 5 | 2.9 |
| M 4 | 0.7 | FAB0200658 | 53 | 13 | 4 | 3.15 | 6 | 3.3 |
| M 5 | 0.8 | FAB0200670 | 58 | 16 | 5 | 4 | 7 | 4.2 |
| M 6 | 1 | FAB0200681 | 66 | 19 | 6.3 | 5 | 8 | 5 |
| M 8 | 1.25 | FAB0200693 | 72 | 22 | 8 | 6.3 | 9 | 6.8 |
| M 10 | 1.5 | FAB0200717 | 80 | 24 | 10 | 8 | 11 | 8.5 |
| M 12 | 1.75 | FAB0200871 | 89 | 29 | 9 | 7.1 | 10 | 10.2 |
| M 14 | 2 | FAB0200777 | 95 | 30 | 11.2 | 9 | 12 | 12 |
| M 16 | 2 | FAB0200798 | 102 | 32 | 12.5 | 10 | 13 | 14 |
| M 20 | 2.5 | FAB0200809 | 112 | 37 | 14 | 11.2 | 14 | 17.5 |

HSS TAPS

DIES

END MILLS

DRILLS

CARBIDE BURRS

CS TAPS



MF

Metric fine threads

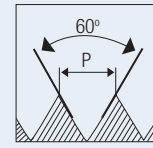

HOLE TYPE



HSS-E

ISO
529

6HX

E/1.5-2P

TiN

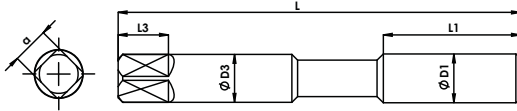

Reinforced Shank (M10)

K1-K2

N2-N3

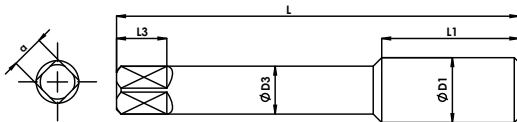

Reduced Shank (M12 - M20)

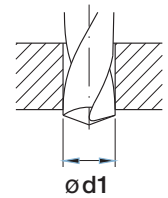

Ød1

Unit : mm

| Nominal Diameter | Pitch | EDP No. | Overall Length | Thread Length | Shank Diameter | Square Size | Square Length | Tapping Drill Diameter |
|------------------|-------|------------|----------------|---------------|----------------|-------------|---------------|------------------------|
| ØD1 | TPI | | L | L1 | ØD3 | a | L3 | Ød1 |
| M 10 | 1.25 | FAB0200706 | 76 | 20 | 10 | 8 | 11 | 8.8 |
| M 12 | 1.25 | FAB0200727 | 84 | 24 | 9 | 7.1 | 10 | 10.8 |
| M12 | 1.5 | FAB0200736 | 89 | 29 | 9 | 7.1 | 10 | 10.5 |
| M 14 | 1.5 | FAB0200767 | 95 | 30 | 11.2 | 9 | 12 | 12.5 |
| M 16 | 1.5 | FAB0200785 | 102 | 32 | 12.5 | 10 | 13 | 14.5 |
| M 18 | 1.5 | FAB0203217 | 104 | 29 | 14 | 11.2 | 14 | 16.5 |
| M 20 | 1.5 | FAB0203218 | 104 | 29 | 14 | 11.2 | 14 | 18.5 |



Straight Flute Machine Tap

SC4 Series



Metric fine threads

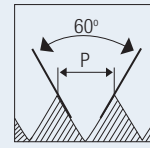

HOLE TYPE

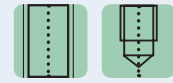

HSS-E

ISO 529

6HX



TiAIN

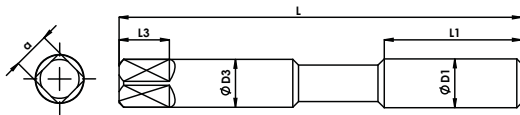

Reinforced Shank (M10)



K1-K3

N2-N3

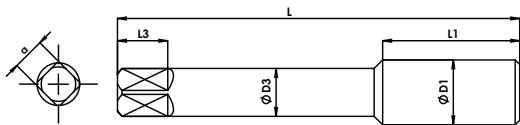

Reduced Shank (M12 - M20)

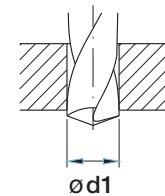

Unit : mm

| Nominal Diameter | Pitch | EDP No. | Overall Length | Thread Length | Shank Diameter | Square Size | Square Length | Tapping Drill Diameter |
|------------------|-------|------------|----------------|---------------|----------------|-------------|---------------|------------------------|
| | | | L | L1 | ØD3 | a | L3 | Ød1 |
| M 10 | 1.25 | FAB0200707 | 76 | 20 | 10 | 8 | 11 | 8.8 |
| M 12 | 1.25 | FAB0200728 | 84 | 20 | 10 | 8 | 11 | 10.8 |
| M 12 | 1.5 | FAB0200737 | 89 | 29 | 9 | 7.1 | 10 | 10.5 |
| M 14 | 1.5 | FAB0200768 | 95 | 30 | 11.2 | 9 | 12 | 12.5 |
| M 16 | 1.5 | FAB0200786 | 102 | 32 | 12.5 | 10 | 13 | 14.5 |
| M 18 | 1.5 | FAB0200805 | 104 | 29 | 14 | 11.2 | 14 | 16.5 |
| M 20 | 1.5 | FAB0200806 | 104 | 29 | 14 | 11.2 | 14 | 18.5 |

HSS TAPS

DIES

END MILLS

DRILLS

CARBIDE BURRS

CS TAPS



Straight Flute Machine Tap

SC3L Series

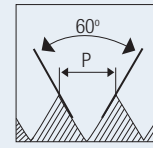
M/MF**Metric coarse & fine threads -
long shank**

HOLE TYPE



HSS-E

ISO
529

6HX

E/1.5-2P

TiN

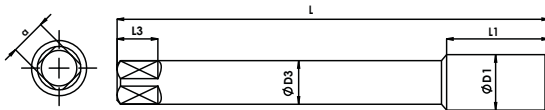
Male centre (M4 - M5)
Female centre (M6 - M16)

K1-K2

N2-N3

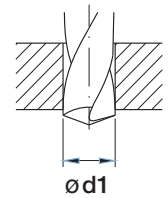

Unit : mm

| Nominal Diameter | Pitch | EDP No. | Overall Length | Thread Length | Shank Diameter | Square Size | Square Length | Tapping Drill Diameter |
|------------------|-------|------------|----------------|---------------|----------------|-------------|---------------|------------------------|
| ØD1 | TPI | | L | L1 | ØD3 | a | L3 | Ø d1 |
| M 4 | 0.7 | FAB0200817 | 73 | 13 | 3.15 | 2.50 | 5 | 3.3 |
| M 5 | 0.8 | FAB0200821 | 79 | 16 | 4.00 | 3.15 | 6 | 4.2 |
| M 6 | 1 | FAB0200830 | 89 | 19 | 4.50 | 3.55 | 6 | 5 |
| M 8 | 1.25 | FAB0200841 | 97 | 22 | 6.30 | 5.00 | 8 | 6.8 |
| M 10 | 1.5 | FAB0200852 | 108 | 24 | 8.00 | 6.30 | 9 | 8.5 |
| M 12 | 1.5 | FAB0200863 | 119 | 29 | 9.00 | 7.10 | 10 | 10.5 |
| M 12 | 1.75 | FAB0200874 | 119 | 29 | 9.00 | 7.10 | 10 | 10.3 |
| M 14 | 1.5 | FAB0200884 | 127 | 30 | 11.20 | 9.00 | 12 | 12.5 |
| M 14 | 2 | FAB0203278 | 127 | 30 | 11.20 | 9.00 | 12 | 12 |
| M 16 | 1.5 | FAB0203279 | 137 | 32 | 12.50 | 10.00 | 13 | 14.5 |
| M 16 | 2 | FAB0200892 | 137 | 32 | 12.50 | 10.00 | 13 | 14 |



Straight Flute Machine Tap

SC4L Series

M/MF

Metric coarse & fine threads - long shank

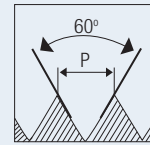

HOLE TYPE

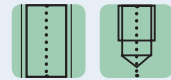

HSS-E

ISO 529

6HX



TiAIN

K1-K3

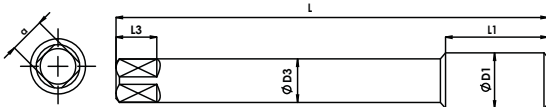

Male centre (M4 - M5)
Female centre (M6 - M16)

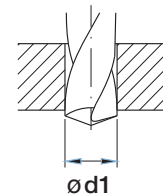

Unit : mm

| Nominal Diameter | Pitch | EDP No. | Overall Length | Thread Length | Shank Diameter | Square Size | Square Length | Tapping Drill Diameter |
|------------------|-------|------------|----------------|---------------|----------------|-------------|---------------|------------------------|
| ØD1 | TPI | | L | L1 | ØD3 | a | L3 | Ød1 |
| M 4 | 0.7 | FAB0203280 | 73 | 13 | 3.15 | 2.50 | 5 | 3.3 |
| M 5 | 0.8 | FAB0203281 | 79 | 16 | 4.00 | 3.15 | 6 | 4.2 |
| M 6 | 1 | FAB0200831 | 89 | 19 | 4.50 | 3.55 | 6 | 5 |
| M 8 | 1.25 | FAB0200842 | 97 | 22 | 6.30 | 5.00 | 8 | 6.8 |
| M 10 | 1.5 | FAB0200853 | 108 | 24 | 8.00 | 6.30 | 9 | 8.5 |
| M 12 | 1.5 | FAB0200864 | 119 | 29 | 9.00 | 7.10 | 10 | 10.5 |
| M 12 | 1.75 | FAB0200875 | 119 | 29 | 9.00 | 7.10 | 10 | 10.3 |
| M 14 | 1.5 | FAB0200885 | 127 | 30 | 11.20 | 9.00 | 12 | 12.5 |
| M 14 | 2 | FAB0203282 | 127 | 30 | 11.20 | 9.00 | 12 | 12 |
| M 16 | 1.5 | FAB0203283 | 137 | 32 | 12.50 | 10.00 | 13 | 14.5 |
| M 16 | 2 | FAB0203284 | 137 | 32 | 12.50 | 10.00 | 13 | 14 |

HSS TAPS

DIES

END MILLS

DRILLS

CARBIDE BURRS

CS TAPS



Straight Flute Machine Tap

SC3 Series

UNC

Unified coarse threads

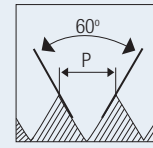

HOLE TYPE



HSS-E

ISO
529

2B

E/1.5-2P

TiN

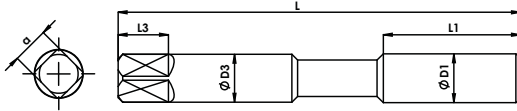

Reinforced Shank (1/4" - 3/8")

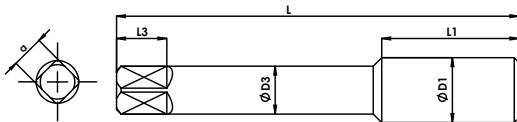

Reduced Shank (7/16" - 3/4")

K1-K2

N2-N3

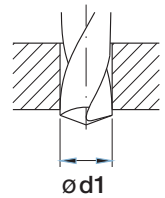

Ød1

Unit : mm

| Nominal Diameter | TPI | EDP No. | Overall Length | Thread Length | Shank Diameter | Square Size | Square Length | Tapping Drill Diameter |
|------------------|-----|------------|----------------|---------------|----------------|-------------|---------------|------------------------|
| ØD1 | | | L | L1 | ØD3 | a | L3 | Ød1 |
| 1/4" | 20 | FAB0200571 | 66 | 19 | 6.3 | 5 | 8 | 5.2 |
| 5/16" | 18 | FAB0200581 | 72 | 22 | 8 | 6.3 | 9 | 6.6 |
| 3/8" | 16 | FAB0200591 | 80 | 24 | 10 | 8 | 11 | 8 |
| 7/16" | 14 | FAB0200601 | 85 | 25 | 8 | 6.3 | 9 | 9.4 |
| 1/2" | 13 | FAB0200612 | 89 | 29 | 9 | 7.1 | 10 | 10.8 |
| 5/8" | 11 | FAB0200625 | 102 | 32 | 12.5 | 10 | 13 | 13.5 |
| 3/4" | 10 | FAB0200636 | 112 | 37 | 14 | 11.2 | 14 | 16.5 |



Straight Flute Machine Tap

SC4 Series

UNC

Unified coarse threads

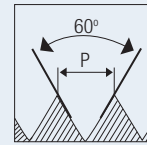

HOLE TYPE

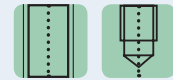

HSS-E

ISO 529

2B

E/1.5-2P

TiAIN

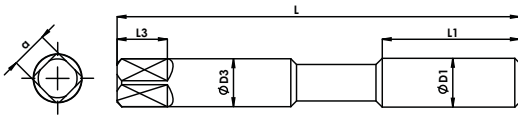

Reinforced Shank (1/4" - 3/8")



K1-K3

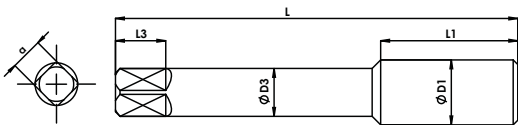

Reduced Shank (7/16" - 3/4")

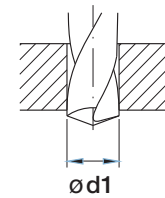

Unit : mm

| Nominal Diameter | TPI | EDP No. | Overall Length | Thread Length | Shank Diameter | Square Size | Square Length | Tapping Drill Diameter |
|------------------|-----|------------|----------------|---------------|----------------|-------------|---------------|------------------------|
| ØD1 | | | L | L1 | ØD3 | a | L3 | Ød1 |
| 1/4" | 20 | FAB0200572 | 66 | 19 | 6.3 | 5 | 8 | 5.2 |
| 5/16" | 18 | FAB0203289 | 72 | 22 | 8 | 6.3 | 9 | 6.6 |
| 3/8" | 16 | FAB0200592 | 80 | 24 | 10 | 8 | 11 | 8 |
| 7/16" | 14 | FAB0200602 | 85 | 25 | 8 | 6.3 | 9 | 9.4 |
| 1/2" | 13 | FAB0200613 | 89 | 29 | 9 | 7.1 | 10 | 10.8 |
| 5/8" | 11 | FAB0200626 | 102 | 32 | 12.5 | 10 | 13 | 13.5 |
| 3/4" | 10 | FAB0200637 | 112 | 37 | 14 | 11.2 | 14 | 16.5 |

HSS TAPS

DIES

END MILLS

DRILLS

CARBIDE BURRS

CS TAPS



Straight Flute Machine Tap

SC3 Series

UNF

Unified fine threads

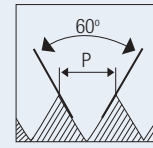

HOLE TYPE



HSS-E

ISO
529

2B

E/1.5-2P

TiN

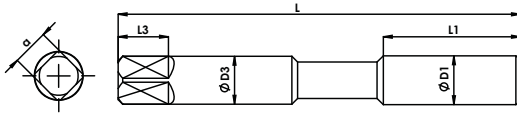

Reinforced Shank (1/4" - 3/8")

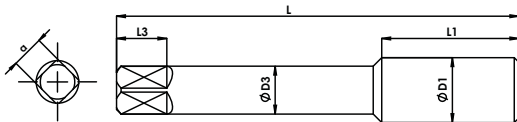

Reduced Shank (7/16" - 3/4")

K1-K2

N2-N3

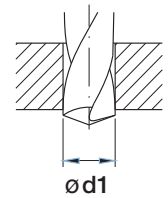

Unit : mm

| Nominal Diameter | TPI | EDP No. | Overall Length | Thread Length | Shank Diameter | Square Size | Square Length | Tapping Drill Diameter |
|------------------|-----|------------|----------------|---------------|----------------|-------------|---------------|------------------------|
| ØD1 | | | L | L1 | ØD3 | a | L3 | Ød1 |
| 1/4" | 28 | FAB0200495 | 66 | 19 | 6.3 | 5 | 8 | 5.5 |
| 5/16" | 24 | FAB0200504 | 69 | 19 | 8 | 6.3 | 9 | 6.9 |
| 3/8" | 24 | FAB0200515 | 76 | 20 | 10 | 8 | 11 | 8.5 |
| 7/16" | 20 | FAB0200526 | 82 | 22 | 8 | 6.3 | 9 | 9.9 |
| 1/2" | 20 | FAB0200537 | 84 | 24 | 9 | 7.1 | 10 | 11.5 |
| 5/8" | 18 | FAB0200550 | 95 | 25 | 12.5 | 10 | 13 | 14.5 |
| 3/4" | 16 | FAB0200561 | 104 | 29 | 14 | 11.2 | 14 | 17.5 |



Straight Flute Machine Tap

SC4 Series

UNF

Unified fine threads

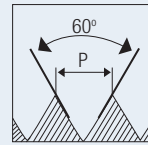

HOLE TYPE



HSS-E

ISO 529

2B

E/1.5-2P

TiAIN

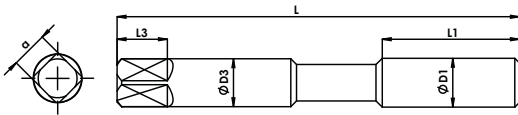

Reinforced Shank (1/4" - 3/8")



K1-K3

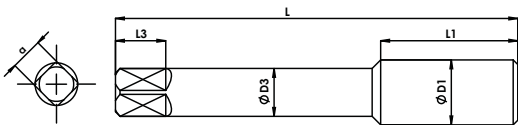

Reduced Shank (7/16" - 3/4")

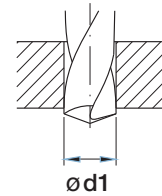

Unit : mm

| Nominal Diameter | TPI | EDP No. | Overall Length | Thread Length | Shank Diameter | Square Size | Square Length | Tapping Drill Diameter |
|------------------|-----|------------|----------------|---------------|----------------|-------------|---------------|------------------------|
| | | | L | L1 | ØD3 | a | L3 | Ød1 |
| 1/4" | 28 | FAB0200496 | 66 | 19 | 6.3 | 5 | 8 | 5.5 |
| 5/16" | 24 | FAB0200505 | 69 | 19 | 8 | 6.3 | 9 | 6.9 |
| 3/8" | 24 | FAB0200516 | 76 | 20 | 10 | 8 | 11 | 8.5 |
| 7/16" | 20 | FAB0200527 | 82 | 22 | 8 | 6.3 | 9 | 9.9 |
| 1/2" | 20 | FAB0200538 | 84 | 24 | 9 | 7.1 | 10 | 11.5 |
| 5/8" | 18 | FAB0200551 | 95 | 25 | 12.5 | 10 | 13 | 14.5 |
| 3/4" | 16 | FAB0200562 | 104 | 29 | 14 | 11.2 | 14 | 17.5 |

HSS TAPS

DIES

END MILLS

DRILLS

CARBIDE BURRS

CS TAPS