

ROUGHNESS TESTER

DATA
OUTPUT



ISR-S300
(probe can't be changed)



ISR-S400
(probe can be changed)

- Automatic probe leveling
- Language: English, French, German, Italian, Spanish, Portuguese
- 12 roughness parameters
- Can set tolerance
- Measuring range up to 400µm, can measure grit and shot blasting
- Traverse length up to 16mm
- The probe can be set at 90° or 270°, for transverse measurement
- Memory of maximum 100 results



transverse measurement



adjustable stand (included)



test stand (optional)



measuring software (optional), can control the roughness tester, display roughness values, profile and curve, data statistics



probe cover (included), can put the small workpieces directly on the probe for measurement



printer (optional), print measuring results and roughness graphic

To be continued

SPECIFICATION

Code	ISR-S300 (probe can't be changed)	ISR-S400 (probe can be changed)
Parameters	Ra, Rq, Rt, Rz, Rc, Rmax, Rsm, Rpc, Rmr, R, AR, Rx	
Range	Ra: 0~100 μ m, Rt: 0.05~400 μ m	
Accuracy	\pm 3%	
Resolution (Ra)	0.001 μ m	
Probe	type	inductive
	stylus radius/angle	5 μ m/90°
	stylus material	diamond
Measuring force	0.75mN	
Measuring unit	μ m/ μ in	
Cut off	0.25/0.8/2.5mm	
Number of cut-offs	1 to 5	
Traverse speed	1mm/s	
Memory	100 measurement results	
Output	USB	
Power	built-in rechargeable battery	
Dimension(L×W×H)	122×52×68mm	
Weight	650g	

STANDARD DELIVERY

Main unit	1pc
Standard probe	1pc
Calibration block	1pc
Adjustable stand	1pc
AC/DC adapter	1pc
Probe cover	1pc

OPTIONAL ACCESSORY

Extension rod (only for ISR-S400)	ISR-S400-ER100
Probe (only for ISR-S400)	see below and next page
Printer	ISR-S400-PRINTER
USB cable and software	ISR-S-SOFTWARE
Test stand	ISR-S400-DK

SPECIFICATION

Unit: mm

<p>standard probe (included)</p> <p>measure plane surfaces, holes and cylinders with diameter > Ø10mm</p>	<p>small roughness probe (for ISR-S400, optional) code ISR-S400-SB10R2</p> <p>measure surfaces with small roughness</p>
<p>extension rod (for ISR-S400, optional) code ISR-S400-ER100</p> <p>for long hole</p>	

To be continued

SPECIFICATION

Unit: mm

**groove probe (for ISR-S400, optional)
code ISR-S400-SB20**

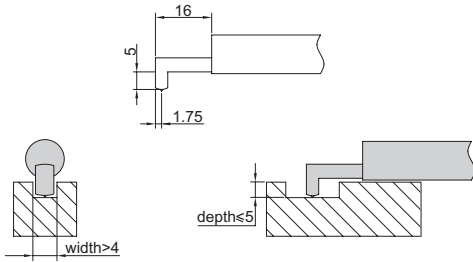

measure plane surfaces and grooves

**deep groove probe (for ISR-S400, optional)
code ISR-S400-SB120**

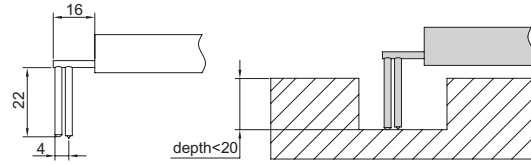

measure grooves with depth < 20 mm

**small hole probe (for ISR-S400, optional)
code ISR-S400-SB30**

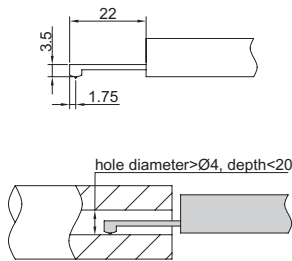

measure plane surfaces and holes with diameter > 4 mm and depth < 20 mm

**deep hole probe (for ISR-S400, optional)
code ISR-S400-SB80**

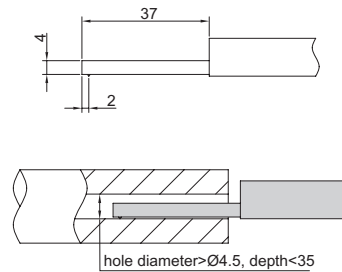

measure holes with diameter > 4.5 mm and depth < 35 mm

**small rod probe (for ISR-S400, optional)
code ISR-S400-SB40**

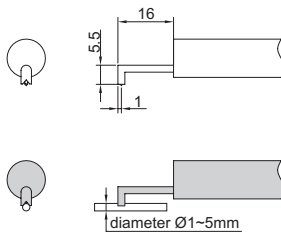

measure small rods with diameter 1~5 mm

**cylinder/hole probe (for ISR-S400, optional)
code ISR-S400-SB110**

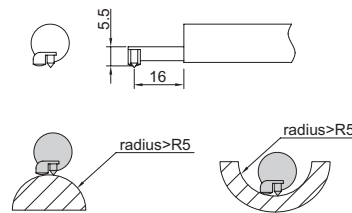

measure cylinders and holes with radius > R5 mm

**transverse probe (for ISR-S400, optional)
code ISR-S400-SB50**

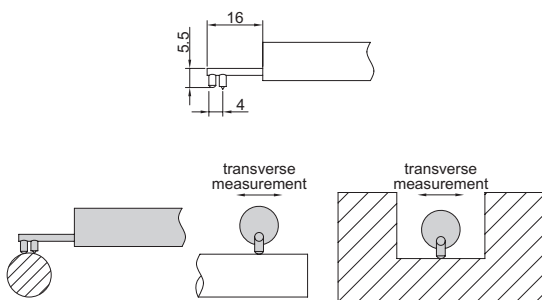

transverse measurement for plane surfaces, cylinders and grooves

**internal angle probe (for ISR-S400, optional)
code ISR-S400-SB140**

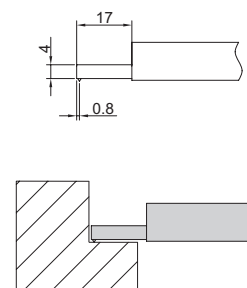

measure internal angles