

# CARBON STEEL















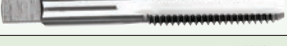



High Performance Cutting Tools



# CARBON STEEL HAND TAPS



## CARBON STEEL HAND TAPS

	THREAD FORM	BLANK STANDARD	TOLERANCE	CHAMFER	PAGE
	M	BS 949	Zone 5	T/S/B	347
	MF	BS 949	Zone 5	T/S/B	349
	BSW	BS 949	Zone 5	T/S/B	351
	BSF	BS 949	Zone 5	T/S/B	353
	BA	BS 949	Zone 5	T/S/B	354
	BSB	BS 949	Zone 5	T/S/B	355
	BS Con	BS 949	Zone 5	T/B	356
	ME	BS 949	Zone 5	T/S/B	357
	BS Cy	BS 949	Zone 5	T/S/B	358
	WF	BS 949	Zone 5	T/S/B	359
	BSP	BS 949	Zone 5	T/B	360
	BSPT	BS 949	Zone 5	T/B	361
	UNC	BS 949	2B	T/S/B	362
	UNF	BS 949	2B	T/S/B	363
	NPT	BS 949	Zone 5	T/B	365
	NPS	ANSI 949	Zone 5	T/B	366
	UNS	ANSI 949	Zone 5	T/S/B	367



# M Metric coarse threads

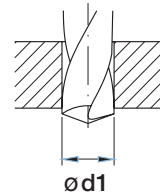
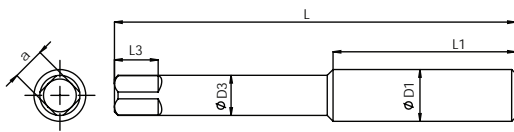
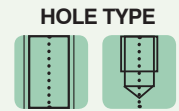
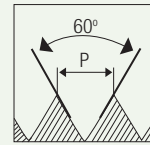

Unit : mm

Nominal Diameter	Pitch	EDP No.	Overall Length	Thread Length	Shank Diameter	Square Size	Square Length	Tapping Drill Diameter
ØD1	p		L	L1	ØD3	a	L3	Ød1
M 2	0.4	FBA0204977	44.03	11.5	3.25	2.58	4.46	1.6
M 2.2	0.45	FBA0205005	45.72	15	3.25	2.58	4.46	1.75
M 2.5	0.45	FBA0205061	47.51	15	3.25	2.58	4.46	2.05
M 3	0.5	FBA0205117	49.4	17	3.25	2.58	4.46	2.5
M 3.5	0.6	FBA0205174	52.85	20.6	3.66	2.86	4.46	2.9
M 4	0.7	FBA0205231	56.33	22.5	4.22	3.26	6.05	3.3
M 4.5	0.75	FBA0205318	62.99	26.6	4.8	3.69	6.05	3.7
M 5	0.8	FBA0205404	63.29	26.6	5.41	4.15	6.05	4.2
M 6	1	FBA0205632	67.04	30.7	6.15	4.71	6.84	5
M 7	1	FBA0205716	67.68	30.7	7.21	5.5	7.64	6
M 8	1.25	FBA0205831	69.85	30.5	8.2	6.23	8.43	6.8
M 9	1.25	FBA0205943	74.61	33.7	9.12	6.9	10.02	7.8
M 10	1.5	FBA0206091	74.61	33.7	10.29	7.73	10.02	8.5
M 11	1.5	FBA0206204	80.17	36.5	8.2	6.06	10.02	9.5
M 12	1.5	FBA0206324	85.83	42.1	9.32	6.9	10.81	10.5
M 12	1.75	FBA0206356	85.83	42.1	9.32	6.9	10.81	10.2
M 14	1.5	FBA0206529	91.28	42	10.91	8.07	12.4	12.5
M 14	2	FBA0206560	91.28	42	10.91	8.07	12.4	12



Carbon Steel Hand Taps

HSS TAPS

DIES

END MILLS

DRILLS

CARBIDE BURRS

CS TAPS

M

## Metric coarse threads

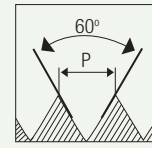

HOLE TYPE



CS

BS 949

ZONE 5

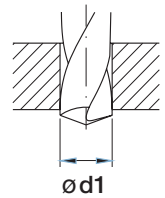
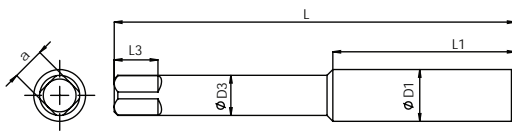

Unit : mm

Nominal Diameter	Pitch	EDP No.	Overall Length	Thread Length	Shank Diameter	Square Size	Square Length	Tapping Drill Diameter
ØD1	p		L	L1	ØD3	a	L3	Ød1
M 16	2	FBA0206759	96.84	46	12.2	9.04	13.99	14
M 18	2.5	FBA0206986	102.4	46	13.78	10.2	15.58	15.5
M 20	2.5	FBA0207100	107.95	50.8	15	11.12	17.16	17.5
M 22	2.5	FBA0207215	119.06	56.4	17.71	13.17	18.75	19.5
M 24	3	FBA0207359	124.62	56.35	19.31	14.37	18.75	21
M 27	3	FBA0207559	129.8	63.5	20.35	15.13	20.2	24
M 30	3.5	FBA0207815	137.8	65	22.79	16.96	21.9	26.5
M 33	3.5	FBA0208015	145.8	65	25.98	19.34	25.2	29.5
M 36	4	FBA0208155	153.8	76	28.17	20.99	26.7	32
M 39	4	FBA0208211	161.8	76	31.35	23.38	28.2	35
M 42	4.5	FBA0208295	169.8	81	33.18	24.75	28.2	37.5
M 45	4.5	FBA0208323	177.8	81	36.35	27.12	31.7	40.5
M 48	5	FBA0208351	185.3	90.5	38.61	28.82	31.7	43
M 52	5	FBA0208407	193.3	90.5	38.61	28.82	31.7	47



**MF**

**Metric fine threads**

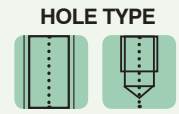
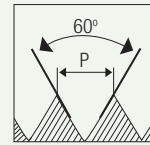

**CS**

**BS 949**

**ZONE 5**

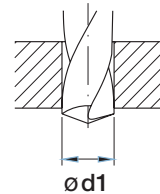
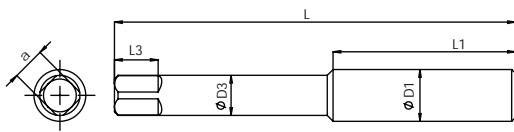

Unit : mm

Nominal Diameter	Pitch	EDP No.	Overall Length	Thread Length	Shank Diameter	Square Size	Square Length	Tapping Drill Diameter
ØD1	p		L	L1	ØD3	a	L3	Ød1
M 2.3	0.4	FBA0205033	45.81	15.00	3.25	2.58	4.46	1.9
M 2.6	0.45	FBA0205089	49.16	17.00	3.25	2.58	4.46	2.1
M 3	0.6	FBA0205146	49.36	17.00	3.25	2.58	4.46	2.4
M 4	0.5	FBA0205202	56.33	22.50	4.22	3.26	6.05	3.5
M 4	0.75	FBA0205259	56.33	22.50	4.22	3.26	6.05	3.25
M 5	0.5	FBA0205346	63.29	26.60	5.41	4.15	6.05	4.5
M 5	0.9	FBA0205432	63.29	26.60	5.41	4.15	6.05	4.1
M 5.5	0.9	FBA0205517	63.58	26.60	5.61	4.30	6.05	4.6
M 6	0.75	FBA0205573	67.13	30.70	6.15	4.71	6.84	5.2
M 8	0.75	FBA0205772	69.85	30.50	8.20	6.23	8.43	7.2
M 8	1	FBA0205800	69.85	30.50	8.20	6.23	8.43	7
M 9	1	FBA0205915	74.61	33.70	9.12	6.90	10.02	8
M 10	0.75	FBA0205999	74.61	33.70	10.29	7.73	10.02	9.2
M 10	1	FBA0206027	74.61	33.70	10.29	7.73	10.02	9
M 10	1.25	FBA0206059	74.61	33.70	10.29	7.73	10.02	8.8
M 12	1	FBA0206260	76.20	31.75	9.32	6.90	10.81	11
M 12	1.25	FBA0206292	76.20	31.75	9.32	6.90	10.81	10.75
M 14	1.25	FBA0206497	76.20	31.75	10.91	8.07	12.40	12.75



Carbon Steel Hand Taps

HSS TAPS

DIES

END MILLS

DRILLS

CARBIDE BURRS

CS TAPS

**MF**

**Metric fine threads**

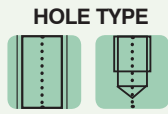
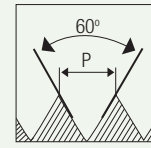

CS
BS 949
ZONE 5
T/S/B

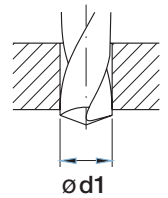
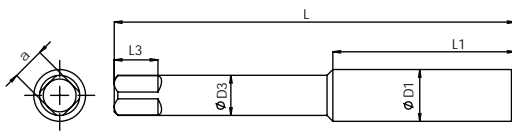

Unit : mm

Nominal Diameter	Pitch	EDP No.	Overall Length	Thread Length	Shank Diameter	Square Size	Square Length	Tapping Drill Diameter
ØD1	p		L	L1	ØD3	a	L3	Ød1
M 16	1	FBA0206672	76.20	31.75	12.20	9.04	13.99	15
M 18	1.5	FBA0206927	76.20	31.75	13.78	10.20	15.58	16.5
M 20	1	FBA0207014	82.55	38.10	15.00	11.12	17.16	19
M 22	1.5	FBA0207156	82.55	38.10	17.71	13.17	18.75	20.5
M 24	1.5	FBA0207271	82.55	38.10	19.31	14.37	18.75	22.5
M 25	1.5	FBA0207387	82.55	38.10	20.33	15.13	20.34	23.5
M 26	1.5	FBA0207445	82.35	38.10	20.35	15.13	20.20	24.5
M 27	1.5	FBA0207501	82.35	38.10	20.35	15.13	20.20	25.5
M 28	1.5	FBA0207615	101.40	38.10	21.21	15.77	20.30	26.5
M 30	1.5	FBA0207700	101.40	38.10	22.79	16.96	21.90	28.5
M 30	2	FBA0207729	101.40	38.10	22.79	16.96	21.90	28
M 32	1.5	FBA0207871	101.40	38.10	25.98	19.34	25.20	31.5
M 40	1.5	FBA0208239	101.40	38.10	31.35	23.38	28.20	38



Carbon Steel Hand Taps

**BSW**

**Whitworth coarse threads**

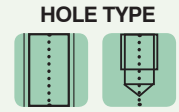
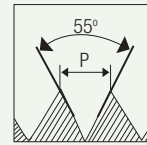

**CS**

**BS 949**

**ZONE 5**

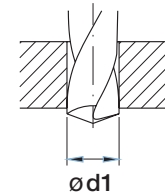
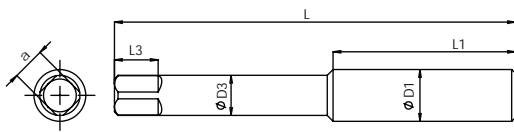

Unit : mm

Nominal Diameter	TPI	EDP No.	Overall Length	Thread Length	Shank Diameter	Square Size	Square Length	Tapping Drill Diameter
ØD1			L	L1	ØD3	a	L3	ød1
1/16"	60	FBA0200001	42.19	10.5	3.25	2.58	4.46	-
3/32"	48	FBA0200029	47.41	15	3.25	2.58	4.46	-
1/8"	40	FBA0200057	51.05	18.8	3.25	2.58	4.46	-
5/32"	32	FBA0200085	56.28	22.3	4.04	3.03	6.05	-
3/16"	24	FBA0200113	63.04	26.6	4.8	3.69	6.05	3.7
7/32"	24	FBA0200141	63.56	26.6	5.61	4.3	6.05	4.5
1/4"	20	FBA0200169	67.17	30.7	6.43	4.91	6.84	5.1
9/32"	20	FBA0200197	67.68	30.7	7.21	5.5	7.64	5.8
5/16"	18	FBA0200225	69.85	30.5	8	6.06	8.43	6.5
3/8"	16	FBA0200253	74.61	33.7	9.58	7.38	10.02	7.9
7/16"	14	FBA0200281	80.17	36.5	8.2	6.06	10.02	9.3
1/2"	12	FBA0200309	85.83	42.1	9.32	6.9	10.81	10.5
9/16"	12	FBA0200338	91.28	42	10.91	8.07	12.4	12.1
5/8"	11	FBA0200366	96.84	46	12.2	9.04	13.99	13.5
11/16"	11	FBA0200394	102.4	46	13.78	10.2	15.58	15
3/4"	10	FBA0200422	107.95	50.8	15	11.12	17.16	16.25
7/8"	9	FBA0200478	119.06	56.4	17.71	13.18	18.75	19.25
1"	8	FBA0200534	130.18	63.5	20.33	15.13	20.34	22

HSS TAPS

DIES

END MILLS

DRILLS

CARBIDE BURRS

CS TAPS



Carbon Steel Hand Taps

HSS TAPS

DIES

END MILLS

DRILLS

CARBIDE BURRS

CS TAPS

**BSW**

**Whitworth coarse threads**

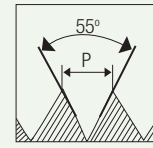

HOLE TYPE



CS

BS  
949

ZONE  
5

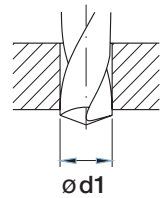
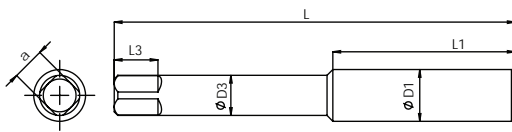

Unit : mm

Nominal Diameter	TPI	EDP No.	Overall Length	Thread Length	Shank Diameter	Square Size	Square Length	Tapping Drill Diameter
ØD1			L	L1	ØD3	a	L3	Ø d1
1.1/8"	7	FBA0200562	137.8	65	22.79	16.96	21.7	24.75
1.1/4"	7	FBA0200590	145.8	65	25.96	19.34	25.2	28
1.3/8"	6	FBA0200618	153.8	76	28.17	20.99	26.7	31
1.1/2"	6	FBA0200646	161.8	76	31.35	23.38	28.2	33.5
1.3/4"	5	FBA0200702	177.8	81	36.35	27.12	31.7	39
2"	4.5	FBA0200758	193.3	90.5	41.79	31.21	34.7	44.5





Carbon Steel Hand Taps

**BSF**

**Whitworth fine threads**

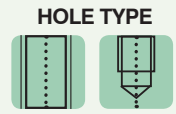
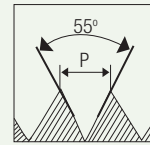

**CS**

**BS  
949**

**ZONE  
5**



HSS TAPS

DIES

END MILLS

DRILLS

CARBIDE BURRS

CS TAPS

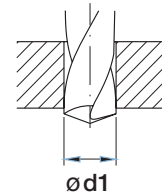
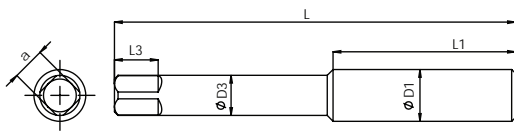

Unit : mm

Nominal Diameter	TPI	EDP No.	Overall Length	Thread Length	Shank Diameter	Square Size	Square Length	Tapping Drill Diameter
ØD1			L	L1	ØD3	a	L3	Ød1
3/16"	32	FBA0200842	63.15	26.6	4.8	3.69	6.05	4
7/32"	28	FBA0200870	63.61	26.6	5.61	4.3	6.05	4.6
1/4"	26	FBA0200898	67.27	30.7	6.43	4.91	6.84	5.3
9/32"	26	FBA0200926	67.79	30.7	7.21	5.5	7.64	6.1
5/16"	22	FBA0200954	69.85	30.5	8	6.06	8.43	6.8
3/8"	20	FBA0200982	74.61	33.7	9.58	7.38	10.02	8.3
7/16"	18	FBA0201011	80.17	36.5	8.2	6.06	10.02	9.7
1/2"	16	FBA0201039	85.83	42.1	9.32	6.9	10.81	11.1
9/16"	16	FBA0201067	91.28	42	10.91	8.07	12.4	12.7
5/8"	14	FBA0201095	96.84	46	12.2	9.04	13.99	14
11/16"	14	FBA0201123	102.4	46	13.78	10.19	15.58	15.5
3/4"	12	FBA0201151	107.95	50.8	15	11.12	17.16	16.75
7/8"	11	FBA0201207	119.06	56.4	17.71	13.18	18.75	19.75
1"	10	FBA0201263	130.18	63.5	20.33	15.13	20.34	22.75
1.1/8"	9	FBA0201291	137.8	65	22.79	16.96	21.7	25.5
1.1/4"	9	FBA0201319	145.8	65	25.96	19.34	25.2	28.5
1.3/8"	8	FBA0201347	153.8	76	28.17	20.99	26.7	31.5
1.1/2"	8	FBA0201375	161.8	76	31.35	23.38	28.2	34.5



Carbon Steel Hand Taps

HSS TAPS

DIES

END MILLS

DRILLS

CARBIDE BURRS

CS TAPS

**BA**

**British association threads**

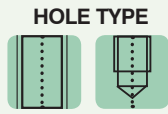
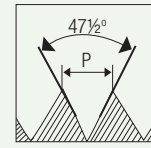

CS

BS 949

ZONE 5

T/S/B

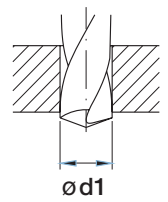
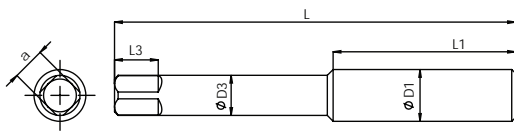

Unit : mm

Nominal Diameter	p	EDP No.	Overall Length	Thread Length	Shank Diameter	Square Size	Square Length	Tapping Drill Diameter
ØD1			L	L1	ØD3	a	L3	ød1
# 12	0.28	FBA0209359	42.00	10.50	3.25	2.58	4.46	1.05
# 11	0.31	FBA0209387	42.08	10.50	3.25	2.58	4.46	1.2
# 10	0.35	FBA0209415	42.29	11.50	3.25	2.58	4.46	1.4
# 9	0.39	FBA0209443	43.98	11.50	3.25	2.58	4.46	1.55
# 8	0.43	FBA0209471	45.76	15.00	3.25	2.58	4.46	1.8
# 7	0.48	FBA0209499	47.52	15.00	3.25	2.58	4.46	2.05
# 6	0.53	FBA0209527	49.29	17.00	3.25	2.58	4.46	2.3
# 5	0.59	FBA0209555	51.11	18.80	3.25	2.58	4.46	2.65
# 4	0.66	FBA0209583	52.92	20.60	3.66	2.86	4.46	3
# 3	0.73	FBA0209611	56.42	22.50	4.22	3.26	6.05	3.4
# 2	0.81	FBA0209639	63.13	26.60	4.80	3.69	6.05	4
# 1	0.9	FBA0209667	63.47	26.60	5.41	4.15	6.05	4.5
# 0	1	FBA0209695	67.07	30.70	6.15	4.71	6.84	5.1



Carbon Steel Hand Taps

**BSB**

**British brass threads**

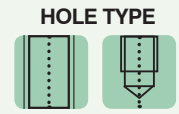
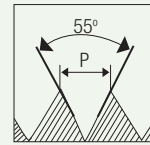

**CS**

**BS 949**

**ZONE 5**



HSS TAPS

DIES

END MILLS

DRILLS

CARBIDE BURRS

CS TAPS

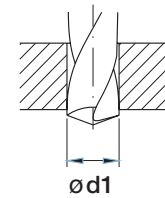
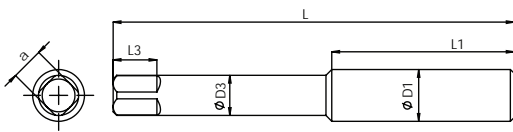

Unit : mm

Nominal Diameter	TPI	EDP No.	Overall Length	Thread Length	Shank Diameter	Square Size	Square Length	Tapping Drill Diameter
ØD1			L	L1	ØD3	a	L3	Ød1
1/4"	26	FBA0201487	67.27	30.7	6.43	4.91	6.84	5.3
5/16"	26	FBA0201515	69.85	30.5	8	6.06	8.43	6.9
3/8"	26	FBA0201543	74.61	33.7	9.58	7.38	10.02	8.4
7/16"	26	FBA0201571	76.2	31.75	8.2	6.06	10.02	9.9
1/2"	26	FBA0201599	76.2	31.75	9.32	6.9	10.81	11.5
9/16"	26	FBA0201627	76.2	31.75	10.91	8.07	12.4	13.1
5/8"	26	FBA0201655	76.2	31.75	12.2	9.04	13.99	14.65
3/4"	26	FBA0201683	82.55	38.1	15	11.12	17.16	17.86
1"	26	FBA0201711	82.55	38.1	20.33	15.13	20.34	17.86



Carbon Steel Hand Taps

HSS TAPS

DIES

END MILLS

DRILLS

CARBIDE BURRS

CS TAPS

# BS Con

## British conduit threads

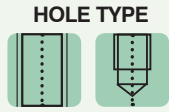
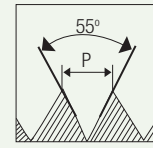

CS

BS 949

ZONE 5

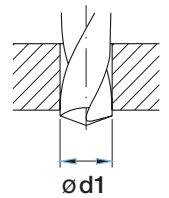
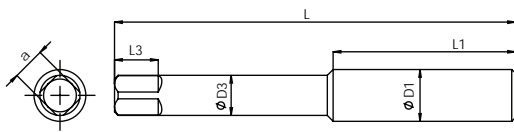

Unit : mm

Nominal Diameter	TPI	EDP No.	Overall Length	Thread Length	Shank Diameter	Square Size	Square Length	Tapping Drill Diameter
ØD1			L	L1	ØD3	a	L3	Ød1
1/2"	18	FBA0209023	76.2	31.75	9.32	6.9	10.81	11.1
5/8"	18	FBA0209051	76.2	31.75	12.2	9.04	13.99	14
3/4"	16	FBA0209079	82.55	38.1	15	11.12	17.16	17.5
1"	16	FBA0209107	82.55	38.1	20.33	15.13	20.34	23.5



Carbon Steel Hand Taps



Model engineer threads

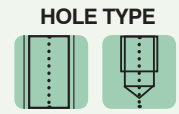
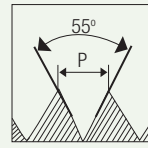

CS

BS  
949

ZONE  
5

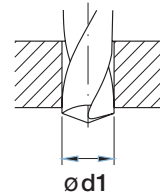
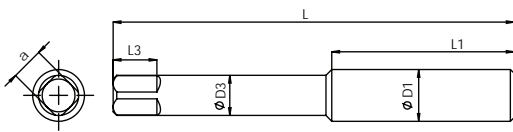

Unit : mm

Nominal Diameter	TPI	EDP No.	Overall Length	Thread Length	Shank Diameter	Square Size	Square Length	Tapping Drill Diameter
ØD1			L	L1	ØD3	a	L3	Ød1
1/8"	40	FBA0203295	51.05	18.8	3.25	2.58	4.46	2.55
5/32"	40	FBA0203323	56.34	22.5	4.04	3.03	6.05	3.25
3/16"	40	FBA0203351	63.21	26.6	4.8	3.69	6.05	4.1
7/32"	40	FBA0203379	63.73	26.6	5.61	4.3	6.05	4.9
1/4"	40	FBA0203407	67.4	30.7	6.43	4.91	6.84	5.8
9/32"	32	FBA0203435	67.87	30.7	7.21	5.5	7.64	6.1
5/16"	32	FBA0203463	69.85	30.5	8	6.06	8.43	7.1
3/8"	32	FBA0203491	74.61	33.7	9.58	7.38	10.02	8.6

HSS TAPS

DIES

END MILLS

DRILLS

CARBIDE BURRS

CS TAPS



Carbon Steel Hand Taps

HSS TAPS

DIES

END MILLS

DRILLS

CARBIDE BURRS

CS TAPS

**BS Cy**

**British cycle threads**

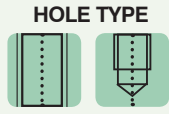
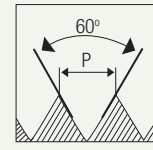

CS

BS 949

ZONE 5

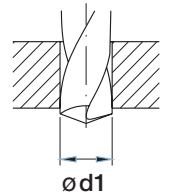
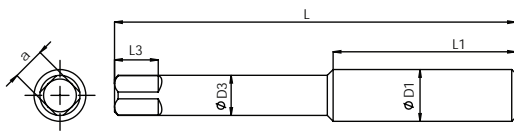

Unit : mm

Nominal Diameter	TPI	EDP No.	Overall Length	Thread Length	Shank Diameter	Square Size	Square Length	Tapping Drill Diameter
ØD1			L	L1	ØD3	a	L3	Ød1
3/16"	32	FBA0208435	63.21	26.6	4.8	3.69	6.05	4.1
1/4"	26	FBA0208491	67.36	30.7	6.43	4.91	6.84	5.6
5/16"	26	FBA0208519	69.85	30.5	8	6.06	8.43	7.1
3/8"	26	FBA0208547	74.61	33.7	9.58	7.38	10.02	8.7
7/16"	26	FBA0208575	76.2	31.75	8.2	6.06	10.02	10.3
1/2"	26	FBA0208603	76.2	31.75	9.32	6.9	10.81	11.9



Carbon Steel Hand Taps

**WF**

**Whitworth fine threads special**

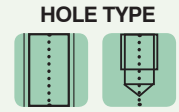
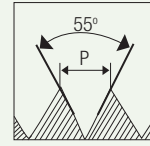

**CS**

**BS  
949**

**ZONE  
5**

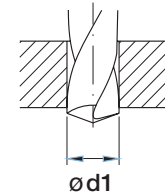
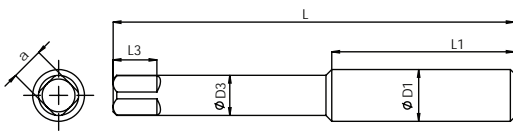

Unit : mm

Nominal Diameter	TPI	EDP No.	Overall Length	Thread Length	Shank Diameter	Square Size	Square Length	Tapping Drill Diameter
ØD1			L	L1	ØD3	a	L3	Ød1
3/16"	28	FBA0204641	63.1	26.6	4.8	3.69	6.05	
7/32"	32	FBA0204669	63.73	26.6	5.61	4.3	6.05	
1/4"	32	FBA0204697	67.36	30.7	6.43	4.91	6.84	5.6
5/16"	40	FBA0204753	69.85	30.5	8	6.06	8.43	7.3
3/8"	40	FBA0204809	74.61	33.7	9.58	7.38	10.02	8.9
7/16"	40	FBA0204837	76.2	31.75	8.2	6.06	10.02	
7/16"	32	FBA0204865	76.2	31.75	8.2	6.06	10.02	
1/2"	40	FBA0204893	76.2	31.75	9.32	6.9	10.81	
1/2"	32	FBA0204921	76.2	31.75	9.32	6.9	10.81	

HSS TAPS

DIES

END MILLS

DRILLS

CARBIDE BURRS

CS TAPS



Carbon Steel Hand Taps

HSS TAPS

DIES

END MILLS

DRILLS

CARBIDE BURRS

CS TAPS

**BSP**

**British standard pipe threads**

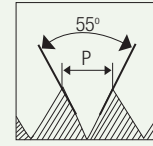

HOLE TYPE



CS

BS  
949

ZONE  
5

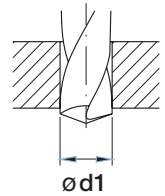
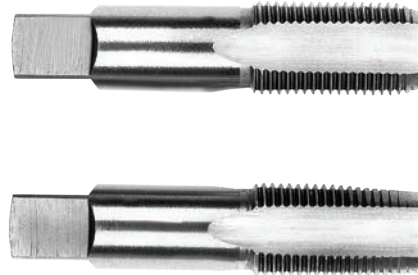
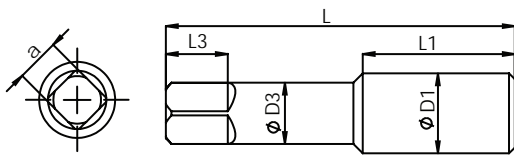

Unit : mm

Nominal Diameter	TPI	EDP No.	Overall Length	Thread Length	Shank Diameter	Square Size	Square Length	Tapping Drill Diameter
ØD1			L	L1	ØD3	a	L3	Ød1
1/8"	28	FBA0208631	53.98	19.05	8.08	5.96	7.64	8.8
1/4"	19	FBA0208659	61.91	26.99	10.91	8.07	10.81	11.8
3/8"	19	FBA0208687	65.09	26.99	13.78	10.2	12.4	15.25
1/2"	14	FBA0208715	79.38	34.92	17.46	12.97	15.58	19
5/8"	14	FBA0208743	80.96	34.92	20.33	15.13	17.16	21
3/4"	14	FBA0208771	82.55	34.92	22.99	17.14	17.16	24.5
7/8"	14	FBA0208799	88.9	39.69	27.74	20.51	18.75	28.25
1"	11	FBA0208827	95.25	44.45	28.56	21.3	20.34	30.75
1.1/4"	11	FBA0208883	101.3	44.5	33.35	24.88	23.7	39.5
1.1/2"	11	FBA0208939	107.8	44.5	38.13	28.46	25.2	45
1.3/4"	11	FBA0208967	110.8	44.5	41.3	30.82	26.7	51
2"	11	FBA0208995	114.3	44.5	47.65	35.54	28.2	57





**BSPT**

**British standard taper pipe threads**

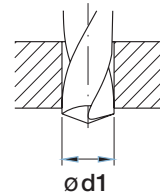
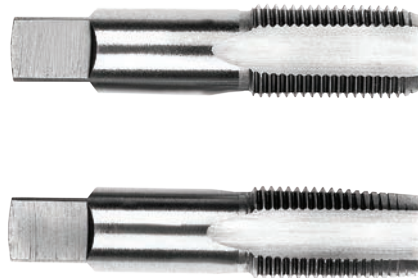
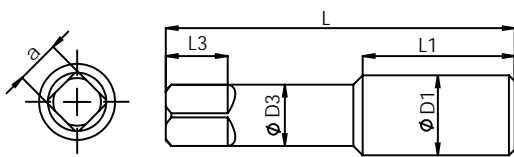
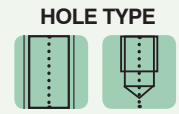
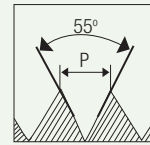

Unit : mm

Nominal Diameter	TPI	EDP No.	Overall Length	Thread Length	Shank Diameter	Square Size	Square Length	Tapping Drill Diameter
ØD1			L	L1	ØD3	a	L3	Ød1
1/8"	28	FBA0209135	54	19.1	8.08	6.05	7.9	8.4
1/4"	19	FBA0209163	61.9	27	10.9	8.18	11.1	11.5
3/8"	19	FBA0209191	65.1	27	13.77	10.31	12.7	14.75
1/2"	14	FBA0209219	79.4	34.9	17.45	13.08	15.9	18.25
5/8"	14	FBA0211009	81	34.9	20.32	15.24	17.5	20.25
3/4"	14	FBA0209247	82.6	34.9	23.01	17.25	17.5	23.4
1"	11	FBA0209275	95.3	44.5	28.58	21.41	20.6	29.75
1.1/4"	11	FBA0209303	101.6	44.5	33.32	24.99	23.8	38.1
1.1/2"	11	FBA0209331	108	44.5	38.1	28.58	25.4	44.5
2"	11	FBA0211037	114.3	44.5	47.63	35.71	28.6	56.4



Carbon Steel Hand Taps

HSS TAPS

DIES

END MILLS

DRILLS

CARBIDE BURRS

CS TAPS

**UNC**

**Unified coarse threads**

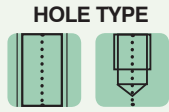
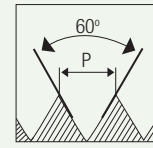

CS
BS 949
2B
T/S/B

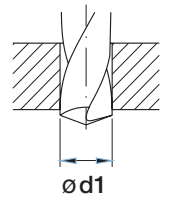
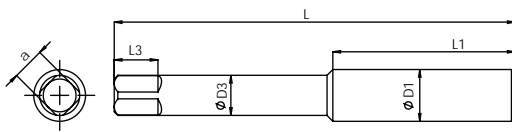

Unit : mm

Nominal Diameter	TPI	EDP No.	Overall Length	Thread Length	Shank Diameter	Square Size	Square Length	Tapping Drill Diameter
ØD1			L	L1	ØD3	a	L3	Ød1
# 4	40	FBA0202566	49.26	17	3.58	2.7	4.46	2.35
# 5	40	FBA0202622	51.04	18.8	3.58	2.7	4.46	2.65
# 6	32	FBA0202650	52.79	20.6	3.58	2.7	4.46	2.85
# 8	32	FBA0202706	56.39	22.5	4.27	3.24	6.05	3.5
# 10	24	FBA0202734	63.07	26.6	4.93	3.77	6.05	3.9
# 12	24	FBA0202790	63.5	28.5	5.61	4.1	6.84	4.5
1/4"	20	FBA0202818	67.15	30.7	6.48	4.76	7.64	5.1
5/16"	18	FBA0202846	73.68	35.2	8.08	5.96	9.23	6.6
3/8"	16	FBA0202874	74.61	33.7	9.68	7.17	10.81	8
7/16"	14	FBA0202902	80.17	36.5	8.2	6.06	10.02	9.4
1/2"	13	FBA0202930	85.83	42.1	9.32	6.9	10.81	10.8
9/16"	12	FBA0202958	91.28	42	10.91	8.07	12.4	12.2
5/8"	11	FBA0202986	96.84	46	12.2	9.04	13.99	13.5
3/4"	10	FBA0203042	107.95	50.8	15	11.12	17.16	16.5
7/8"	9	FBA0203070	119.06	56.4	17.71	13.18	18.75	19.5
1"	8	FBA0203098	130.18	63.5	20.33	15.13	20.34	22.25
1.1/8"	7	FBA0203126	137.8	65	22.79	16.96	21.7	25
1.1/4"	7	FBA0203155	145.8	65	25.96	19.34	25.2	28
1.3/8"	6	FBA0203183	153.8	76	28.17	20.99	26.7	30.75
1.1/2"	6	FBA0203211	161.8	76	31.35	23.38	28.2	34
1.3/4"	5	FBA0203239	177.8	81	36.35	27.12	31.7	39.5
2"	4.1/2	FBA0203267	193.7	90.5	41.79	31.21	34.7	45



Carbon Steel Hand Taps

**UNF**

**Unified fine threads**

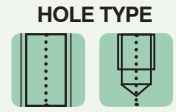
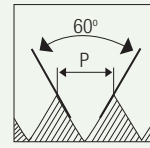

**CS**

**BS  
949**

**2B**



HSS TAPS

DIES

END MILLS

DRILLS

CARBIDE BURRS

CS TAPS

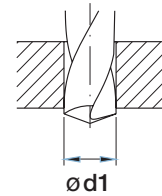
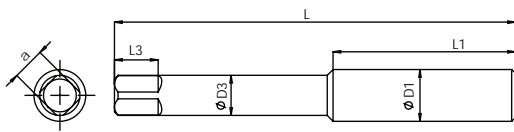

Unit : mm

Nominal Diameter	TPI	EDP No.	Overall Length	Thread Length	Shank Diameter	Square Size	Square Length	Tapping Drill Diameter
ØD1			L	L1	ØD3	a	L3	Ød1
# 5	44	FBA0201879	51.06	18.8	3.58	2.7	4.46	2.7
# 6	40	FBA0201907	52.85	20.6	3.58	2.7	4.46	2.95
# 8	36	FBA0201963	56.43	22.5	4.27	3.24	6.05	3.5
# 10	32	FBA0201991	63.17	26.6	4.93	3.77	6.05	4.1
# 12	28	FBA0202048	63.56	28.5	5.61	4.1	6.84	4.7
1/8"	44	FBA0201851	51.06	18.8	3.58	2.7	4.46	
5/32"	36	FBA0201935	63.13	22.5	4.27	3.24	6.05	
3/16"	32	FBA0202020	63.13	26.6	4.93	3.77	6.05	
1/4"	28	FBA0202077	67.28	30.7	6.48	4.76	7.64	5.5
5/16"	24	FBA0202106	73.82	35.2	8.08	5.96	9.23	6.9
3/8"	24	FBA0202135	74.61	33.7	9.68	7.17	10.81	8.5
7/16"	20	FBA0202164	80.17	36.5	8.2	6.06	10.02	9.9
1/2"	20	FBA0202193	85.83	42.1	9.32	6.9	10.81	11.5
9/16"	18	FBA0202222	91.28	42	10.91	8.07	12.4	12.9
5/8"	18	FBA0202252	96.84	46	12.2	9.04	13.99	14.5
3/4"	16	FBA0202281	107.95	50.8	15	11.12	17.16	17.5



Carbon Steel Hand Taps

HSS TAPS

DIES

END MILLS

DRILLS

CARBIDE BURRS

CS TAPS

# UNF Unified fine threads

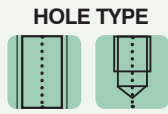
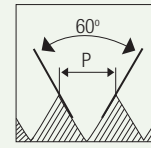

CS
BS 949
2B
T/S/B

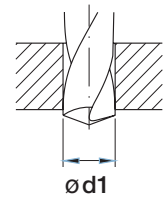
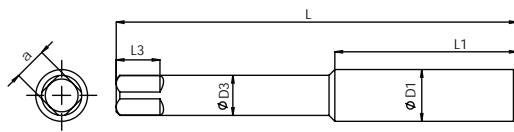

Unit : mm

Nominal Diameter	TPI	EDP No.	Overall Length	Thread Length	Shank Diameter	Square Size	Square Length	Tapping Drill Diameter
ØD1			L	L1	ØD3	a	L3	Ød1
7/8"	14	FBA0202310	119.06	56.4	17.71	13.18	18.75	20.4
1"	12	FBA0202339	130.18	63.5	20.33	15.13	20.34	23.25
1.1/8"	12	FBA0202368	137.8	65	22.79	16.96	21.7	26.5
1.1/4"	12	FBA0202396	145.8	65	25.96	19.34	25.2	29.5
1.3/8"	12	FBA0202425	153.8	76	28.17	20.99	26.7	32.75
1.1/2"	12	FBA0202454	161.8	76	31.35	23.38	28.2	36



**NPT**

**American taper pipe threads**

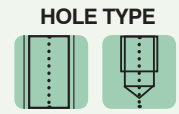
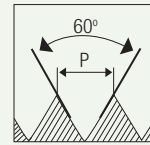

- HSS TAPS
- DIES
- END MILLS
- DRILLS
- CARBIDE BURRS
- CS TAPS

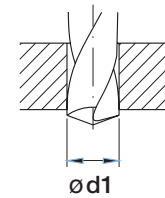
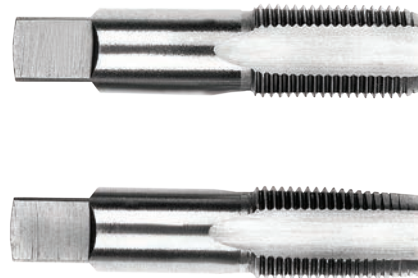
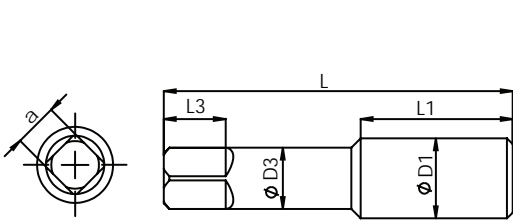

Unit : mm

Nominal Diameter	TPI	EDP No.	Overall Length	Thread Length	Shank Diameter	Square Size	Square Length	Tapping Drill Diameter
ØD			L	L1	ØD3	a	L3	Ød1
1/8"	27	FBA0209891	54	19.1	8.08	6.05	7.9	8.7
1/4"	18	FBA0209919	61.9	27	10.9	8.18	11.1	11.1
3/8"	18	FBA0209947	65.1	27	13.77	10.31	12.7	14.7
1/2"	14	FBA0209975	79.4	34.9	17.45	13.08	15.9	17.9
3/4"	14	FBA0210031	82.6	34.9	23.01	17.25	17.5	23.4
1"	11.1/2	FBA0210059	95.3	44.5	28.58	21.41	20.6	29.4
1.1/4"	11.1/2	FBA0210087	101.6	44.5	33.32	24.99	23.8	38.1
1.1/2"	11.1/2	FBA0210115	108	44.5	38.1	28.58	25.4	44
2"	11.1/2	FBA0210143	114.3	44.5	47.63	35.71	28.6	56.4



Carbon Steel Hand Taps

HSS TAPS

DIES

END MILLS

DRILLS

CARBIDE BURRS

CS TAPS

NPS

National pipe threads special

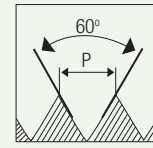

HOLE TYPE



CS

ANSI 949

ZONE 5

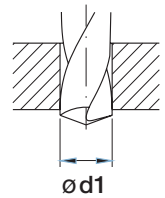
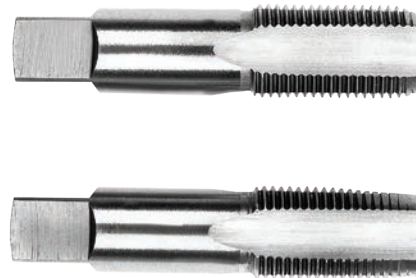
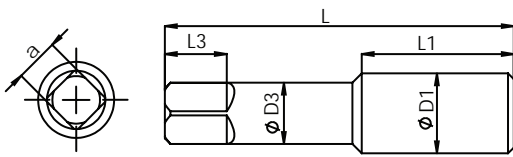

Unit : mm

Nominal Diameter	TPI	EDP No.	Overall Length	Thread Length	Shank Diameter	Square Size	Square Length	Tapping Drill Diameter
ØD1			L	L1	ØD3	a	L3	Ød1
1/8"	27	FBA0209723	53.97	19.05	8.08	5.96	7.64	9.1
1/4"	18	FBA0209751	61.91	26.98	10.91	8.07	10.81	11.9
3/8"	18	FBA0209779	65.09	26.99	13.78	10.2	12.4	15.25
1/2"	14	FBA0209807	79.38	34.92	17.46	12.97	15.58	19
3/4"	14	FBA0209835	82.55	34.92	22.99	17.14	17.16	27
1"	11.5	FBA0209863	95.25	44.45	28.56	21.3	20.34	30.5



Carbon Steel Hand Taps

UNS

Unified threads special

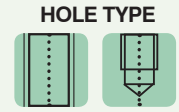
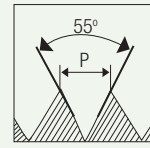

CS

ANSI 949

ZONE 5

T/S/B

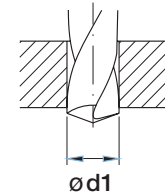
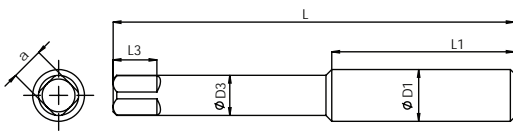

Unit : mm

Nominal Diameter	TPI	EDP No.	Overall Length	Thread Length	Shank Diameter	Square Size	Square Length	Tapping Drill Diameter
ØD1			L	L1	ØD3	a	L3	Ød1
1/8"	40	FBA0203547	51.04	18.8	3.58	2.7	4.46	
5/32"	32	FBA0203631	56.26	22.5	4.27	3.24	6.05	3.6
5/32"	36	FBA0203659	56.31	22.5	4.27	3.24	6.05	3.65
7/32"	24	FBA0203743	63.55	28.5	5.61	4.1	6.84	
7/32"	28	FBA0203715	63.65	28.5	5.61	4.1	6.84	
7/32"	32	FBA0203771	63.65	28.5	5.61	4.1	6.84	
3/16"	24	FBA0203799	63.03	26.6	4.93	3.77	6.05	4.25
3/16"	32	FBA0203829	63.13	26.6	4.93	3.77	6.05	4.4
1/4"	20	FBA0203857	67.01	30.7	6.48	4.76	7.64	
1/4"	24	FBA0203885	67.23	30.7	6.48	4.76	7.64	
1/4"	32	FBA0203913	67.34	30.7	6.48	4.76	7.64	
5/16"	32	FBA0203941	73.68	35.2	8.08	5.96	10.02	7.5
11/16"	11	FBA0203969	102.4	46	13.78	10.2	15.58	16.4
11/16"	16	FBA0203997	102.4	46	13.78	10.2	15.58	16.7
7/8"	12	FBA0204053	119.06	56.4	17.71	13.18	18.75	
7/8"	18	FBA0204025	119.06	56.4	17.71	13.18	18.75	
1"	14	FBA0204081	130.18	63.5	20.33	15.13	20.34	24.6
1-1/8"	8	FBA0204137	137.8	65	22.79	16.96	21.7	

HSS TAPS

DIES

END MILLS

DRILLS

CARBIDE BURRS

CS TAPS



Carbon Steel Hand Taps

HSS TAPS

DIES

END MILLS

DRILLS

CARBIDE BURRS

CS TAPS

UNS

Unified threads special

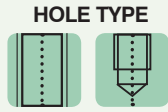
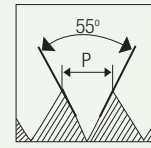

CS

ANSI 949

ZONE 5

T/S/B

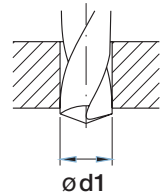
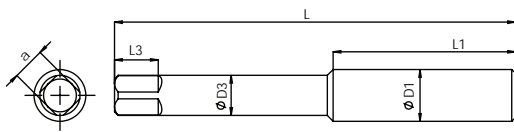

Unit : mm

Nominal Diameter	TPI	EDP No.	Overall Length	Thread Length	Shank Diameter	Square Size	Square Length	Tapping Drill Diameter
ØD1			L	L1	ØD3	a	L3	Ød1
1-1/4"	8	FBA0204165	145.8	65	25.96	19.34	25.2	
1-3/8"	8	FBA0204193	153.8	76	28.17	20.99	26.7	
1-1/2"	8	FBA0204221	161.8	76	31.35	23.38	28.2	
1-5/8"	8	FBA0204249	169.8	81	33.18	24.75	28.2	
1-3/4"	8	FBA0204277	177.8	81	36.35	27.12	31.7	
1-3/4"	12	FBA0204305	177.8	81	36.35	27.12	31.7	
1-7/8"	8	FBA0204333	185.3	90.5	38.61	28.82	31.7	
2"	8	FBA0204389	193.3	90.5	41.79	31.21	34.7	
2"	12	FBA0204417	193.3	90.5	41.79	31.21	34.7	





## TAP AND DIE CASE SETS

Description	EDP No	Content
Ref. No METRIC 1 M6-M20 SECS (20Pc)	FBI0200001	"Taps (Second): M6, M8, M10, M12, M14, M16, M20 Dies: 1" OD- M6 TO M10 & 1.1/2" OD - M12 TO M20 Accessories: Tap Wrenches - 2nos. & Die stock - 2nos."
Ref. No METRIC 2 M6-M20 T&B (28Pc)	FBI0200002	"Taps (Taper & Bottom): M6, M8, M10, M12, M14, M16, M20 Dies: 1" OD- M6 TO M10 & 1.1/2" OD - M12 TO M20 Accessories: Tap Wrenches - 2nos. & Die stock - 2nos."
Ref. No METRIC C119 M6-M20 T&B (37Pc)	FBI0200003	"Taps (Taper & Bottom): M6, M7, M8, M9, M10, M11, M12, M14, M16, M20 Dies: 1" OD- M6 TO M10 & 1.1/2" OD - M11 TO M20 Accessories: Tap Wrenches - 2nos. & Die stock - 2nos."
Ref. No METRIC 3 M3-M10 T&B (21Pc)	FBI0200004	"Taps (Taper & Bottom): M3, M4, M5, M6, M8, M10 Dies: 13/16" OD- M3 TO M5 & 1" OD - M6 TO M10 Accessories: Tap Wrenches - 1no. & Die stock - 2nos."
Ref. No METRIC 4P M2-M6 T&B (17Pc)	FBI0200005	"Taps (Taper & Bottom): M2, M3, M4, M5, M6 Dies: 13/16" OD- M2 TO M6 Accessories: Tap Wrenches - 1no. & Die stock - 1no."
Ref. No METRIC 4S M2-M6 SET (22Pc)	FBI0200006	"Taps (Taper, Second & Bottom): M2, M3, M4, M5, M6 Dies: 13/16" OD- M2 TO M6 Accessories: Tap Wrenches - 1no. & Die stock - 1no."
Ref. No METRIC 5F M6-M24 T&B (35Pc)	FBI0200007	"Taps (Taper & Bottom): MF6, MF8, MF10, MF12, MF14, MF16, MF18, MF20, MF22, MF24 Dies: 1" OD- MF6 TO MF10 & 1.1/2" OD - MF12 TO MF20 & 2" OD -MF22 TO MF24 Accessories: Tap Wrenches - 2nos. & Die stock - 3nos."
Ref. No METRIC C120 M6-M24 T&B (44Pc)	FBI0200008	"Taps (Taper & Bottom): M6, M7, M8, M9, M10, M11, M12, M14, M16, M20, M22, M24 Dies: 1" OD- M6 TO M10 & 1.1/2" OD - M11 TO M16 & 2" OD -M18 TO M24 Accessories: Tap Wrenches - 2nos. & Die stock - 3nos."
Ref. No METRIC 5C M6-M24 T&B (35Pc)	FBI0200009	"Taps (Taper & Bottom): M6, M8, M10, M12, M14, M16, M18, M20, M22, M24 Dies: 1" OD- M6 TO M10 & 1.1/2" OD - M12 TO M20 & 2" OD -M22 TO M24 Accessories: Tap Wrenches - 2nos. & Die stock - 3nos."
Ref. No METRIC 6P M3-M12 T&B (24Pc)	FBI0200010	"Taps (Taper & Bottom): M3, M4, M5, M6, M8, M10, M12 Dies: 1" OD- M3 TO M12 Accessories: Tap Wrenches - 2nos. & Die stock - 1nos."
Ref. No METRIC 6S M3-M12 SET (31Pc)	FBI0200011	"Taps (Taper, Second & Bottom): M3, M4, M5, M6, M8, M10, M12 Dies: 1" OD- M3 TO M12 Accessories: Tap Wrenches - 2nos. & Die stock - 1nos."
Ref. No METRIC C114 M2-M12 T&B (36Pc)	FBI0200012	"Taps (Taper, Second & Bottom): M2, M3, M4, M5, M6, M7, M8, ,M9, M10, M11, M12 Dies: 13/16" OD - M2 TO M6 & 1" OD- M7 TO M12 Accessories: Tap Wrenches - 1nos. & Die stock - 2nos."
Ref. No METRIC 7 M6-M12 T&B (18Pc)	FBI0200013	"Taps (Taper, Second & Bottom): M6, M8, M10, M11, M12 Dies: 1" OD - M6 TO M10 & 1.1/2" OD- M11, M12 Accessories: Tap Wrenches - 1nos. & Die stock - 2nos."
Ref. No METRIC C118 M6-M12 T&B (23Pc)	FBI0200014	"Taps (Taper, Second & Bottom): M6, M7, M8, M9, M10, M11, M12 Dies: 1" OD- M6 TO M12 Accessories: Tap Wrenches - 1nos. & Die stock - 1nos."
Ref. No METRIC 8 M3-M12 T&B (23Pc)	FBI0200015	"Taps (Taper, Second & Bottom): M3, M4, M5, M6, M8, M10, M12 Dies: 1" OD- M3 TO M12 Accessories: Tap Wrenches - 1nos. & Die stock - 1nos."
Ref. No C37 1/4-3/4 BSW T&B (24Pc)	FBI0200016	"Taps (Taper, Second & Bottom): 1/4", 5/16", 3/8", 7/16", 1/2", 5/8", 3/4" Dies: 1" OD- 1/4", 5/16", 3/8" & 1.1/2" OD - 7/16", 1/2", 5/8", 3/4" Accessories: Tap Wrenches - 1nos. & Die stock - 2nos."
Ref. No C37 1/4-3/4 BSF T&B (24Pc)	FBI0200017	"Taps (Taper, Second & Bottom): 1/4", 5/16", 3/8", 7/16", 1/2", 5/8", 3/4" Dies: 1" OD- 1/4", 5/16", 3/8" & 1.1/2" OD - 7/16", 1/2", 5/8", 3/4" Accessories: Tap Wrenches - 1nos. & Die stock - 2nos."

HSS TAPS

DIES

END MILLS

DRILLS

CARBIDE BURRS

CS TAPS



## Carbon Steel Hand Taps



## TAP AND DIE CASE SETS

Description	EDP No	Content
Ref. No C37 1/4-3/4 NF T&B (24Pc)	FBI0200018	"Taps (Taper, Second & Bottom): 1/4", 5/16", 3/8", 7/16", 1/2", 5/8", 3/4" Dies: 1" OD- 1/4", 5/16", 3/8" & 1.1/2" OD - 7/16", 1/2", 5/8", 3/4" Accessories: Tap Wrenches - 1nos. & Die stock - 2nos."
Ref. No C37 1/4-3/4 NC T&B (24Pc)	FBI0200019	"Taps (Taper, Second & Bottom): 1/4", 5/16", 3/8", 7/16", 1/2", 5/8", 3/4" Dies: 1" OD- 1/4", 5/16", 3/8" & 1.1/2" OD - 7/16", 1/2", 5/8", 3/4" Accessories: Tap Wrenches - 1nos. & Die stock - 2nos."
Ref. No INCHES 9 1/4-3/4 BSW T&B (28Pc)	FBI0200020	"Taps (Taper, Second & Bottom): 1/4", 5/16", 3/8", 1/2", 9/16", 5/8", 11/16", 3/4" Dies: 1" OD- 1/4", 5/16", 3/8" & 1.1/2" OD - 9/16", 5/8", 11/16", 3/4" Accessories: Tap Wrenches - 2nos. & Die stock - 2nos."
Ref. No INCHES 9 1/4-3/4 BSF T&B (28Pc)	FBI0200021	"Taps (Taper, Second & Bottom): 1/4", 5/16", 3/8", 1/2", 9/16", 5/8", 11/16", 3/4" Dies: 1" OD- 1/4", 5/16", 3/8" & 1.1/2" OD - 9/16", 5/8", 11/16", 3/4" Accessories: Tap Wrenches - 2nos. & Die stock - 2nos."
Ref. No INCHES 9 1/4-3/4 NC T&B (28Pc)	FBI0200022	"Taps (Taper, Second & Bottom): 1/4", 5/16", 3/8", 1/2", 9/16", 5/8", 11/16", 3/4" Dies: 1" OD- 1/4", 5/16", 3/8" & 1.1/2" OD - 9/16", 5/8", 11/16", 3/4" Accessories: Tap Wrenches - 2nos. & Die stock - 2nos."
Ref. No C31 1/8-1/2 BSW T&B (24Pc)	FBI0200023	"Taps (Taper, Second & Bottom): 1/8", 3/16", 1/4", 5/16", 3/8", 7/16", 1/2" Dies: 13/16" OD- 1/8", 3/16" & 1" OD - 1/4", 5/16", 3/8", 7/16", 1/2" Accessories: Tap Wrenches - 1nos. & Die stock - 2nos."
Ref. No C82 1/4-1/2 BSW T&B (17Pc)	FBI0200024	"Taps (Taper, Second & Bottom): 1/4", 5/16", 3/8", 7/16", 1/2" Dies: 1" OD- 1/4", 5/16", 3/8", 7/16", 1/2" Accessories: Tap Wrenches - 1nos. & Die stock - 1nos."
Ref. No C82 1/4-1/2 BSF T&B (17Pc)	FBI0200025	"Taps (Taper, Second & Bottom): 1/4", 5/16", 3/8", 7/16", 1/2" Dies: 1" OD- 1/4", 5/16", 3/8", 7/16", 1/2" Accessories: Tap Wrenches - 1nos. & Die stock - 1nos."
Ref. No C82 1/4-1/2 NF T&B (17Pc)	FBI0200026	"Taps (Taper, Second & Bottom): 1/4", 5/16", 3/8", 7/16", 1/2" Dies: 1" OD- 1/4", 5/16", 3/8", 7/16", 1/2" Accessories: Tap Wrenches - 1nos. & Die stock - 1nos."
Ref. No C82 1/4-1/2 NC T&B (17Pc)	FBI0200027	"Taps (Taper, Second & Bottom): 1/4", 5/16", 3/8", 7/16", 1/2" Dies: 1" OD- 1/4", 5/16", 3/8", 7/16", 1/2" Accessories: Tap Wrenches - 1nos. & Die stock - 1nos."
Ref. No C52 3/16-1/2 BSW T&B (20Pc)	FBI0200028	"Taps (Taper, Second & Bottom): 3/16", 1/4", 5/16", 3/8", 7/16", 1/2" Dies: 1" OD - 3/16", 1/4", 5/16", 3/8", 7/16", 1/2" Accessories: Tap Wrenches - 1nos. & Die stock - 1nos."
Ref. No C52 3/16-1/2 BSF T&B (20Pc)	FBI0200029	"Taps (Taper, Second & Bottom): 3/16", 1/4", 5/16", 3/8", 7/16", 1/2" Dies: 1" OD - 3/16", 1/4", 5/16", 3/8", 7/16", 1/2" Accessories: Tap Wrenches - 1nos. & Die stock - 1nos."
Ref. No C85 1/4-1" BSW T&B (32Pc)	FBI0200030	"Taps (Taper, Second & Bottom): 1/4", 5/16", 3/8", 7/16", 1/2", 5/8", 3/4", 7/8", 1" Dies: 1" OD- 1/4", 5/16", 3/8" & 1.1/2" OD - 7/16", 1/2", 5/8" & 2" OD- 3/4", 7/8", 1" Accessories: Tap Wrenches - 2nos. & Die stock - 3nos."
Ref. No C85 1/4-1" BSF T&B (32Pc)	FBI0200031	"Taps (Taper, Second & Bottom): 1/4", 5/16", 3/8", 7/16", 1/2", 5/8", 3/4", 7/8", 1" Dies: 1" OD- 1/4", 5/16", 3/8" & 1.1/2" OD - 7/16", 1/2", 5/8" & 2" OD- 3/4", 7/8", 1" Accessories: Tap Wrenches - 2nos. & Die stock - 3nos."
Ref. No C85 1/4-1" NF T&B (32Pc)	FBI0200032	"Taps (Taper, Second & Bottom): 1/4", 5/16", 3/8", 7/16", 1/2", 5/8", 3/4", 7/8", 1" Dies: 1" OD- 1/4", 5/16", 3/8" & 1.1/2" OD - 7/16", 1/2", 5/8" & 2" OD- 3/4", 7/8", 1" Accessories: Tap Wrenches - 2nos. & Die stock - 3nos."
Ref. No C85 1/4-1" NC T&B (32Pc)	FBI0200033	"Taps (Taper, Second & Bottom): 1/4", 5/16", 3/8", 7/16", 1/2", 5/8", 3/4", 7/8", 1" Dies: 1" OD- 1/4", 5/16", 3/8" & 1.1/2" OD - 7/16", 1/2", 5/8" & 2" OD- 3/4", 7/8", 1" Accessories: Tap Wrenches - 2nos. & Die stock - 3nos."



## Carbon Steel Hand Taps



HSS TAPS

DIES

END MILLS

DRILLS

CARBIDE BURRS

CS TAPS

## ADJUSTABLE TAP WRENCHES (FORGED STEEL)

Tap Capacity		EDP No.	Overall Nominal Length	
Inch	mm		Inch	mm
1/16"- 1/4"	2 - 6	FBN2200009	6- 1/4"	172
1/8"- 1/2"	3 - 12	FBN2200010	8-1/16"	205
5/32"- 3/8"	4 - 10	FBN2200011	8-1/16"	205
3/16"- 1/2"	5 - 12	FBN2200012	10-3/16"	258
3/16"-5/8"	5 - 16	FBN2200013	10-1/4"	264
1/4"-3/4"	6 - 20	FBN2200014	13-3/4"	350
5/16"-1"	8 - 25	FBN2200015	17-1/4"	435
3/8"-1"	10 - 25	FBN2200016	17-5/16"	440
3/4"-1.1/2"	18 - 38	FBN2200017	27"	685
1"-2"	25 - 50	FBN2200018	34-1/2"	875

## T-HANDLE TAP WRENCHES

Tap Capacity		EDP No.	Overall Nominal Length	
Inch	mm		Inch	mm
1/16"-5/32"	2 - 4	FBN2200019	2-3/8"	60
5/32"-1/4"	4 - 6	FBN2200020	2-11/16"	69
3/16"-5/16"	5 - 8	FBN2200021	2-5/32"	80
1/4"-1/2"	6 - 12	FBN2200022	3-1/2"	88

## T-HANDLE TAP WRENCHES RACHET TYPE

Tap Capacity		EDP No.	Overall Nominal Length	
Inch	mm		Inch	mm
5/32"-1/4"	4 - 6	FBN2200023	2-11/16"	69
1/4"-1/2"	6 - 12	FBN2200024	3-1/2"	88
5/32"-1/4"	4 - 6	ABM000022	10-1/4"	260
1/4"-1/2"	6 - 12	ABM000023	12"	305

## DIE STOCKS

Tap Capacity		EDP No.	Overall Nominal Length	
Inch	mm		Inch	mm
13/16"	20	FBN2200001	6-3/4"	170
1"	25	FBN2200002	8-3/4"	222
1.5/16"	33	FBN2200003	10"	254
1.1/2"	38	FBN2200004	12-1/2"	317
2"	50	FBN2200005	15-9/16"	395
2.1/4"	57	FBN2200006	16.1/2"	420
2.1/2"	63	FBN2200007	19"	480
3"	75	FBN2200008	22-1/2"	572
4"	100	FBN2200028	35"	890

## CARBON STEEL TAPS NOMENCLATURE

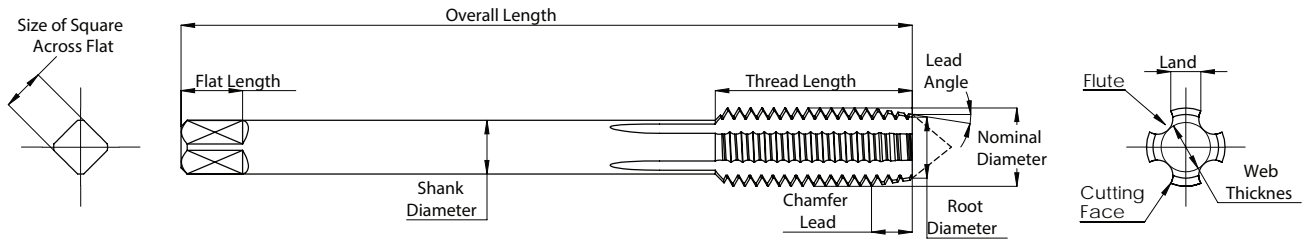

## CARBON TAPS APPLICATION

### AUTOMOBILE INDUSTRY

- Cylinder liner and Cylinder head manufacturers
- General purpose applications in small workshops, garages, tool rooms and maintenance departments
- Motor cycle body frames: Spatter cleaning and removing paint from threaded portion.
- Carburetor and speedometer manufacturers
- High Speed Steel Dies are used in removing paint from threaded portion in rear axles of cars, trucks, buses, etc.
- Dies are used by gas valve manufacturers.

### ENGINEERING INDUSTRY

- Air Compressors / Blower manufacturers
- Cooling towers and heat exchangers
- Brass component manufacturers
- Pipe and Pipe fitting manufacturers.
- Sheet Metal Industry
- Thread dressing of diesel engine components
- Steel furniture manufacturers
- Steel window manufacturers
- Bus and Truck body building workshops
- Textile industry
- Electrical industry

### HOUSEHOLD APPLIANCE MANUFACTURERS

- Pressure cookers
- Fans, Air coolers, Air conditioners
- Flour mills, Mixers and Grinders





**High Performance Cutting Tools**



## **Forbes & Company Limited**

Saki Powai Road, Chandivali,  
Mumbai 400 072, India

**Phone:** +91 22 2847 1861

**Email:** sales@forbes.co.in

**Website:** www.totem-forbes.com | www.forbes.co.in

