

HSS-E



High Performance Cutting Tools



SPIRAL FLUTE MACHINE TAPS

SPIRAL FLUTE TAPS - SB SERIES



SPIRAL FLUTE - These taps are used to produce a thread close to the bottom of a blind hole and therefore have a very short lead. The right hand spiral cut of the flutes acts to force the swarf away from the cutting teeth to the rear of the flutes and out of the hole. They are better on materials which form long continuous stringy swarf, rather than chips. They are also better to tap a thread in a hole where there is a break in the material, e.g. another hole, as the spiral fluting helps the tap to pick up on the other side. Spiral flute taps can have slow or fast helix angles.

Advantages :

- Can be used in both blind holes & also in through holes
- Chips are pushed upwards due to spiral flute – Chip clogging avoided
- Full thread depth can be achieved and this design prevents tap breakage

SELECTION GUIDE



SPIRAL FLUTE TAPS

SERIES		THREAD FORM	BLANK STANDARD	APPLICATION	CHAMFER	COATING	PAGE
SB1		M	DIN371/ DIN376	General Steel	C/2-3P	Bright	44
SB3		M	DIN371/ DIN376	General Steel	C/2-3P	TiN	45
SB4		M	DIN371/ DIN376	General Steel	C/2-3P	TiAlN	46
SBF5		M	DIN371/ DIN376	Forged Steel	C/2-3P	TiCN	47
SB1		MF	DIN374	General Steel	C/2-3P	Bright	48
SB3		MF	DIN374	General Steel	C/2-3P	TiN	49
SB4		MF	DIN374	General Steel	C/2-3P	TiAlN	50
SBF5		MF	DIN374	Forged Steel	C/2-3P	TiCN	51
SB1		UNC	DIN371/ DIN376	General Steel	C/2-3P	Bright	52
SB3		UNC	DIN371/ DIN376	General Steel	C/2-3P	TiN	53
SB1		UNF	DIN374	General Steel	C/2-3P	Bright	54
SB3		UNF	DIN374	General Steel	C/2-3P	TiN	55
SB1		M	ISO	General Steel	C/2-3P	Bright	56
SB3		M	ISO	General Steel	C/2-3P	TiN	57
SB4		M	ISO	General Steel	C/2-3P	TiAlN	58
SBF5		M	ISO	Forged Steel	C/2-3P	TiCN	59
SBS4		M	ISO	Stainless Steel	C/2-3P	TiAlN	60
SBS5		M	ISO	Stainless Steel	C/2-3P	TiCN	61
SB1		MF	ISO	General Steel	C/2-3P	Bright	62
SB3		MF	ISO	General Steel	C/2-3P	TiN	63
SB4		MF	ISO	General Steel	C/2-3P	TiAlN	64
SBF5		MF	ISO	Forged Steel	C/2-3P	TiCN	65
SB1L		M	ISO Long Shank	General Steel	C/2-3P	Bright	66
SB3L		M	ISO Long Shank	General Steel	C/2-3P	TiN	67
SB1		UNC	ISO	General Steel	C/2-3P	Bright	68
SB3		UNC	ISO	General Steel	C/2-3P	TiN	69
SB1		UNF	ISO	General Steel	C/2-3P	Bright	70
SB3		UNF	ISO	General Steel	C/2-3P	TiN	71



Spiral Flute Machine Taps

SB1 Series

M

Metric coarse threads

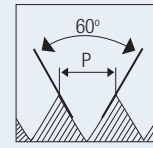

HOLE TYPE



HSS-E

DIN
371/376

6HX



BF

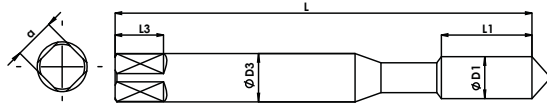

Reinforced Shank DIN371 (M3 - M10)

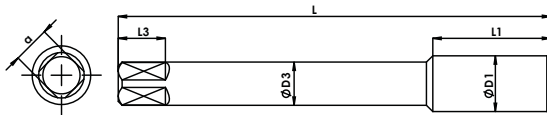

Reduced Shank DIN376 (M12 - M20)

P0-P1

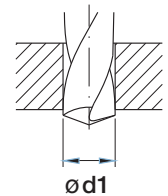

Unit : mm

Nominal Diameter	Pitch	EDP No.	Overall Length	Thread Length	Shank Diameter	Square Size	Square Length	Tapping Drill Diameter
ØD1	p		L	L1	ØD3	a	L3	Ød1
M 3	0.5	FAB0203197	56	6	3.5	2.7	6	2.5
M 3.5	0.6	FAB0204328	56	7	4	3	6	2.9
M 4	0.7	FAB0203198	63	8	4.5	3.4	6	3.3
M 5	0.8	FAB0203199	70	8	6	4.9	8	4.2
M 6	1	FAB0203200	80	10	6	4.9	8	5
M 7	1	FAB0203201	80	10	7	5.5	8	6
M 8	1.25	FAB0203202	90	13	8	6.2	9	6.8
M 10	1.5	FAB0203203	100	15	10	8	11	8.5
M 12	1.75	FAB0203204	110	18	9	7	10	10.2
M 14	2	FAB0203205	110	20	11	9	12	12
M 16	2	FAB0203206	110	20	12	9	12	14
M 18	2.5	FAB0204329	125	25	14	11	14	15.5
M 20	2.5	FAB0204330	140	25	16	12	15	17.5



Spiral Flute Machine Taps

SB3 Series



Metric coarse threads

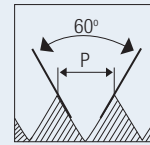

HOLE TYPE



HSS-E

DIN 371/376

6HX

C/2-3P

35°

TiN

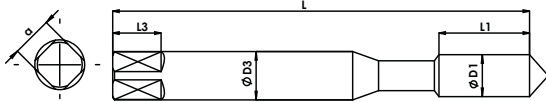

Reinforced Shank DIN371 (M3 - M10)



P0-P2

K1-K2

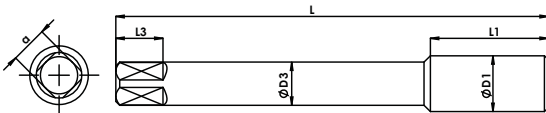

Reduced Shank DIN376 (M12 - M20)

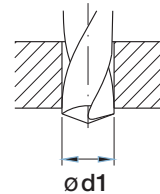

Unit : mm

Nominal Diameter	Pitch	EDP No.	Overall Length	Thread Length	Shank Diameter	Square Size	Square Length	Tapping Drill Diameter
ØD1	p		L	L1	ØD3	a	L3	Ød1
M 3	0.5	FAB0203207	56	6	3.5	2.7	6	2.5
M 3.5	0.6	FAB0204331	56	7	4	3	6	2.9
M 4	0.7	FAB0203208	63	8	4.5	3.4	6	3.3
M 5	0.8	FAB0203209	70	8	6	4.9	8	4.2
M 6	1	FAB0203210	80	10	6	4.9	8	5
M 7	1	FAB0203211	80	10	7	5.5	8	6
M 8	1.25	FAB0203212	90	13	8	6.2	9	6.8
M 10	1.5	FAB0203213	100	15	10	8	11	8.5
M 12	1.75	FAB0203684	110	18	9	7	10	10.2
M 14	2	FAB0203215	110	20	11	9	12	12
M 16	2	FAB0203216	110	20	12	9	12	14
M 18	2.5	FAB0204332	125	25	14	11	14	15.5
M 20	2.5	FAB0204333	140	25	16	12	15	17.5

HSS TAPS

DIES

END MILLS

DRILLS

CARBIDE BURRS

CS TAPS



Spiral Flute Machine Taps

SB4 Series

M

Metric coarse threads

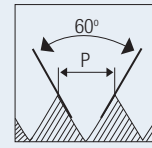

HOLE TYPE



HSS-E

DIN
371/376

6HX

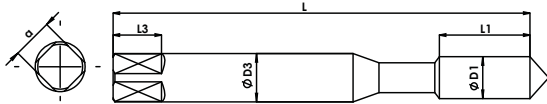

Reinforced Shank DIN371 (M3 - M10)

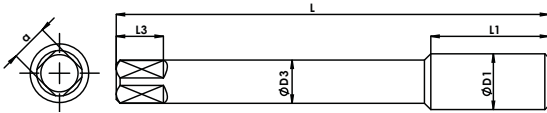

Reduced Shank DIN376 (M12 - M20)

P0-P2

K1-K3

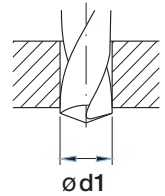

Unit : mm

Nominal Diameter	Pitch	EDP No.	Overall Length	Thread Length	Shank Diameter	Square Size	Square Length	Tapping Drill Diameter
ØD1	p		L	L1	ØD3	a	L3	Ød1
M 3	0.5	FAB0204334	56	6	3.5	2.7	6	2.5
M 3.5	0.6	FAB0204335	56	7	4	3	6	2.9
M 4	0.7	FAB0200968	63	8	4.5	3.4	6	3.3
M 5	0.8	FAB0203685	70	8	6	4.9	8	4.2
M 6	1	FAB0203686	80	10	6	4.9	8	5
M 7	1	FAB0204336	80	10	7	5.5	8	6
M 8	1.25	FAB0203687	90	13	8	6.2	9	6.8
M 10	1.5	FAB0203688	100	15	10	8	11	8.5
M 12	1.75	FAB0203689	110	18	9	7	10	10.2
M 14	2	FAB0204337	110	20	11	9	12	12
M 16	2	FAB0204338	110	20	12	9	12	14
M 18	2.5	FAB0204339	125	25	14	11	14	15.5
M 20	2.5	FAB0204340	140	25	16	12	15	17.5



Spiral Flute Machine Taps

SBF5 Series



Metric coarse threads

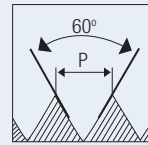

HOLE TYPE



HSS-E

DIN 371/376

6HX

C/2-3P

TiCN

P2-P3

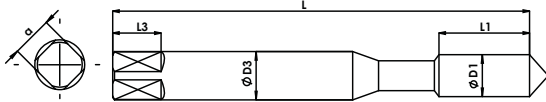

Reinforced Shank DIN371 (M3 - M10)

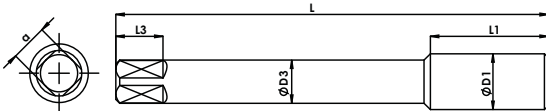

Reduced Shank DIN376 (M12 - M20)

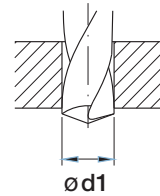

Unit : mm

Nominal Diameter	Pitch	EDP No.	Overall Length	Thread Length	Shank Diameter	Square Size	Square Length	Tapping Drill Diameter
ØD1	p		L	L1	ØD3	a	L3	Ød1
M 3	0.5	FAB0204341	56	6	3.5	2.7	6	2.5
M 3.5	0.6	FAB0204342	56	7	4	3	6	2.9
M 4	0.7	FAB0204343	63	8	4.5	3.4	6	3.3
M 5	0.8	FAB0204344	70	8	6	4.9	8	4.2
M 6	1	FAB0204345	80	10	6	4.9	8	5
M 7	1	FAB0204346	80	10	7	5.5	8	6
M 8	1.25	FAB0204347	90	13	8	6.2	9	6.8
M 10	1.5	FAB0204348	100	15	10	8	11	8.5
M 12	1.75	FAB0204349	110	18	9	7	10	10.2
M 14	2	FAB0204350	110	20	11	9	12	12
M 16	2	FAB0204351	110	20	12	9	12	14
M 18	2.5	FAB0204352	125	25	14	11	14	15.5
M 20	2.5	FAB0204353	140	25	16	12	15	17.5

HSS TAPS

DIES

END MILLS

DRILLS

CARBIDE BURRS

CS TAPS



Spiral Flute Machine Taps

SB1 Series

MF

Metric fine threads

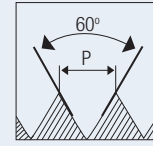

HOLE TYPE



HSS-E

DIN
374

6HX



BF

P1-P1

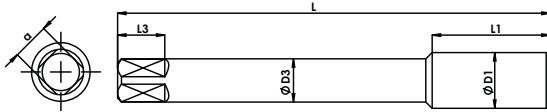

Male centre (M6 - M10)
Female centre (M12 - M20)

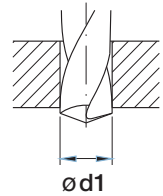

Unit : mm

Nominal Diameter	Pitch	EDP No.	Overall Length	Thread Length	Shank Diameter	Square Size	Square Length	Tapping Drill Diameter
ØD1	p		L	L1	ØD3	a	L3	Ød1
M 6	0.75	FAB0204354	80	8	4.5	3.4	6	5.2
M 8	1	FAB0204355	90	11	6	4.9	8	7
M 10	1.25	FAB0204356	100	13	7	5.5	8	8.8
M 10	1	FAB0204357	90	13	7	5.5	8	9
M 12	1.5	FAB0204358	100	15	9	7	10	10.5
M 12	1.25	FAB0204359	100	15	9	7	10	10.8
M 14	1.5	FAB0204360	100	15	11	9	12	12.5
M 14	1	FAB0204361	100	15	11	9	12	13
M 16	1.5	FAB0204362	100	15	12	9	12	14.5
M 18	1.5	FAB0204363	110	15	14	11	14	16.5
M 20	1.5	FAB0204364	125	15	16	12	15	18.5



Spiral Flute Machine Taps

SB3 Series

MF

Metric fine threads

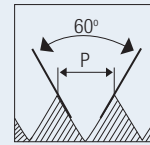

HOLE TYPE



HSS-E

DIN 374

6HX

C/2-3P

35°

TiN

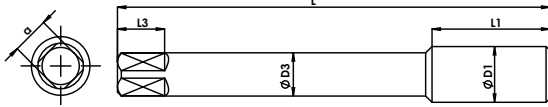

Male centre (M6 - M10)
Female centre (M12 - M20)

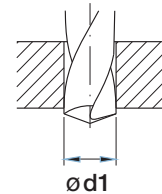

P1-P2

K1-K2

Unit : mm

Nominal Diameter	Pitch	EDP No.	Overall Length	Thread Length	Shank Diameter	Square Size	Square Length	Tapping Drill Diameter
ØD1	p		L	L1	ØD3	a	L3	Ød1
M 6	0.75	FAB0204365	80	8	4.5	3.4	6	5.2
M 8	1	FAB0203297	90	11	6	4.9	8	7
M 10	1.25	FAB0204366	100	13	7	5.5	8	8.8
M 10	1	FAB0204367	90	13	7	5.5	8	9
M 12	1.5	FAB0204368	100	15	9	7	10	10.5
M 12	1.25	FAB0204369	100	15	9	7	10	10.8
M 14	1.5	FAB0204370	100	15	11	9	12	12.5
M 14	1	FAB0204371	100	15	11	9	12	13
M 16	1.5	FAB0204372	100	15	12	9	12	14.5
M 18	1.5	FAB0204373	110	15	14	11	14	16.5
M 20	1.5	FAB0204374	125	15	16	12	15	18.5

HSS TAPS

DIES

END MILLS

DRILLS

CARBIDE BURRS

CS TAPS



Spiral Flute Machine Taps

SB4 Series

MF

Metric fine threads

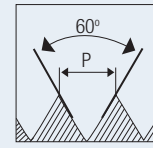

HOLE TYPE



HSS-E

DIN
374

6HX

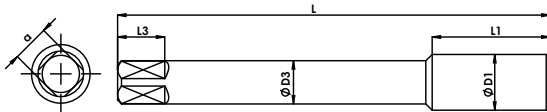

Male centre (M6 - M10)
Female centre (M12 - M20)

P0-P2

K1-K3

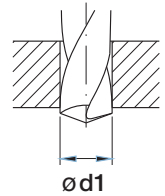

Unit : mm

Nominal Diameter	Pitch	EDP No.	Overall Length	Thread Length	Shank Diameter	Square Size	Square Length	Tapping Drill Diameter
ØD1	p		L	L1	ØD3	a	L3	Ød1
M 6	0.75	FAB0204375	80	8	4.5	3.4	6	5.2
M 8	1	FAB0204376	90	11	6	4.9	8	7
M 10	1.25	FAB0204377	100	13	7	5.5	8	8.8
M 10	1	FAB0204378	90	13	7	5.5	8	9
M 12	1.5	FAB0204379	100	15	9	7	10	10.5
M 12	1.25	FAB0204380	100	15	9	7	10	10.8
M 14	1.5	FAB0204381	100	15	11	9	12	12.5
M 14	1	FAB0204382	100	15	11	9	12	13
M 16	1.5	FAB0204383	100	15	12	9	12	14.5
M 18	1.5	FAB0204384	110	15	14	11	14	16.5
M 20	1.5	FAB0204385	125	15	16	12	15	18.5



Spiral Flute Machine Taps

SBF5 Series



Metric fine threads

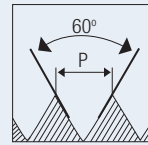

HOLE TYPE



HSS-E

DIN 374

6HX

C/2-3P

TiCN

P2-P3

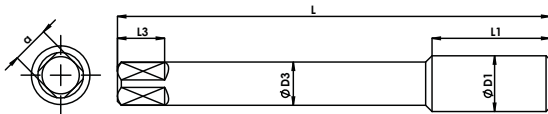

Male centre (M6 - M10)
Female centre (M12 - M20)

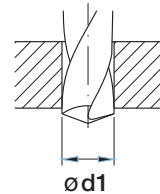

Unit : mm

Nominal Diameter	Pitch	EDP No.	Overall Length	Thread Length	Shank Diameter	Square Size	Square Length	Tapping Drill Diameter
ØD1	p		L	L1	ØD3	a	L3	Ød1
M 6	0.75	FAB0204386	80	8	4.5	3.4	6	5.2
M 8	1	FAB0204387	90	11	6	4.9	8	7
M 10	1.25	FAB0204388	100	13	7	5.5	8	8.8
M 10	1	FAB0204389	90	13	7	5.5	8	9
M 12	1.5	FAB0204390	100	15	9	7	10	10.5
M 12	1.25	FAB0204391	100	15	9	7	10	10.8
M 14	1.5	FAB0204392	100	15	11	9	12	12.5
M 14	1	FAB0204393	100	15	11	9	12	13
M 16	1.5	FAB0204394	100	15	12	9	12	14.5
M 18	1.5	FAB0204395	110	15	14	11	14	16.5
M 20	1.5	FAB0204396	125	15	16	12	15	18.5

HSS TAPS

DIES

END MILLS

DRILLS

CARBIDE BURRS

CS TAPS



Spiral Flute Machine Taps

SB1 Series

UNC

Unified coarse threads

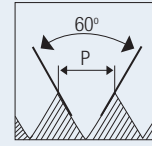

HOLE TYPE



HSS-E

DIN
371/376

2B



BF

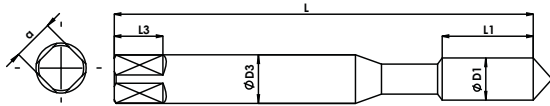

Reinforced Shank DIN371 (1/4" - 3/8")

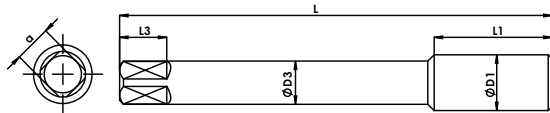

Reduced Shank (7/16" - 1")

P0-P1

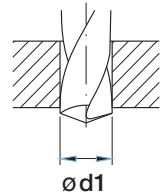

Unit : mm

Nominal Diameter	TPI	EDP No.	Overall Length	Thread Length	Shank Diameter	Square Size	Square Length	Tapping Drill Diameter
ØD1			L	L1	ØD3	a	L3	Ød1
1/4"	20	FAB0204397	80	13	7	5.5	8	5.2
5/16"	18	FAB0204398	90	14	8	6.2	9	6.6
3/8"	16	FAB0204399	100	16	9	7	10	8
7/16"	14	FAB0204400	100	19	8	6.2	9	9.4
1/2"	13	FAB0204401	110	20	9	7	10	10.80
5/8"	11	FAB0204402	110	24.20	12	9	12	13.5
3/4"	10	FAB0204403	125	25	14	11	14	16.5
7/8"	9	FAB0204404	140	25	18	14.5	17	19.5
1"	8	FAB0204405	160	30	18	14.5	17	22.25



Spiral Flute Machine Taps

SB3 Series

UNC

Unified coarse threads

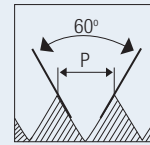

HOLE TYPE



HSS-E
DIN 371/376
2B
C/2-3P
35°
TiN

HSS TAPS

DIES

END MILLS

DRILLS

CARBIDE BURRS

CS TAPS

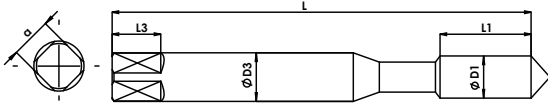

Reinforced Shank DIN371 (1/4" - 3/8")

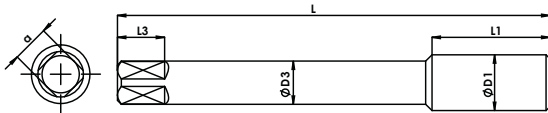

Reduced Shank DIN376 (7/16" - 1")

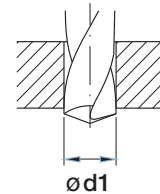

P0-P2

K1-K2

Unit : mm

Nominal Diameter	TPI	EDP No.	Overall Length	Thread Length	Shank Diameter	Square Size	Square Length	Tapping Drill Diameter
ØD1			L	L1	ØD3	a	L3	Ød1
1/4"	20	FAB0204406	80	13	7	5.5	8	5.2
5/16"	18	FAB0204407	90	14	8	6.2	9	6.6
3/8"	16	FAB0204408	100	16	9	7	10	8
7/16"	14	FAB0204409	100	19	8	6.2	9	9.4
1/2"	13	FAB0204410	110	20	9	7	10	10.80
5/8"	11	FAB0204411	110	24.20	12	9	12	13.5
3/4"	10	FAB0204412	125	25	14	11	14	16.5
7/8"	9	FAB0204413	140	25	18	14.5	17	19.5
1"	8	FAB0204414	160	30	18	14.5	17	22.25



Spiral Flute Machine Taps

SB1 Series

UNF

Unified fine threads

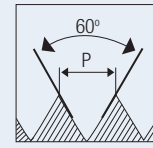

HOLE TYPE



HSS-E

DIN
374

6HX



35°

BF

P0-P1

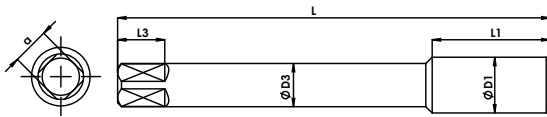

Male centre (1/4" - 3/8")
Female centre (7/16" - 1")

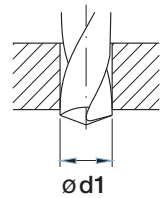

Unit : mm

Nominal Diameter	TPI	EDP No.	Overall Length	Thread Length	Shank Diameter	Square Size	Square Length	Tapping Drill Diameter
ØD1			L	L1	ØD3	a	L3	Ød1
1/4"	28	FAB0204415	80	10	7	5.5	8	5.5
5/16"	24	FAB0204416	90	10	8	6.2	9	6.9
3/8"	24	FAB0204417	100	10	9	7	10	8.5
7/16"	20	FAB0204418	100	13	8	6.2	9	9.9
1/2"	20	FAB0204419	100	13	9	7	10	11.5
5/8"	18	FAB0204420	100	16	12	9	12	14.5
3/4"	16	FAB0204421	110	16	14	11	14	17.5
7/8"	14	FAB0204422	125	18	18	14.5	17	20.5
1"	12	FAB0204423	140	22	18	14.5	17	23.25



Spiral Flute Machine Taps

SB3 Series

UNF

Unified fine threads

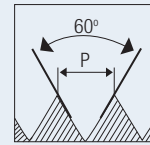

HOLE TYPE



HSS-E
DIN 374
2B
C/2-3P
35°
TiN

P0-P2

K1-K2

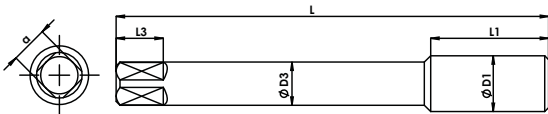

Male centre (1/4" - 3/8")
Female centre (7/16" - 1")

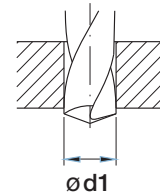

Unit : mm

Nominal Diameter	TPI	EDP No.	Overall Length	Thread Length	Shank Diameter	Square Size	Square Length	Tapping Drill Diameter
ØD1			L	L1	ØD3	a	L3	Ød1
1/4"	28	FAB0204424	80	10	7	5.5	8	5.5
5/16"	24	FAB0204425	90	10	8	6.2	9	6.9
3/8"	24	FAB0204426	100	10	9	7	10	8.5
7/16"	20	FAB0204427	100	13	8	6.2	9	9.9
1/2"	20	FAB0204428	100	13	9	7	10	11.5
5/8"	18	FAB0204429	100	16	12	9	12	14.5
3/4"	16	FAB0204430	110	16	14	11	14	17.5
7/8"	14	FAB0204431	125	18	18	14.5	17	20.5
1"	12	FAB0204432	140	22	18	14.5	17	23.25

HSS TAPS

DIES

END MILLS

DRILLS

CARBIDE BURRS

CS TAPS



Spiral Flute Machine Taps

SB1 Series

M

Metric coarse threads

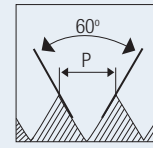

HOLE TYPE



HSS-E

ISO
529

6HX

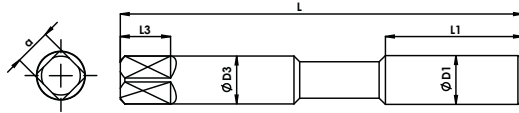
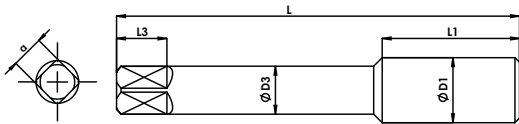

BF

Reinforced Shank (M3 - M10)
Male centre upto M5

Reduced Shank (M12 - M20)

P0-P1

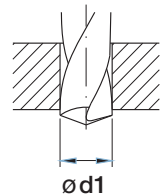

Unit : mm

Nominal Diameter	Pitch	EDP No.	Overall Length	Thread Length	Shank Diameter	Square Size	Square Length	Tapping Drill Diameter
ØD1	p		L	L1	ØD3	a	L3	Ød1
M 3	0.5	FAB0200649	48	5	3.15	2.5	5	2.5
M 3.5	0.6	FAB0203134	50	6	3.55	2.8	5	2.9
M 4	0.7	FAB0200663	53	7	4	3.15	6	3.3
M 5	0.8	FAB0200674	58	8	5	4	7	4.2
M 6	1	FAB0200686	66	10	6.3	5	8	5
M 7	1	FAB0203135	66	10	7.1	5.6	8	6
M 8	1.25	FAB0200698	72	13	8	6.3	9	6.8
M 10	1.5	FAB0200722	80	15	10	8	11	8.5
M 12	1.75	FAB0200752	89	18	9	7.1	10	10.2
M 14	2	FAB0200781	95	20	11.2	9	12	12
M 16	2	FAB0200802	102	20	12.5	10	13	14
M 18	2.5	FAB0203139	112	25	14	11.2	14	15.5
M 20	2.5	FAB0203141	112	25	14	11.2	14	17.5



Spiral Flute Machine Taps

SB3 Series



Metric coarse threads

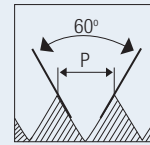

HOLE TYPE



HSS-E

ISO 529

6HX

C/2-3P

35°

TiN

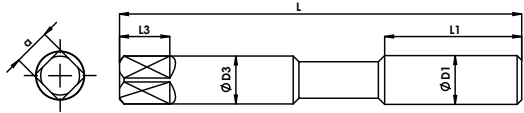

Reinforced Shank (M3 - M10)
Male centre upto M5

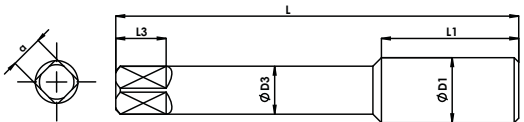

Reduced Shank (M12 - M20)

P0-P2

K1-K2

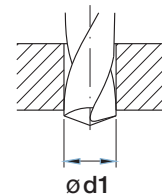

Unit : mm

Nominal Diameter	Pitch	EDP No.	Overall Length	Thread Length	Shank Diameter	Square Size	Square Length	Tapping Drill Diameter
ØD1	p		L	L1	ØD3	a	L3	Ød1
M 3	0.5	FAB0200650	48	5	3.15	2.5	5	2.5
M 3.5	0.6	FAB0203142	50	6	3.55	2.8	5	2.9
M 4	0.7	FAB0200665	53	7	4	3.15	6	3.3
M 5	0.8	FAB0200676	58	8	5	4	7	4.2
M 6	1	FAB0200688	66	10	6.3	5	8	5
M 7	1	FAB0203143	66	10	7.1	5.6	8	6
M 8	1.25	FAB0200700	72	13	8	6.3	9	6.8
M 10	1.5	FAB0200724	80	15	10	8	11	8.5
M 12	1.75	FAB0200754	89	18	9	7.1	10	10.2
M 14	2	FAB0200782	95	20	11.2	9	12	12
M 16	2	FAB0200804	102	20	12.5	10	13	14
M 18	2.5	FAB0202155	112	25	14	11.2	14	15.5
M 20	2.5	FAB0200812	112	25	14	11.2	14	17.5

HSS TAPS

DIES

END MILLS

DRILLS

CARBIDE BURRS

CS TAPS



M

Metric coarse threads

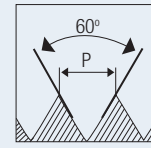

HOLE TYPE



HSS-E

ISO
529

6HX

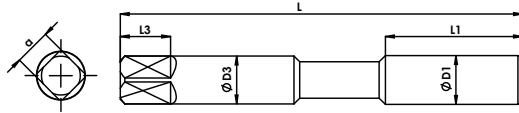
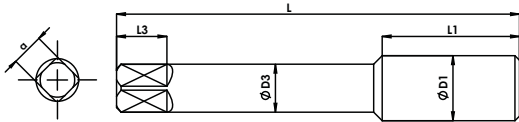
Reinforced Shank (M3 - M10)
Male centre upto M5

Reduced Shank (M12 - M20)

P0-P2

K1-K3

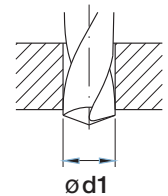

Unit : mm

Nominal Diameter	Pitch	EDP No.	Overall Length	Thread Length	Shank Diameter	Square Size	Square Length	Tapping Drill Diameter
ØD1	p		L	L1	ØD3	a	L3	Ø d1
M 3	0.5	FAB0203145	48	5	3.15	2.5	5	2.5
M 3.5	0.6	FAB0203146	50	6	3.55	2.8	5	2.9
M 4	0.7	FAB0200666	53	7	4	3.15	6	3.3
M 5	0.8	FAB0200677	58	8	5	4	7	4.2
M 6	1	FAB0200689	66	10	6.3	5	8	5
M 7	1	FAB0203147	66	10	7.1	5.6	8	6
M 8	1.25	FAB0200701	72	13	8	6.3	9	6.8
M 10	1.5	FAB0200725	80	15	10	8	11	8.5
M 12	1.75	FAB0200755	89	18	9	7.1	10	10.2
M 14	2	FAB0203152	95	20	11.2	9	12	12
M 16	2	FAB0203153	102	20	12.5	10	13	14
M 18	2.5	FAB0203155	112	25	14	11.2	14	15.5
M 20	2.5	FAB0203157	112	25	14	11.2	14	17.5



Spiral Flute Machine Taps

SBF5 Series



Metric coarse threads

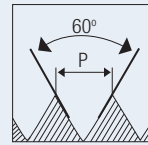

HOLE TYPE



HSS TAPS

DIES

END MILLS

DRILLS

CARBIDE BURRS

CS TAPS

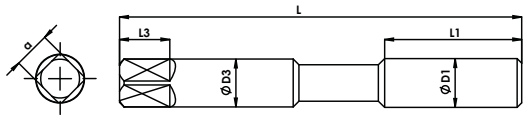

Reinforced Shank (M3 - M10)
Male centre upto M 5

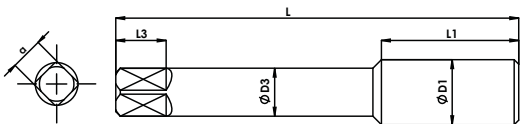

Reduced Shank (M12 - M20)

P3-P4

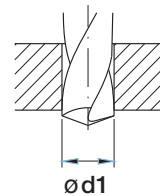

Unit : mm

Nominal Diameter	Pitch	EDP No.	Overall Length	Thread Length	Shank Diameter	Square Size	Square Length	Tapping Drill Diameter
ØD1	p		L	L1	ØD3	a	L3	Ø d1
M 3	0.5	FAB0203158	48	5	3.15	2.5	5	2.5
M 4	0.7	FAB0203159	53	7	4	3.15	6	3.3
M 5	0.8	FAB0203160	58	8	5	4	7	4.2
M 6	1	FAB0203161	66	10	6.3	5	8	5
M 8	1.25	FAB0203163	72	13	8	6.3	9	6.8
M 10	1.5	FAB0203166	80	15	10	8	11	8.5
M 12	1.75	FAB0203169	89	18	9	7.1	10	10.2
M 14	2	FAB0203171	95	20	11.2	9	12	12
M 16	2	FAB0203173	102	20	12.5	10	13	14
M 20	2.5	FAB0203176	112	25	14	11.2	14	17.5



Spiral Flute Machine Taps

SBS4 Series

M

Metric coarse threads

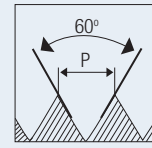

HOLE TYPE



HSS-E

ISO
529

6HX

C/2-3P

TiAIN

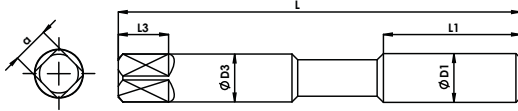
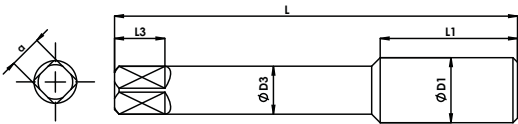
Reinforced Shank (M3 - M10)
Male centre upto M5

Reduced Shank (M12 - M20)

M1-M3

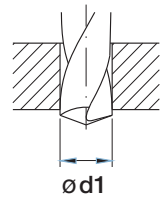

Unit : mm

Nominal Diameter	Pitch	EDP No.	Overall Length	Thread Length	Shank Diameter	Square Size	Square Length	Tapping Drill Diameter
ØD1	p		L	L1	ØD3	a	L3	Ø d1
M 3	0.5	FAB0203177	48	5	3.15	2.5	5	2.5
M 4	0.7	FAB0203178	53	7	4	3.15	6	3.3
M 5	0.8	FAB0203179	58	8	5	4	7	4.2
M 6	1	FAB0203180	66	10	6.3	5	8	5
M 8	1.25	FAB0203181	72	13	8	6.3	9	6.8
M 10	1.5	FAB0203182	80	15	10	8	11	8.5
M 12	1.75	FAB0203183	89	18	9	7.1	10	10.2
M 14	2	FAB0203184	95	20	11.2	9	12	12
M 16	2	FAB0203185	102	20	12.5	10	13	14
M 20	2.5	FAB0203186	112	25	14	11.2	14	17.5



Spiral Flute Machine Taps

SBS5 Series



Metric coarse threads

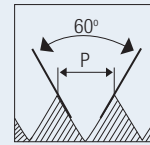

HOLE TYPE



HSS-E

ISO 529

6HX

C/2-3P

TiCN

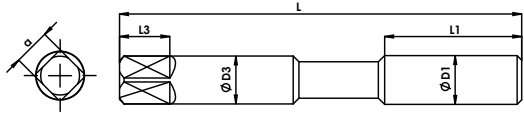

Reinforced Shank (M3 - M10)
Male centre upto M5

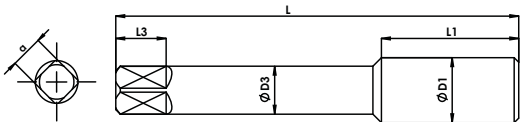

Reduced Shank (M12 - M20)

M1-M3

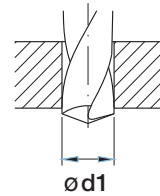

Unit : mm

Nominal Diameter	Pitch	EDP No.	Overall Length	Thread Length	Shank Diameter	Square Size	Square Length	Tapping Drill Diameter
ØD1	p		L	L1	ØD3	a	L3	Ød1
M 3	0.5	FAB0203187	48	5	3.15	2.5	5	2.5
M 4	0.7	FAB0203188	53	7	4	3.15	6	3.3
M 5	0.8	FAB0203189	58	8	5	4	7	4.2
M 6	1	FAB0203190	66	10	6.3	5	8	5
M 8	1.25	FAB0203191	72	13	8	6.3	9	6.8
M 10	1.5	FAB0203192	80	15	10	8	11	8.5
M 12	1.75	FAB0203193	89	18	9	7.1	10	10.2
M 14	2	FAB0203194	95	20	11.2	9	12	12
M 16	2	FAB0203195	102	20	12.5	10	13	14
M 20	2.5	FAB0203196	112	25	14	11.2	14	17.5

HSS TAPS

DIES

END MILLS

DRILLS

CARBIDE BURRS

CS TAPS



Spiral Flute Machine Taps

SB1 Series

MF

Metric fine threads

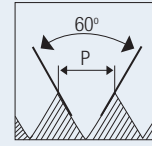

HOLE TYPE



HSS-E

ISO
529

6HX



BF

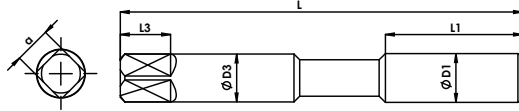

Reinforced Shank (M8 - M10)

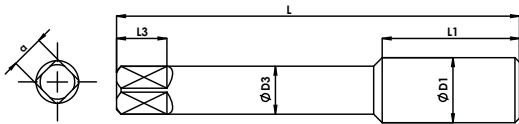

Reduced Shank (M12 - M20)

P0-P1

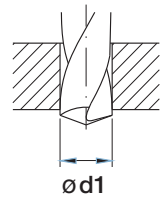

Unit : mm

Nominal Diameter	Pitch	EDP No.	Overall Length	Thread Length	Shank Diameter	Square Size	Square Length	Tapping Drill Diameter
ØD1	p		L	L1	ØD3	a	L3	Ød1
M 8	1	FAB0203136	72	13	8	6.3	9	7
M 10	1	FAB0203137	80	15	10	8	11	9
M 10	1.25	FAB0200711	80	15	10	8	11	8.8
M 12	1.5	FAB0200741	89	18	9	7.1	10	10.5
M 14	1.5	FAB0200772	95	20	11.2	9	12	12.5
M 16	1.5	FAB0200791	102	20	12.5	10	13	14.5
M 18	1.5	FAB0203138	112	25	14	11.2	14	16.5
M 20	1.5	FAB0203140	112	25	14	11.2	14	18.5



Spiral Flute Machine Taps

SB3 Series



Metric fine threads

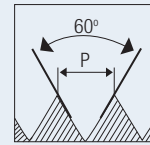

HOLE TYPE



HSS-E
ISO 529
6HX
C/2-3P
35°
TiN

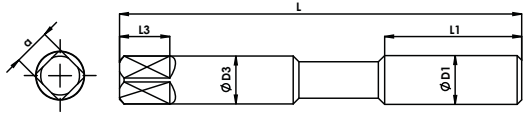

Reinforced Shank (M8 - M10)



P0-P2

K1-K2

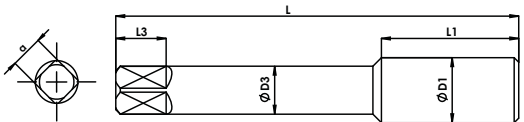

Reduced Shank (M12 - M20)

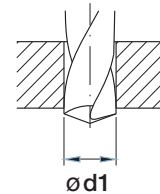

Unit : mm

Nominal Diameter	Pitch	EDP No.	Overall Length	Thread Length	Shank Diameter	Square Size	Square Length	Tapping Drill Diameter
ØD1	p		L	L1	ØD3	a	L3	Ød1
M 8	1	FAB0202157	72	13	8	6.3	9	7
M 10	1	FAB0200703	80	15	10	8	11	9
M 10	1.25	FAB0200713	80	15	10	8	11	8.8
M 12	1.5	FAB0200743	89	18	9	7.1	10	10.5
M 14	1.5	FAB0200774	95	20	11.2	9	12	12.5
M 16	1.5	FAB0200793	102	20	12.5	10	13	14.5
M 18	1.5	FAB0203144	112	25	14	11.2	14	16.5
M 20	1.5	FAB0200808	112	25	14	11.2	14	18.5

HSS TAPS

DIES

END MILLS

DRILLS

CARBIDE BURRS

CS TAPS



MF

Metric fine threads

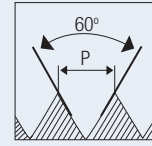

HOLE TYPE



HSS-E

ISO
529

6HX

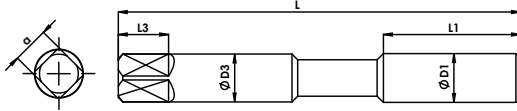

Reinforced Shank (M3 - M10)

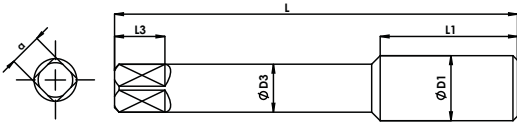

Reduced Shank (M12 - M20)

P0-P2

K1-K3

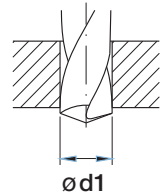

Unit : mm

Nominal Diameter	Pitch	EDP No.	Overall Length	Thread Length	Shank Diameter	Square Size	Square Length	Tapping Drill Diameter
ØD1	p		L	L1	ØD3	a	L3	Ød1
M 8	1	FAB0203148	72	13	8	6.3	9	7
M 10	1	FAB0203149	80	15	10	8	11	9
M 10	1.25	FAB0203150	80	15	10	8	11	8.8
M 12	1.5	FAB0200744	89	18	9	7.1	10	10.5
M 14	1.5	FAB0203151	95	20	11.2	9	12	12.5
M 16	1.5	FAB0200794	102	20	12.5	10	13	14.5
M 18	1.5	FAB0203154	112	25	14	11.2	14	16.5
M 20	1.5	FAB0203156	112	25	14	11.2	14	18.5



Spiral Flute Machine Taps

SBF5 Series

MF

Metric fine threads

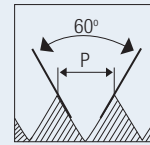

HOLE TYPE



P2-P3

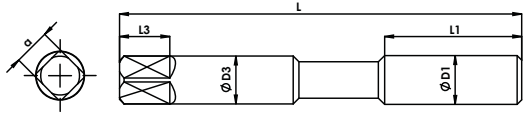

Reinforced Shank (M8 - M10)

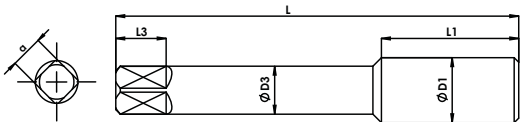

Reduced Shank (M12 - M20)

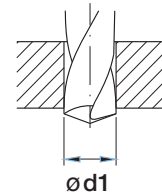

Unit : mm

Nominal Diameter	Pitch	EDP No.	Overall Length	Thread Length	Shank Diameter	Square Size	Square Length	Tapping Drill Diameter
ØD1	p		L	L1	ØD3	a	L3	Ød1
M 8	1	FAB0203162	72	13	8	6.3	9	7
M 10	1	FAB0203164	80	15	10	8	11	9
M 10	1.25	FAB0203165	80	15	10	8	11	8.8
M 12	1.5	FAB0203167	89	18	9	7.1	10	10.5
M 14	1.5	FAB0203169	95	20	11.2	9	12	12.5
M 16	1.5	FAB0203171	102	20	12.5	10	13	14.5
M 18	1.5	FAB0203173	112	25	14	11.2	14	16.5
M 20	1.5	FAB0203175	112	25	14	11.2	14	18.5

HSS TAPS

DIES

END MILLS

DRILLS

CARBIDE BURRS

CS TAPS



Spiral Flute Machine Taps

SB1L Series

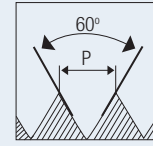
M/MF**Metric coarse & fine threads - long shank**

HOLE TYPE



HSS-E

ISO 529

6HX



BF

P0-P1

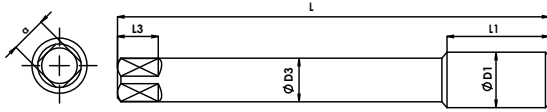

Male Centre (M4 - M5)
Female Centre (M6 - M16)

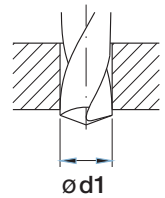

Unit : mm

Nominal Diameter	Pitch	EDP No.	Overall Length	Thread Length	Shank Diameter	Square Size	Square Length	Tapping Drill Diameter
ØD1	p		L	L1	ØD3	a	L3	Ød1
M 4	0.7	FAB0203270	73	7	3.15	2.5	5	3.3
M 5	0.8	FAB0200825	79	8	4	3.15	6	4.2
M 6	1	FAB0200836	89	10	6.34	3.55	6	5
M 8	1.25	FAB0200846	97	13	6.34	5	8	6.8
M 10	1.5	FAB0200857	108	15	8	6.3	9	8.5
M 12	1.5	FAB0200868	119	15	9	7.1	10	10.5
M 12	1.75	FAB0200879	119	18	9	7.1	10	10.3
M 14	1.5	FAB0200889	127	15	11.2	9	12	12.5
M 14	2	FAB0203271	127	20	11.2	9	12	12
M 16	1.5	FAB0203272	137	15	12.5	10	13	14.5
M 16	2	FAB0203273	137	20	12.5	10	13	14



Spiral Flute Machine Taps

SB3L Series

M/MF

Metric coarse & fine threads - long shank

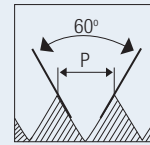

HOLE TYPE



HSS-E

ISO 529

6HX

C/2-3P

35°

TiN

P0-P2

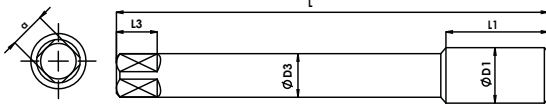

Male Centre (M4 - M5)
Female Centre (M6 - M16)

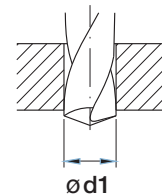

Unit : mm

Nominal Diameter	Pitch	EDP No.	Overall Length	Thread Length	Shank Diameter	Square Size	Square Length	Tapping Drill Diameter
ØD1	p		L	L1	ØD3	a	L3	Ød1
M 4	0.7	FAB0203274	73	7	3.15	2.5	5	3.3
M 5	0.8	FAB0200827	79	8	4	3.15	6	4.2
M 6	1	FAB0200838	89	10	6.34	3.55	6	5
M 8	1.25	FAB0200848	97	13	6.34	5	8	6.8
M 10	1.5	FAB0200859	108	15	8	6.3	9	8.5
M 12	1.5	FAB0200870	119	15	9	7.1	10	10.5
M 12	1.75	FAB0200881	119	18	9	7.1	10	10.3
M 14	1.5	FAB0200891	127	15	11.2	9	12	12.5
M 14	2	FAB0203275	127	20	11.2	9	12	12
M 16	1.5	FAB0203276	137	15	12.5	10	13	14.5
M 16	2	FAB0203277	137	20	12.5	10	13	14

HSS TAPS

DIES

END MILLS

DRILLS

CARBIDE BURRS

CS TAPS



Spiral Flute Machine Taps

SB1 Series

UNC

Unified coarse threads

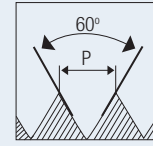

HOLE TYPE



HSS-E

ISO
529

2B



BF

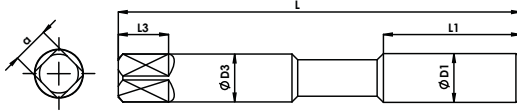

Reinforced Shank (1/4" - 3/8")

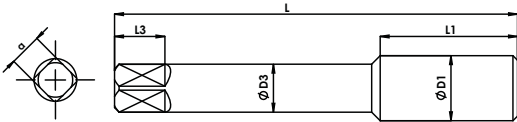

Reduced Shank (7/16" - 3/4")

P0-P1

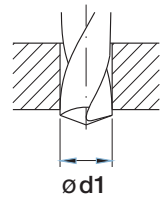

Unit : mm

Nominal Diameter	TPI	EDP No.	Overall Length	Thread Length	Shank Diameter	Square Size	Square Length	Tapping Drill Diameter
ØD1			L	L1	ØD3	a	L3	Ød1
1/4"	20	FAB0200576	66	10	6.3	5	8	5.2
5/16"	18	FAB0200585	72	15	8	6.3	9	6.6
3/8"	16	FAB0200596	80	15	10	8	11	8
7/16"	14	FAB0200606	85	19	8	6.3	9	9.4
1/2"	13	FAB0200617	89	19	9	7.1	10	10.8
5/8"	11	FAB0200631	102	20	12.5	10	13	13.5
3/4"	10	FAB0200641	112	25	14	11.2	14	16.5



Spiral Flute Machine Taps

SB3 Series

UNC

Unified coarse threads

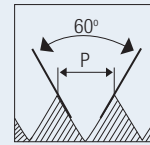

HOLE TYPE



HSS-E

ISO 529

2B

C/2-3P

35°

TiN

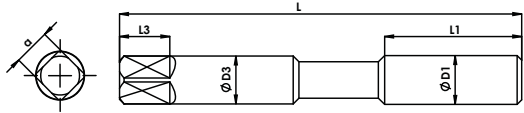

Reinforced Shank (1/4" - 3/8")

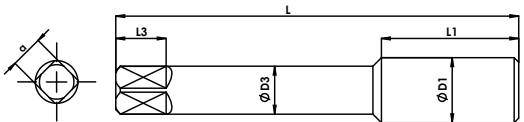

Reduced Shank (7/16" - 3/4")

P0-P2

K1-K2

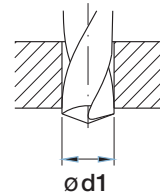

Unit : mm

Nominal Diameter	TPI	EDP No.	Overall Length	Thread Length	Shank Diameter	Square Size	Square Length	Tapping Drill Diameter
ØD1			L	L1	ØD3	a	L3	Ød1
1/4"	20	FAB0200578	66	10	6.3	5	8	5.2
5/16"	18	FAB0200587	72	15	8	6.3	9	6.6
3/8"	16	FAB0200598	80	15	10	8	11	8
7/16"	14	FAB0200608	85	19	8	6.3	9	9.4
1/2"	13	FAB0200619	89	19	9	7.1	10	10.8
5/8"	11	FAB0200633	102	20	12.5	10	13	13.5
3/4"	10	FAB0200643	112	25	14	11.2	14	16.5

HSS TAPS

DIES

END MILLS

DRILLS

CARBIDE BURRS

CS TAPS



Spiral Flute Machine Taps

SB1 Series

UNF

Unified fine threads

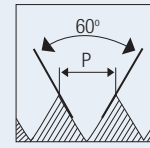

HOLE TYPE



HSS-E

ISO
529

2B



35°

BF

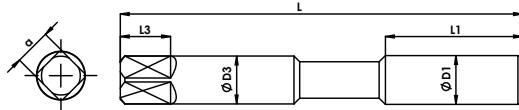

Reinforced Shank (1/4" - 3/8")

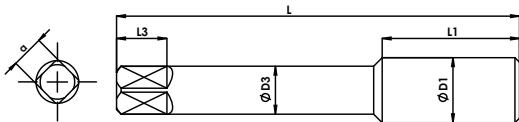

Reduced Shank (7/16" - 3/4")

P0-P1

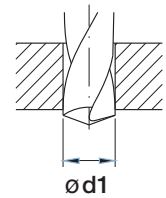

Unit : mm

Nominal Diameter	TPI	EDP No.	Overall Length	Thread Length	Shank Diameter	Square Size	Square Length	Tapping Drill Diameter
ØD1			L	L1	ØD3	a	L3	Ød1
1/4"	28	FAB0200500	66	10	6.3	5	8	5.5
5/16"	24	FAB0200510	69	15	8	6.3	9	6.9
3/8"	24	FAB0200520	76	15	10	8	11	8.5
7/16"	20	FAB0200531	82	19	8	6.3	9	9.9
1/2"	20	FAB0200542	84	19	9	7.1	10	11.5
5/8"	18	FAB0200555	95	20	12.5	10	13	14.5
3/4"	16	FAB0200566	104	20	14	11.2	14	17.5



Spiral Flute Machine Taps

SB3 Series

UNF

Unified fine threads

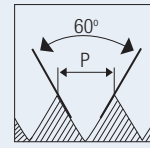

HOLE TYPE



HSS-E
ISO 529
2B
C/2-3P
35°
TiN

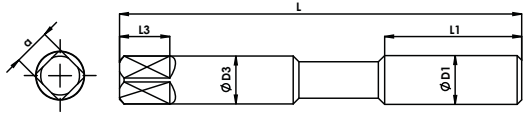

Reinforced Shank (1/4" - 3/8")

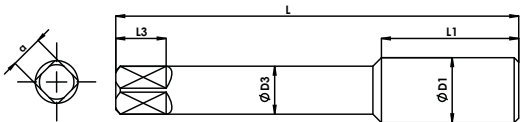

Reduced Shank (7/16" - 3/4")

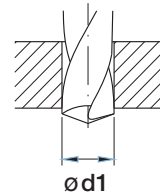

P0-P2

K1-K2

Unit : mm

Nominal Diameter	TPI	EDP No.	Overall Length	Thread Length	Shank Diameter	Square Size	Square Length	Tapping Drill Diameter
ØD1			L	L1	ØD3	a	L3	Ød1
1/4"	28	FAB0200501	66	10	6.3	5	8	5.5
5/16"	24	FAB0200512	69	15	8	6.3	9	6.9
3/8"	24	FAB0200522	76	15	10	8	11	8.5
7/16"	20	FAB0200533	82	19	8	6.3	9	9.9
1/2"	20	FAB0200544	84	19	9	7.1	10	11.5
5/8"	18	FAB0200557	95	20	12.5	10	13	14.5
3/4"	16	FAB0200568	104	20	14	11.2	14	17.5

HSS TAPS

DIES

END MILLS

DRILLS

CARBIDE BURRS

CS TAPS