



TAPARIA TOOLS LTD.

AN ISO-9001 COMPANY



PIPE WRENCHES

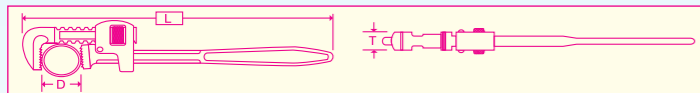

PROD. NO	D	T	L	WT. GMS
1272	33	15	250	500
1273	42	19	300	750
1274	48	21	350	1000
1275	60	24	450	1540
1276	73	28	600	2920
1277	90	34	900	5880

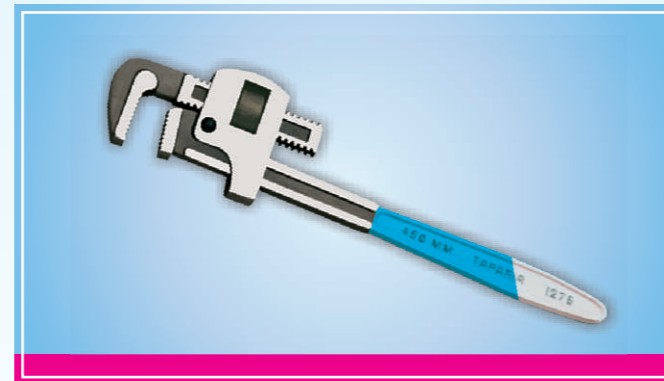

HEAVY DUTY UNIVERSAL PIPE WRENCHES

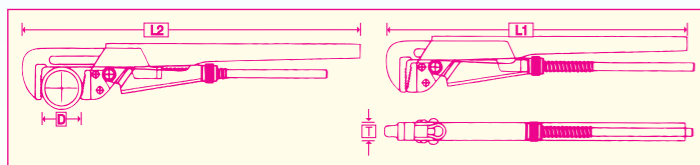

PROD. NO	A	B	C	D	WT. GMS
1510	38	17	275	310	690
2014	52	21	360	420	1244



HEAVY DUTY PIPE WRENCHES

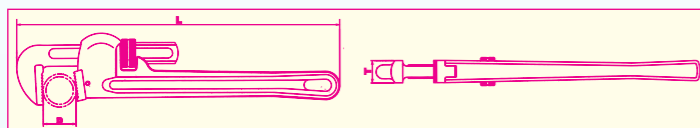

PROD. NO	NOM. PIPE	T	L	WT. GMS	PROD. NO	NOM. PIPE	T	L	WT. GMS
HPW 08	35	15	200	400	HPW 18	76	26	450	2400
HPW 10	49	17	250	850	HPW 24	90	33	600	4100
HPW 12	60	23	300	1100	HPW 36	140	37	900	8800
HPW 14	60	23	350	1650	HPW 48	166	37	1200	13800



ALUMINIUM PIPE WRENCH

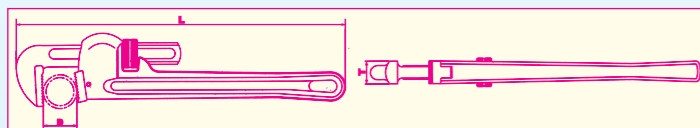

PROD. NO	NOM. PIPE	T	L	WT. GMS	PROD. NO	NOM. PIPE	T	L	WT. GMS
APW 10	49	17	250	600	APW 24	90	33	600	2500
APW 14	60	23	350	1000	APW 36	140	37	900	4750
APW 18	76	26	450	1500	APW 48	166	37	1200	7700



SPARES FOR HEAVY DUTY & ALUMINIUM PIPE WRENCH

PROD. NO	NOM. PIPE ØD	T	L	WT. GMS
HPW 12 S	60	23	300	1100
HPW 14 S	60	23	350	1650
HPW 18 S	76	26	450	2400

PROD. NO	NOM. PIPE ØD	T	L	WT. GMS
HPW 24 S	90	33	600	4100
HPW 36 S	140	37	900	8800
HPW 48 S	166	37	1200	13800

CHAIN PIPE WRENCHES

- Drop forged jaw from high grade steel
- Jaw teeth induction hardened for long life
- Jaw teeth provided on both sides for easy change of direction
- Accurately machined teeth provides firm and non-damaging grip.

PROD. NO	NOMINAL PIPE SIZE MAX ØD	L	L1	E	T	WT. GMS
CPW 04	CPW 04	900	165	80	12	8000
CPW 06	CPW 06	1000	180	90	13	9500
CPW 08	CPW 08	1200	190	90	14	11800
CPW 10	CPW 10	1300	215	95	15	13500
CPW 12	CPW 12	1400	215	95	15	14500
CPW 16	CPW 16	1585	215	95	15	16500

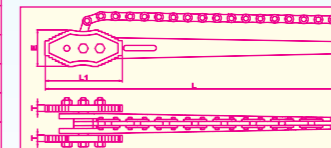

PIPE VICE

- Body made of malleable cast iron.
- Drop forged gripping jaws made from high grade steel.
- Heat treated and accurately machined jaw provides firm grip on pipes.

PROD. NO	NOM. PIPE SIZE ØA ØD	T	L	WT. GMS	
PV 00	10 - 40	16	95	60	1100
PV 01	10 - 60	24	145	105	4250
PV 02	10 - 90	24	190	105	5600
PV 03	15 - 115	24	215	120	7800
PV 04	15 - 165	30	260	160	10000

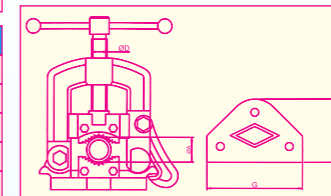

C-CLAMPS

- Body Hot drop forged from high grade steel.
- All parts fully heat treated and Black Phosphated for long trouble free service.
- Ideal for heavy duty application.

PROD. NO	A	B	C	D	WT. GMS
1259 - 2	200	55	49	22	360
1260 - 3	260	80	62	22	570
1261 - 4	330	105	75	25	1060
1263 - 6	440	155	93	25	1700
1264 - 8	565	205	106	32	2840

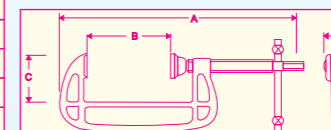

TAPARIA TOOLS LTD.



Head Office : 423 / 424, A-2, Shah & Nahar, Lower Parel (W), Mumbai - 400 013. & : 2493 8646 - 50
 Fax : 91-22-2495 3230. • E-mail : sales@tapariatools.com • Web Site : http://www.tapariatools.com
 Works : 52-B, M. I. D. C., Satpur, Nashik - 422 007. & : 2350 317 / 318 / 418 • Fax : 0253-2350740



An ISO-9001 Company

TAPARIA® TAPARIA® TAPARIA® TAPARIA® TAPARIA®