



1/2 DRIVE BIHEXAGONAL AND HEXAGONAL SOCKETS

PROD. NO	FIG NO.	A	B	C	ØD	ØE	A/F	WEIGHT GRAMS
8	1	36	20	16	12.0	22	8	45
9	1	36	20	16	13.0	22	9	45
10	1	36	20	16	16.0	22	10	45

11	1	36	20	16	17.5	22	11	48
12	1	36	20	16	18.7	22	12	50
13	1	36	20	16	20.0	22	13	52
14	1	36	20	16	21.3	22	14	52

15	2	38	-	-	22.5	-	15	52
16	2	38	-	-	23.5	-	16	52
17	2	38	-	-	25.0	-	17	75
18	2	38	-	-	25.5	-	18	70

19	2	40	-	-	27.5	-	19	90
21	2	40	-	-	28.9	-	21	104
22	2	40	-	-	31.0	-	22	125
23	2	43	-	-	31.3	-	23	120

24	3	43	18	25	32.5	30	24	130
26	3	43	18	25	35.2	30	26	140
27	3	46	18	25	36.4	30	27	150
28	3	46	18	28	37.7	30	28	165

29	3	46	18	28	38.9	30	29	165
30	3	46	18	28	40.4	30	30	185
32	3	46	17	29	42.7	30	32	195
33	3	46	17	29	43.9	30	33	195
34	3	46	17	29	45.2	30	34	190

Heavy Duty Hexagonal SOCKETS

PROD. NO	FIG NO.	A	B	C	ØD	ØE	A/F	WEIGHT GRAMS
HD 10	1	36	20	16	17.0	22.5	10	55
HD 11	1	36	20	16	18.5	22.5	11	60
HD 13	1	38	21	17	21.2	24.0	13	80

HD 14	1	38	21	17	22.5	24.0	14	80
HD 17	2	38	-	-	26.5	-	17	85
HD 19	2	38	-	-	29.3	-	19	120
HD 22	2	38	-	-	33.3	-	22	170

LD 18	2	80	-	-	26.5	-	18	165
LD 24	4	80	25	55	34.3	31.5	24	280
EL 10	-	150	18	15	16.0	23.0	10	174

SOCKETS 12.7 mm (1/2") SQUARE DRIVE

PROD. NO	FIG NO.	A	B	C	ØD	ØE	A/F	WEIGHT GRAMS
SP 16	1	36	20	16	14.0	22.5	8	55
SP 21	1	36	20	16	15.0	22.5	9	50

EXEL SOCKETS - 12.7 MM (1/2") SQUARE DRIVE

PROD. NO	FIG NO.	A	B	C	ØD	ØE	A/F	WEIGHT GRAMS
FD 8	1	36	20	16.5	13.5	22	8	50
FD 9	1	36	20	16.5	14.5	22	9	50
FD 10	1	36	20	16.5	15.7	22	10	50
FD 11	1	38	21.5	16.5	16.7	22	11	50

FD 12	1	38	21.5	16.5	17.8	22	12	50
FD 13	1	38	21.5	16.5	19.0	22	13	50
FD 14	1	38	21.5	16.5	20.2	22	14	50
FD 15	1	38	21.5	16.5	21.0	22	15	50

FD 16	3	38	16	22	21.8	20.5	16	50
FD 17	3	38	16	22	23.8	22	17	60
FD 18	3	38	16	22	25.8	22	18	80
FD 19	3	38	16	22	25.8	22	19	70

FD 20	3	38	16	22	27.8	25	20	80
FD 21	3	38	16	22	28.0	25	21	70
FD 22	3	38	16	22	29.8	26	22	90
FD 23	3	38	16	22	31.8	28	23	115
FD 24	3	38	16	22	31.8	28	24	105

FD 25	3	40	17	23	33.7	30	25	125
FD 26	3	42	17	25	35.5	31	26	158
FD 27	3	42	17	25	35.8	32	27	158
FD 28	3	44	17	27	37.6	33	28	188

FD 29	3	44	17	27	38.0	33	29	180
FD 30	3	44	16	28	39.5	34	30	200
FD 32	3	44	16	28	41.5	36	32	225

IMPACT SOCKET - HEXAGONAL 12.7 MM (1/2") SQ. DRIVE

PROD. NO	FIG NO.	A	B	C	ØD	ØE	A/F	WEIGHT GRAMS
IM 8	1	36	21	15	13.5	25	8	60
IM 9	1	36	21	15	14.5	25	9	65
IM 10	1	36	21	15	17	25	10	65
IM 11	1	38	21	15	18.5	25	11	65

IM 12	1	36	21	15	20	25	12	65
IM 13	1	36	21	15	21.5	25	13	75
IM 14	1	36	21	15	22.5	25	14	70
IM 15	1	36	21	15	24.0	25	15	80

IM 16	2	38	21	15	25.0	25	16	80
IM 17	2	38	21	15	26.5	26.5	17	95
IM 18	2	38	21	15	28.0	28	18	105
IM 19	2	38	21	15	30.0	30	19	120

IM 20	3	40	17	23	31.0	30	20	80
IM 21	3	40	17	23	32.0	30	21	95
IM 22	3	40	17	23	33.5	30	22	105
IM 23	3	40	18	25	35.0	30	23	120

IM 24	3	43	18	25	36.0	30	24	170
IM 26	3	43	18	25	38.9	30	26	175
IM 27	3	43	18	25	40.0	30	27	180
IM 28	3	46	19	27	41.5	30	28	200

IM 29	3	46	19	27	42.5	30	29	215
IM 30	3	46	19	27	44.0	30	30	220
IM 31	3	46	19	27	44.5	30	31	225
IM 32	3	46	19	27	46.5	30	32	245

DEEP SOCKETS 1/2" SQUARE DRIVE

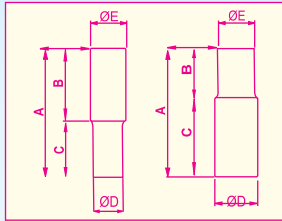

PROD. NO	FIG NO.	A	B	C	ØD	ØE	A/F	WEIGHT GRAMS
L8H	1	76	42	34	14	22	8	110
L10H	1	76	42	34	16	22	10	110
L11H	1	76	42	34	17	22	11	110
L12H	1	76	42	34	18	22	12	110

L13H	1	76	42	34	19	22	13	115
L14H	1	76	42	34	20.5	22	14	120
L15H	3	76	30	46	22	22	15	120
L16H	3	76	30	46	22	22	16	110

L17H	3	76	30	46	24	22	17	130
L18H	3	76	30	46	26	24	18	160
L19H	3	76	30	46	26	24	19	150
L20H	3	76	30	46	28	25	20	175

L21H	3	76	30	46	28	25	21	165
L22H	3	76	30	46	30	26	22	195
L24H	3	76	30	46	32	28	24	215
L27H	3	76	30	46	36	32	27	280
L30H	3	76	30	46	40	28	34	350

SOCKET SET (3/4" SQUARE DRIVE)

PROD. NO	CONTENTS	
Bihexagonal Socket sets	Hexagonal Socket sets	
S-3/4 BH	S-3/4 H	22, 24, 27, 30, 32, 36, 38, 41, 46, & 50
(10 Sockets + 4 Accessories)		Accessories : Extension Bar 2753, Extension Bar 2763, T-Handle 2733, Ratchet Handle with Coupler 2715.



3/4 SQ. DRIVE SOCKETS

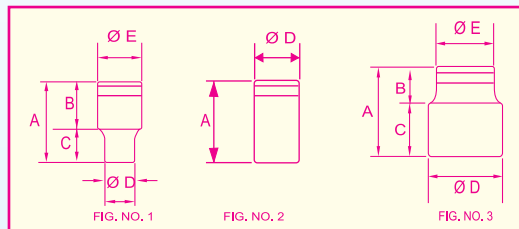

PROD. NO	FIG NO.	A	B	C	ØD	ØE	A/F	WEIGHT GRAMS
C 19	1	50	28	22	29.0	36	19	200
C 21	1	50	28	22	31.0	36	19	200
C 22	1	50	30	20	33.0	36	22	215
C 24	1	50	30	20	35.0	36	24	210

C 26	3	52	22	30	36.0	35	26	215
C 27	2	51.5	-	-	38.0	-	27	220
C 28	3	52	21	31	40.0	36	28	235
C 29	3	52	21	31	40.0	38	29	240

C 30	3	54	21	33	42.0	38	30	265
C 32	3	56	21	35	44.0	38	32	300
C 33	3	56	23	33	46.0	38	33	315
C 34	3	58	22	36	46.0	38	34	320

C 35	3	58	22	36	48.0	42	35	380
C 36	3	58	20	38	50.0	42	36	395
C 38	3	60	20	40	52.0	45	38	450
C 41	3	64	24	40	56.0	45	41	535

C 42	3	64	22	42	58.0	45	42	590
C 46	3	68	21	47	62.0	48	246	685
C 50	3	72	24	48	68.0	48	50	800
C 55	3	76	26	48	74.0	48	55	955

C 60	3	78	30	48	78.0	48	60	910
C 65	3	85	30	55	86.0	48	65	1570
C 70	3	85	30	55	91.0	48	70	1680



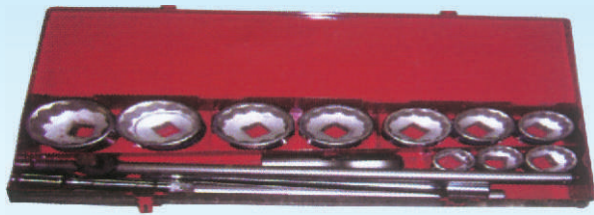

BI-HEXAGONAL SOCKET SET (1" SQUARE DRIVE)

PROD. NO.	CONTENTS
S1BH	Socket ; 36 mm, 41 mm, 46 mm, 50 mm, 55 mm,
(10 Sockets &	60mm, 65 mm, 70 mm, 75 mm & 80 mm
4 Accessories)	Accessories - 3715, 3733, 3753, 3763

SOCKET 1" SQ. DRIVE

PROD. NO.	FIG NO.	A	B	C	ØD	ØE	A/F	WT. GMS
D 36	3	60	20	40	50	46	36	400
D 38	3	65	22	43	54	46	38	520
D 41	3	65	25	40	54	46	46	520

D 46	3	75	26	49	65	50	46	830
D 50	3	75	26	49	69	56	50	1050
D 55	3	80	28	52	75	56	55	1200
D 60	3	84	30	54	81	56	60	1350

D 65	3	88	30	58	87	56	65	1550
D 70	3	94	30	64	93	68	70	2100
D 75	3	98	34	64	99	68	75	2500
D 80	3	103	34	69	105	68	80	2600

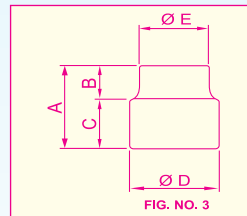

SOCKET SET

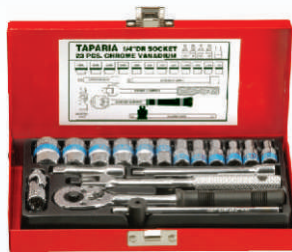

Consists of selected sockets and accessories, neatly packed in attractive powder coated carrying case.

SOCKET SET 1/4 SQ. DRIVE

PROD. NO.	CONTENTS
S 1/4 H	Sockets - 4, 4.5, 5, 5.5, 6, 7, 8, 10, 11, 12, 13, 14.
(17 Sockets +	Adaptor - Hex 1/4 x SQ. 1/4
6 Accessories)	Adaptor Torx - T20, T 25, T30, T40
	Accessories - A 733 - T- Handle, A 743 - Extn.Bar,
	A 753 - Extn.Bar, A 773 - Universal Joint,
	A 703 - Nut spinner Flexible, A 715 - Ratchet Handle

SOCKET 1/4 SQ. DRIVE

PROD. NO	FIG NO.	A	B	C	ØD	ØE	A/F	WT. GMS
A 4 H	1	25	13	12	6.8	12	4	10
A 4.5 H	1	25	13	12	7.3	12	4.5	10
A 5 H	1	25	13	12	8.0	12	5	10
A 5.5 H	1	25	13	12	8.5	12	5.5	10
A 6 H	1	25	13	12	9.0	12	6	10
A 7 H	1	25	13	12	10.5	12	7	10
A 8 H	1	25	13	12	11.7	11	8	10
A 10 H	3	25	11	14	14	12	10	10
A 11 H	3	25	11	14	16	14	11	20
A 12 H	3	25	11	14	17	15	12	20
A 13 H	3	25	11	14	18	16	13	25

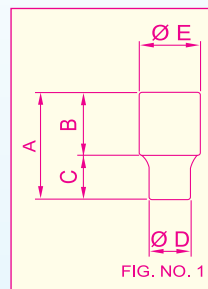

SOCKET SET 3/8 SQ. DRIVE

PROD. NO.	CONTENTS
S 3/8 H	Sockets - 6, 7, 8, 9, 10, 11, 12, 13, 14, 17, 19, 21, 22
(14 Sockets +	Spark Plug Socket - BSP 21
6 Accessories)	Accessories - B 733 - T- Handle, B 743 - Extn.Bar,
	B 753 - Extn.Bar, B 773 - Universal Joint,
	B 703 - Nut spinner Flexible, B 715 - Ratchet Handle

SOCKET 3/8 SQ. DRIVE

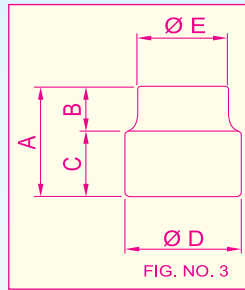

PROD. NO	FIG. NO.	A	B	C	ØD	ØE	A/F	WEIGHT GRAMS	STD. PKG.
B 6 H	1	28	16	12	10.3	17	6	25	5
B 7 H	1	28	16	12	11	17	7	25	5

B 8 H	1	28	16	12	12	17	8	25	5
B 9 H	1	28	16	12	13.3	17	9	25	5
B 10 H	1	28	16	12	14.5	17	10	25	5

B 11 H	3	28	16	12	16	17	11	25	5
B 12 H	3	28	12	16	17	15.5	12	25	5
B 13 H	3	28	12	16	17.8	16.5	13	25	5
B 14 H	3	28	12	16	19.7	17	14	25	5

B 17 H	3	30	12	18	23.7	20	17	45	5
B 19 H	3	30	12	18	26	23	19	60	5
B 21 H	3	30	12	18	28	25	21	70	5
B 22 H	3	30	12	18	29.7	26	22	80	5

SOCKET ACCESSORIES

T-HANDLE

SIZE	PROD. NO.	A/F	L	ØD	ØE	ØF	WT. GMS
1/4 Drive	A 733	6.30	115	14	8.0	6.0	45
3/8 Drive	B 733	9.50	200	19	12.6	10.5	75
1/2 Drive	1733-S	12.7	250	27	16.6	13	345
3/8 Drive	1733	12.7	300	27	16.6	13	400
3/4 Drive	2733	19	500	38	24.5	18	1220
1 Drive	3733	25	630	49	33.8	25	2970

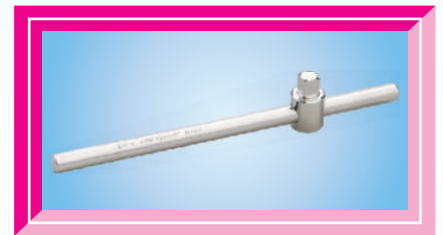
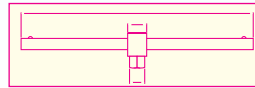

EXTENSION BAR

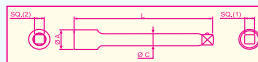

SIZE	PROD. NO.	L	ØA	ØB	ØD	SQ.(1)	SQ.(2)	WT. GMS
1/4 Drive	A 743	50	12	-	8.0	6.40	6.30	25
	A 753	100	12	-	8.0	6.40	6.30	45
3/8 Drive	B 743	76	18	-	12.0	9.60	9.50	75
	B 753	152	18	-	12.0	9.60	9.50	140

1/2 Drive	1713	50	22	-	12.8	12.8	12.8	85
	1743	75	22	-	12.8	12.8	12.8	110
	1753	125	22	-	12.8	12.8	12.8	150
	1763	255	22	-	12.8	12.8	12.8	290

3/4 Drive	2753	255	35	-	19.1	19.1	19.1	700
	2763	385	35	-	19.1	19.1	19.1	980
1 Drive	3753	20	48	-	29.0	25.2	25.8	1320
	3763	400	48	-	29.0	25.2	25.8	2410

RATCHET HANDLE

R-HANDLE	PROD. NO.	FIG. NO.	A	B	L	WT. GMS
1/4 Drive	A 715	1	12	27	160	135
3/8 Drive	B715	1	13	27	215	340
1/2 Drive	1715	2	18	35	255	480
	1715 N	2	16	46	260	550
3/4 Drive	2715 With Sq. Coupler	-	30	65	500	2040
1" Drive	3715 R-H	1	32	69	-	-
	T-BAR	2	Ø28	-	562	2680

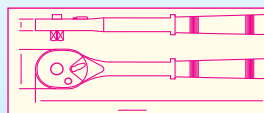

FLEXIBLE HANDLE

SIZE	PROD. NO.	FIG NO.	A	B	L	WT. GMS
1/4 Drive	A 703	2	11	16.5	145	115
3/8 Drive	B 703	2	15	22	225	215
1/2 Drive	1703	1	20	25	250	390

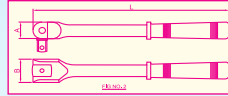

UNIVERSAL JOINT

SIZE	PRODUCT NO	FIG NO.	A	B	L	WEIGHT GRAMS
1/4 Drive	A 773	3	14	14	39	25
3/8 Drive	B 773	3	19	19	55	65
1/2 Drive	1773	3	25	22	74	160
3/4 Drive	2273	3	40	40	108	560

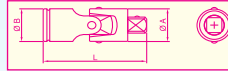

ANGLE HANDLE

PROD. NO.	L1	L2	ØA	ØB	SQ	WEIGHT GRAMS
1734/1734N	189	56	---	16	12.7	320
1735	250	60	---	16	12.7	430
1736	300	75	---	16	12.7	525
1737	450	120	---	16	12.7	835

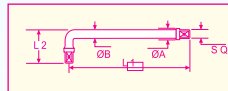

SPEEDER BRACE

PROD. NO.	ØD1	ØD2	L	L1	SQ	WEIGHT GRAMS
1783	13	22	397	146	12.7	760

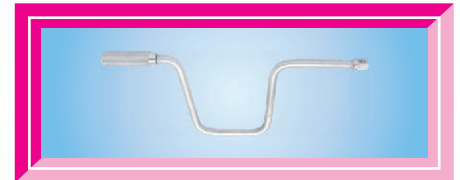
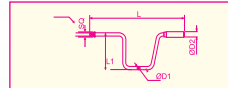

3/4 - SQUARE DRIVE

PROD. NO.	SQ	L	WEIGHT GRAMS
2716	19.5	52	150

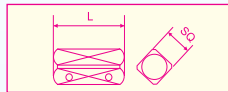

TAPARIA TOOLS LTD.



Head Office : 423 / 424, A-2, Shah & Nahar, Lower Parel (W), Mumbai - 400 013. & : 2493 8646 - 50
 Fax : 91-22-2495 3230. • E-mail : sales@tapariatools.com • Web Site : http://www.tapariatools.com
 Works : 52-B, M. I. D. C., Satpur, Nashik - 422 007. & : 2350 317 / 318 / 418 • Fax : 0253-2350740



An ISO-9001 Company

TAPARIA® TAPARIA® TAPARIA® TAPARIA® TAPARIA®