

# Specialty Tools

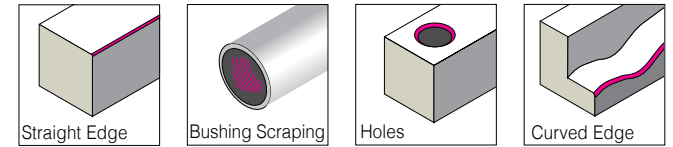

## MULTIBURR RG1000

The handy universal deburring set with multi-purpose blades will help you produce a perfect finish for a wide variety of jobs.

This innovative tool set has 4 folding shafts which can be easily locked into position for the duration of the work and then folded neatly back into the handle allowing the tool to be carried simply anywhere.

### S10 Blade

Works best on steel, aluminum and plastic

### D50 Scraper Blade

Ideal for tool and die makers

### 10.4 mm Rotodrive Countersink Blade

Quickest way to chamfer.

Range 1-10.4 mm

### N2 Blade

Works best on brass and cast iron



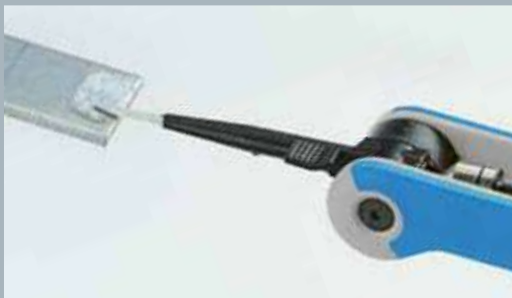

## NON SCRATCH NG1910

Removing burrs from workpieces may sometimes leave unsightly scratches, Noga's NG-1 handle with the NEW non scratch blade with safety cap will prevent friction therefore eliminating scratches. Works best on steel, aluminum and plastic materials.

INCLUDES: NG-1 handle and S91 blade.



## Non Scratch HSS Blade with safety cap BS9110

Plastic safety cap will protect workpiece surface from scratches.



# Specialty Tools



## SOFT GRIP SG1000

Ergonomically designed handle for ease of use.  
At front end 2 holes can take both S and N blades.



INCLUDES:  
SG handle, S100 and N10 Cobalt blades.

### TO INSERT BLADE

1. Hold handle in left and blade right hand.
2. Push blade in and simultaneously turn blade CW.

### TO REMOVE BLADE

1. Repeat as above but pull out.

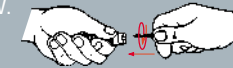

A wide variety of tools, blade holders and blades are available for use with the versatile Universal Chuck Handle.

## UNIVERSAL HANDY CHUCK HOLDER PV1000

Aluminium handle with non-slip covering. A 3 jaw chuck helps with quick and secure clamping of a wide variety of tools, blade holders and blades for scrapers, countersinks, files etc.  
Range: 0.8 - 8 mm.



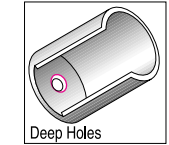
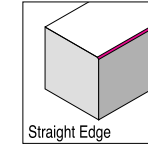
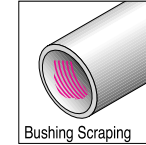
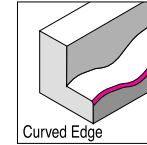
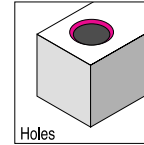

## LIZA BURR LB1000

Double end blade holder to utilize both N and S blades.  
Telescopes from:  
20-110 mm with N blades  
20-94 mm with S blades.



INCLUDES:  
UNI handle, SN holder, N1 and N2 blades.

## SCRAPER SC1000

Double end scraper for longer tool life.  
Can be locked in required position.



INCLUDES:  
UNI handle and T120 double ended triangular scraper.

# Specialty S Blades

BLADES	order no.		works best on:
<b>S10 Carbide</b>	BS1016		hardened steel and plastic
<b>S10 Diamond</b>	BS1014		glass and ceramics
<b>S10 LH</b>	BS1011	LH 	steel, aluminium and plastic
<b>S10 LH TiN</b>	BS1013	LH 	steel, aluminium and plastic. For long life.
<b>S100 TiN</b>	BS1019		stainless steel and plastic. For long life.
<b>S20 Carbide</b>	BS2015	L/R 	hardened materials and plastic
<b>S101 LH</b>	BK1011	LH 	fine edges on all materials.
<b>S101 TiN</b>	BK1012		fine edges on all materials. For long life.
<b>S30 TiN</b>	BS3003		both int. and external burrs. For long life.
<b>S60 TiN</b>	BS6003		cross holes in difficult to reach places. For long life.
<b>S80</b>	BS8001		shallow steps
<b>S80 TiN</b>	BS8003		shallow steps. For long life.
<b>S1500</b>	BS1510		special blade for deburring rubber and soft materials

LH - for left hand users. L/R - for left and right hand users.

Blades are made of H.S.S. Hardness 62-64Rc, except S10 and S20 Carbide blades 1400-1700 HV and S100 Cobalt 65-66Rc.

# Specialty N Blades

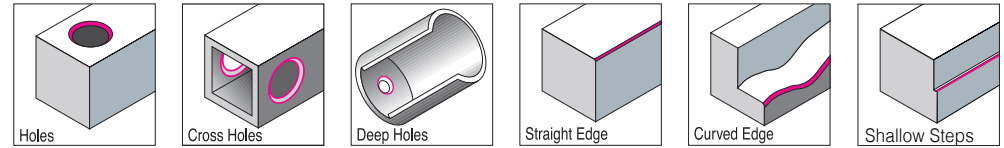

BLADES	order no.		works best on:
<b>N1 Carbide</b>	BN1029		hardened steel and special plastics
<b>N1 Diamond</b>	BN1028		glass and ceramics
<b>N1 LH</b>	BN1026	LH	steel, aluminum and plastic
<b>N1 LH TiN</b>	BN1027	LH	steel, aluminum and plastic. For long life.
<b>N2 Carbide</b>	BN2031	L/R	hardened steel and hard plastic

LH - for left hand users. L/R - for left and right hand users. Blades are made of H.S.S. Hardness 62-64Rc, except N1 and N2 Carbide blades 1400-1700 HV.