

# Inch type

## Dial Indicator

### .0001" Graduated Dial Indicator (AGD-2)



**AI-9111**  
Graduation .0001"  
Measuring Range .05"  
Jewel, heavy-duty type  
Shockproof

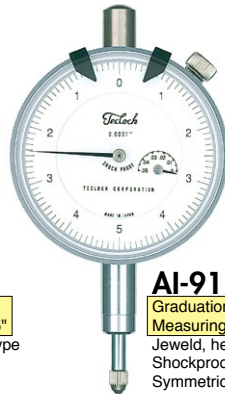

**AI-9112**  
Graduation .0001"  
Measuring Range .05"  
Jewel, heavy-duty type  
Shockproof  
Symmetrical Scale

### .001" Graduated Dial Indicator (AGD-2)



**AI-905**  
Graduation .001"  
Measuring Range .25"  
Shockproof



**AI-906**  
Graduation .001"  
Measuring Range .25"  
Symmetrical Scale  
Shockproof



**AI-911**  
Graduation .001"  
Measuring Range .50"  
Shockproof

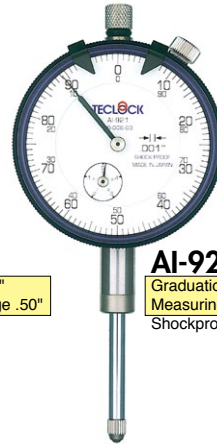

**AI-921**  
Graduation .001"  
Measuring Range 1.0"  
Shockproof



**AI-921B**  
Graduation .001"  
Measuring Range 1.0"  
Black Face  
Shockproof

### Miniature Dial Indicator (AGD-1)

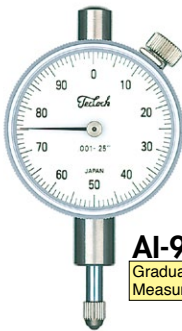

**AI-935**  
Graduation .001"  
Measuring Range .25"



**AI-936**  
Graduation .001"  
Measuring Range .25"  
Symmetrical Scale

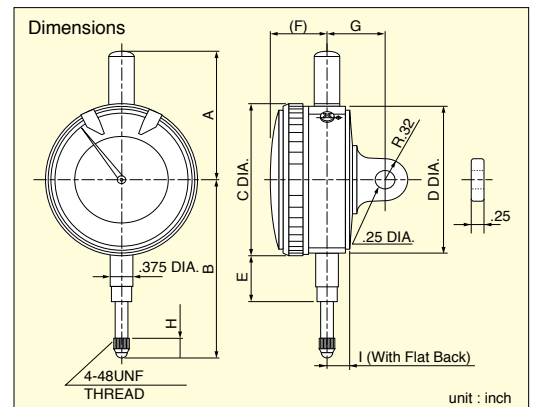

### Specification

Model	Graduation (inch)	Total Range (inch)	Range per Rev. (inch)	Dial Reading	Accuracy (inch)	Measuring Force N(gf)	Dimensions (inch)									Weight (g)	Remark
							A	B	C	D	E	F	G	H	I		
AI-9111	.0001	.05	.01	0-5-10	±.0002	1.5(150) or less	1.58	2.35	2.2	2.07	.7	.59	.8	.25	—	170	
AI-9112	.0001	.05	.01	0-5-0	±.0002	1.5(150) or less	1.58	2.35	2.2	2.07	.7	.59	—	.25	.32	170	Flat Back
AI-905	.001	.25	.10	0-50-100	±.0007	1.3(130) or less	1.76	2.51	2.17	2.05	.7	.62	.8	.25	—	110	
AI-906	.001	.25	.10	0-50-0	±.0007	1.3(130) or less	1.76	2.51	2.17	2.05	.7	.62	—	.25	.31	110	Flat Back
AI-911	.001	.5	.10	0-50-100	±.0009	1.3(130) or less	1.49	2.65	2.17	2.05	.7	.62	.8	.25	—	110	
AI-912	.001	.5	.10	0-50-0	±.0009	1.3(130) or less	1.49	2.65	2.17	2.05	.7	.62	.8	.25	—	110	
AI-921	.001	1.0	.10	0-50-100	±.0014	2.2(220) or less	1.49	3.15	2.17	2.05	.7	.62	.8	.25	—	115	
AI-921B	.001	1.0	.10	0-50-100	±.0014	2.2(220) or less	1.49	3.15	2.17	2.05	.7	.62	.8	.25	—	115	Black Face
AI-922	.001	1.0	.10	0-50-0	±.0014	2.2(220) or less	1.49	3.15	2.17	2.05	.7	.62	.8	.25	—	115	
AI-935	.001	.25	.10	0-50-100	±.0007	1.3(130) or less	1.08	1.73	1.54	1.43	.41	.53	.76	.25	—	75	
AI-936	.001	.25	.10	0-50-0	±.0007	1.3(130) or less	1.08	1.73	1.54	1.43	.41	.53	.76	.25	—	75	



### Long Range Dial Indicator (AGD-2)



**AI-951**  
Graduation .001"  
Measuring Range 2.0"  
Shockproof



**AI-951B**  
Graduation .001"  
Measuring Range 2.0"  
Black Face  
Shockproof

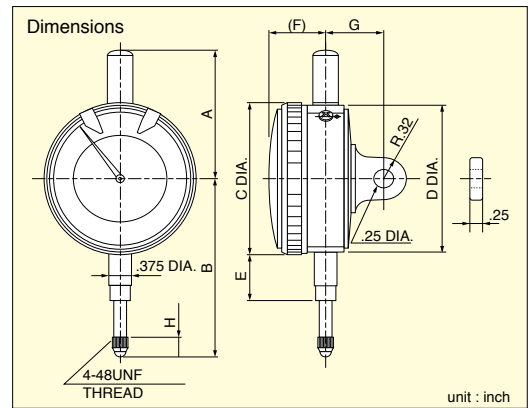

Specification

Model	Graduation (inch)	Total Range (inch)	Range per Rev. (inch)	Dial Reading	Accuracy (inch)	Measuring Force N(gf)	Dimensions (inch)								Weight (g)	Remark
							A	B	C	D	E	F	G	H		
AI-951	.001	2.0	.10	0-50-100	±.0032	2.5(250) or less	4.71	5.5	2.3	2.1	2.0	.71	.79	.25	215	
AI-951B	.001	2.0	.10	0-50-100	±.0032	2.5(250) or less	4.71	5.5	2.3	2.1	2.0	.71	.79	.25	215	Black Face

### 0.01mm Graduated Dial Indicator (AGD-2)

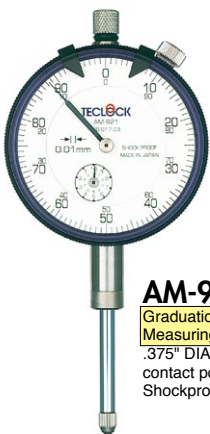

**AM-921**  
Graduation 0.01mm  
Measuring Range 25mm  
.375" DIA. STEM  
contact point (4-48UNF)  
Shockproof



**AM-110**  
Graduation 0.01mm  
Measuring Range 10mm  
.375" DIA. STEM  
contact point (M2.5 × P0.45)  
Shockproof

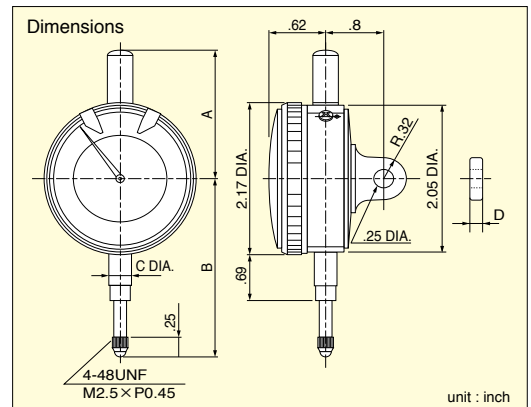

Specification

Model	Graduation (mm)	Total Range (mm)	Range per Rev. (mm)	Dial Reading	Accuracy (mm)	Measuring Force N(gf)	Dimensions (inch)				Contact Point Screw	Weight (g)
							A	B	Stem Dia : φ C	Lug Thickness : D		
AM-110	0.01	10	1.0	0-50-100	±0.015	1.4(140) or less	1.91	2.56	φ .375"	.25	M2.5 × P0.45	110
AM-121	0.01	20	1.0	0-50-100	±0.020	2.2(220) or less	1.42	2.95	φ 8mm	.196	M2.5 × P0.45	115
AM-921	0.01	25	1.0	0-50-100	±0.030	2.2(220) or less	1.49	3.15	φ .375"	.25	4-48UNF	115
AM-922	0.01	25	1.0	0-50-0	±0.030	2.2(220) or less	1.49	3.15	φ .375"	.25	4-48UNF	115



### Dial Indicator (with 8mm stem)



**TI-1111**  
Graduation .0001"  
Measuring Range .05"  
Heavy-duty, jeweled type  
Shockproof



**TI-1205**  
Graduation .0001"  
Measuring Range .20"



**TI-111**  
Graduation .001"  
Measuring Range .50"  
Shockproof

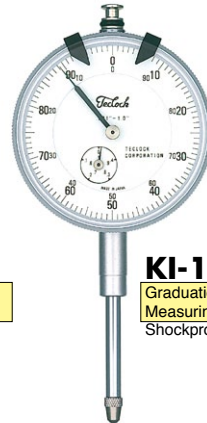

**KI-121**  
Graduation .001"  
Measuring Range 1.0"  
Shockproof

### Miniature Dial Indicator (AGD-1)



**TI-35**  
Graduation .001"  
Measuring Range .20"

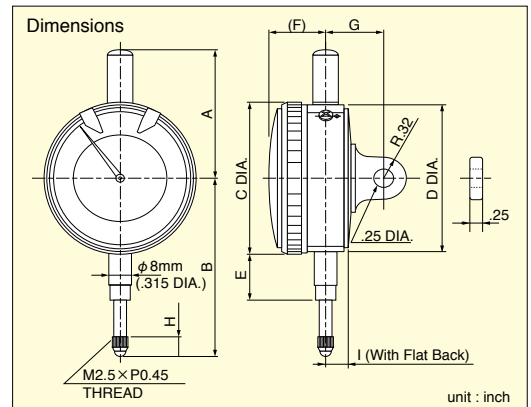

#### Specification

Model	Graduation (inch)	Total Range (inch)	Range per Rev. (inch)	Dial Reading	Accuracy (inch)	Measuring Force N(gf)	Dimensions (inch)								Weight (g)	Remark	
							A	B	C	D	E	F	G	H			I
TI-111	.001	.50	.10	0-50-100	$\pm .0009$	1.4(140) or less	1.76	2.7	2.177	2.05	.69	.62	.79	.30	—	110	
KI-121	.001	1.0	.10	0-50-100	$\pm .0014$	2.2(220) or less	1.44	3.19	2.17	2.05	.69	.62	.79	.30	—	115	
TI-1111	.0001	.05	.01	0-5-10	$\pm .0002$	1.5(150) or less	1.57	2.44	2.2	2.05	.71	.62	.79	.30	—	170	
TI-1112	.0001	.05	.01	0-5-0	$\pm .0002$	1.5(150) or less	1.57	2.44	2.2	2.05	.71	.62	.79	.30	.30	170	Flat Back
TI-1205	.0001	.20	.01	0-5-10	$\pm .0004$	1.5(150) or less	1.57	2.44	2.2	2.07	.59	.8	.79	.30	—	170	
TI-35	.001	.20	.10	0-50-100	$\pm .0006$	1.3(130) or less	1.08	1.63	1.54	1.43	.39	.57	.76	.20	—	70	

### Digital Indicator



**PC-442J**  
Resolution .0005"/0.01mm  
Measuring Range .5"/12.7mm



**PC-467J**  
Resolution .00005"/0.001mm  
Measuring Range .5"/12.7mm

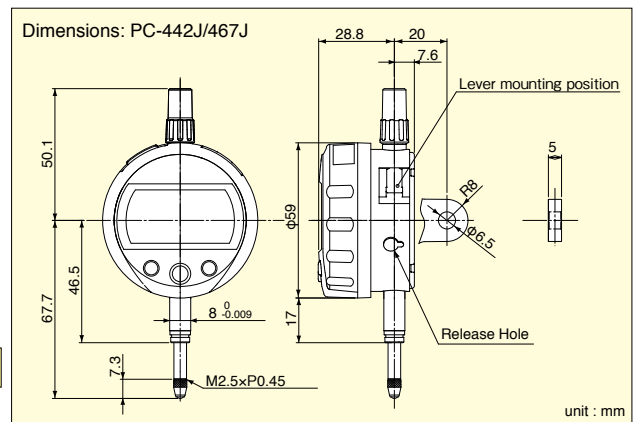

Supplied with Lug back as standard models.  
Flat back and Lift lever are optional.

#### Specifications

Model	Designations (inch/mm)	Resolution (inch/mm)	Measuring Range (inch/mm)	Accuracy* (inch)	Stem Diameter (mm)	Contact Point	Point Screw	Measuring Force N(gf)	Weight (g)
PC-442	.5-.0005/12.7-0.01	.0005/0.01	.5/12.7	.0008	$\phi 8$	Carbide	M2.5 x 0.45	1.2(120) or less	160
PC-467	.5-.00005/12.7-0.001	.00005/0.001	.5/12.7	.00012	$\phi 8$	Carbide	M2.5 x 0.45	1.2(120) or less	160

\* The quantising error is not included.



# Test Indicator

## Auto Clutch Type

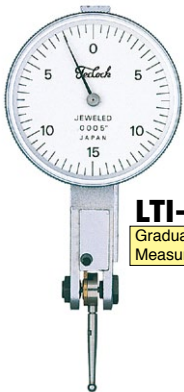

**LTI-352**  
Graduation .0005"  
Measuring Range .03"



**LTI-352B**  
Graduation .0005"  
Measuring Range .03"  
Blackface

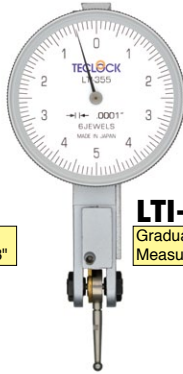

**LTI-355**  
Graduation .0001"  
Measuring Range .01"



**Standard Accessories Set**  
.375" DIA. Stem  
.157" DIA. Stem  
.125" Stylus (Steel ball)  
.039" Stylus (Steel ball)

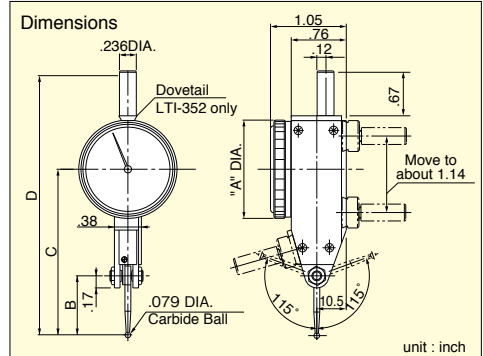

Specification

Model	Graduation (inch)	Total Range (inch)	Dial Reading	Accuracy (inch)	Measuring Force N(gf)	Dimensions (inch)				Weight (g)	Remark
						A	B	C	D		
LTI-352	.0005	.03	0-15-0	.0004	0.2(20) or less	1.38	.787	2.28	3.94	75	Standard
LTI-352B	.0005	.03	0-15-0	.0004	0.2(20) or less	1.38	.787	2.28	3.94	75	Black Face
LTI-353	.0005	.03	0-15-0	.0004	0.2(20) or less	1.38	1.52	3.02	4.68	75	Long Contact Point
LTI-355	.0001	.01	0-5-0	.0002	0.25(25) or less	1.38	.64	2.14	3.86	75	Precision

## Lever Type



**LTI-310**  
Graduation .001"  
Measuring Range .03"

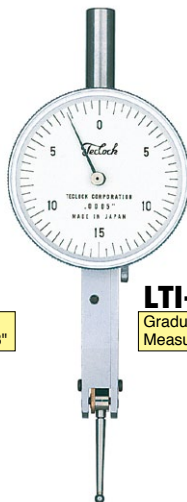

**LTI-315**  
Graduation .0005"  
Measuring Range .03"



**LTI-370**  
Graduation .0001"  
Measuring Range .01"

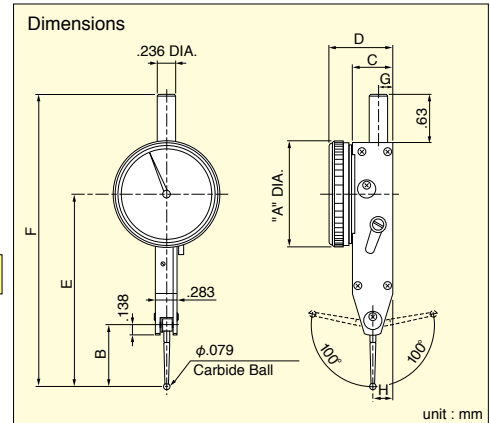

Specification

Model	Graduation (inch)	Total Range (inch)	Dial Reading	Accuracy (inch)	Measuring Force N(gf)	Dimensions (inch)								Weight (g)
						A	B	C	D	E	F	G	H	
LTI-310	.001	.03	0-15-0	.0004	0.4(40) or less	1.12	.56	.54	.85	1.83	3.1	.2	.28	50
LTI-315	.0005	.03	0-15-0	.0004	0.4(40) or less	1.38	.75	.53	.85	2.44	3.74	.19	.27	60
LTI-316	.0005	.04	0-20-0	.0005	0.4(40) or less	1.38	1.72	.53	.85	3.41	4.70	.19	.27	70
LTI-370	.0001	.01	0-5-0	.0002	0.4(40) or less	1.51	.43	.53	.85	2.12	3.41	.19	.27	70

## Parts Stylus

Code No.	Type	Code No.	Type	
ZS-722	LTI-310	ZS-729	.078" DIA.	
ZS-723	LTI-315	ZS-730	LTI-353 .039" DIA.	
ZS-724	LTI-316	ZS-731	.125" DIA.	
ZS-735	LTI-370	ZS-732	.078" DIA.	
ZS-725	LTI-352	ZS-733	LTI-355 .039" DIA.	
ZS-726		.039" DIA.	ZS-734	.125" DIA.
ZS-727		.125" DIA.		

Steel ball

## Universal Holder with Clamp



Code No.	Dimensions (inch)
ZY-062	Dovetail.236 DIA.



# Thickness Gauge

## Dial Thickness Gauges

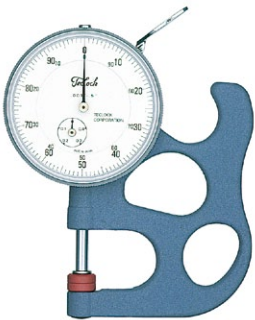

**SI-112**  
 Graduation .001"  
 Measuring Range .5"  
 Contact Point and Anvil (Ceramic)

Specification

Model	Graduation (inch)	Total Range (inch)	Range per Rev. (inch)	Dial Reading	Contact Point Form (inch)	Anvil Form (inch)	Measuring Force N(gf)	Weight (g)
SI-112	.001	.5	.10	±0-50-100	.394 DIA. Flat	.394 DIA. Flat	2.5(250) or less	145
SI-112LS	.001	.5	.10	±0-50-100	S.125(1/8) DIA.	.394 DIA. Flat	2.5(250) or less	145
SI-112LW	.001	.5	.10	±0-50-100	S.125(1/8) DIA.	S.125(1/8) DIA.	2.5(250) or less	145
SI-112-3A	.001	.5	.10	±0-50-100	.197 DIA. Flat	.197 DIA. Flat	2.5(250) or less	145

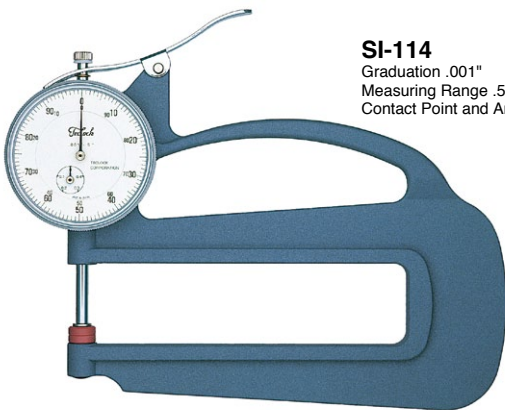
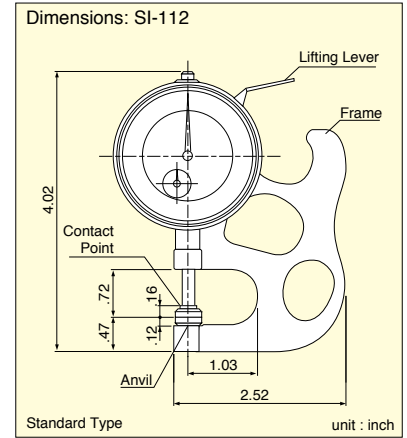

**SI-114**  
 Graduation .001"  
 Measuring Range .5"  
 Contact Point and Anvil (Ceramic)

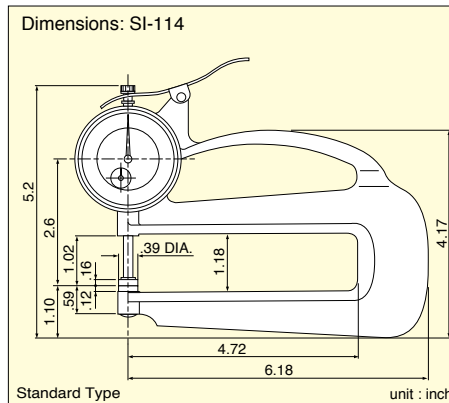

Specification

Model	Graduation (inch)	Total Range (inch)	Range per Rev. (inch)	Dial Reading	Contact Point Form (inch)	Anvil Form (mm)	Measuring Force N(gf)	Weight (g)
SI-114	.001	.5	.10	±0-50-100	.394 DIA. Flat	.394 DIA. Flat	2.5(250) or less	270
SI-114LS	.001	.5	.10	±0-50-100	S.125 (1/8) DIA.	.394 DIA. Flat	2.5(250) or less	270
SI-114LW	.001	.5	.10	±0-50-100	S.125 (1/8) DIA.	S.125 (1/8) DIA.	2.5(250) or less	270
SI-124	.001	1.0	.10	±0-50-100	.394 DIA. Flat	.394 DIA. Flat	3.5(350) or less	270
SI-124LS	.001	1.0	.10	±0-50-100	S.125 (1/8) DIA.	.394 DIA. Flat	3.5(350) or less	270
SI-124LW	.001	1.0	.10	±0-50-100	S.125 (1/8) DIA.	S.125 (1/8) DIA.	3.5(350) or less	270

## Anvil & Contact Point

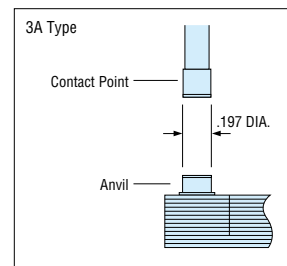
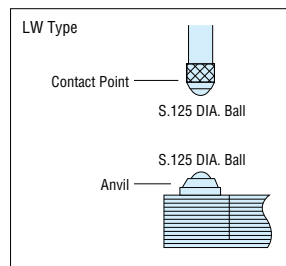
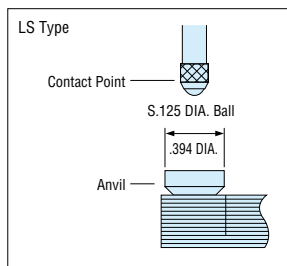
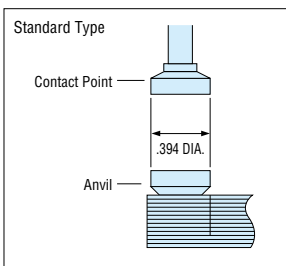

unit : inch

For appearance and other design improvement, the products introduced in this catalog are subject to change without advance notice.

---

**GENERAL CATALOG**

Catalog No.5004

**TECLOCK Corporation**

<http://www.teclock.co.jp>

– HEAD OFFICE –

2-10-3 NARUTA-CHO, OKAYA-SHI, NAGANO-KEN 394-0042

PHONE: 81-266-22-4912, FACSIMILE: 81-266-22-4914

E-mail: [teclock@teclock.co.jp](mailto:teclock@teclock.co.jp)